

CLIENT:
 Terry White





ADDRESS:
 18, Grange Close, Ludham, Great
 Yarmouth, Norfolk NR29 5PZ

DRAWN BY: S.B

DRAWING NO.: Arch - A111

TITLE: 3D Views

DATE: 04-11-23

LEGEND	 EXISTING STRUCTURE
	 STRUCTURE TO BE DEMOLISHED
	 PROPOSED STRUCTURE
	 SHARED WALL

No.	Revision Description	Date

- All material and workmanship must fully comply with all relevant current British Standards and Codes of Practice.
- Drawings not to be scaled for construction.
- Contractor to check all dimensions before ordering any steel work.

SCALE: 1:100 @ A3

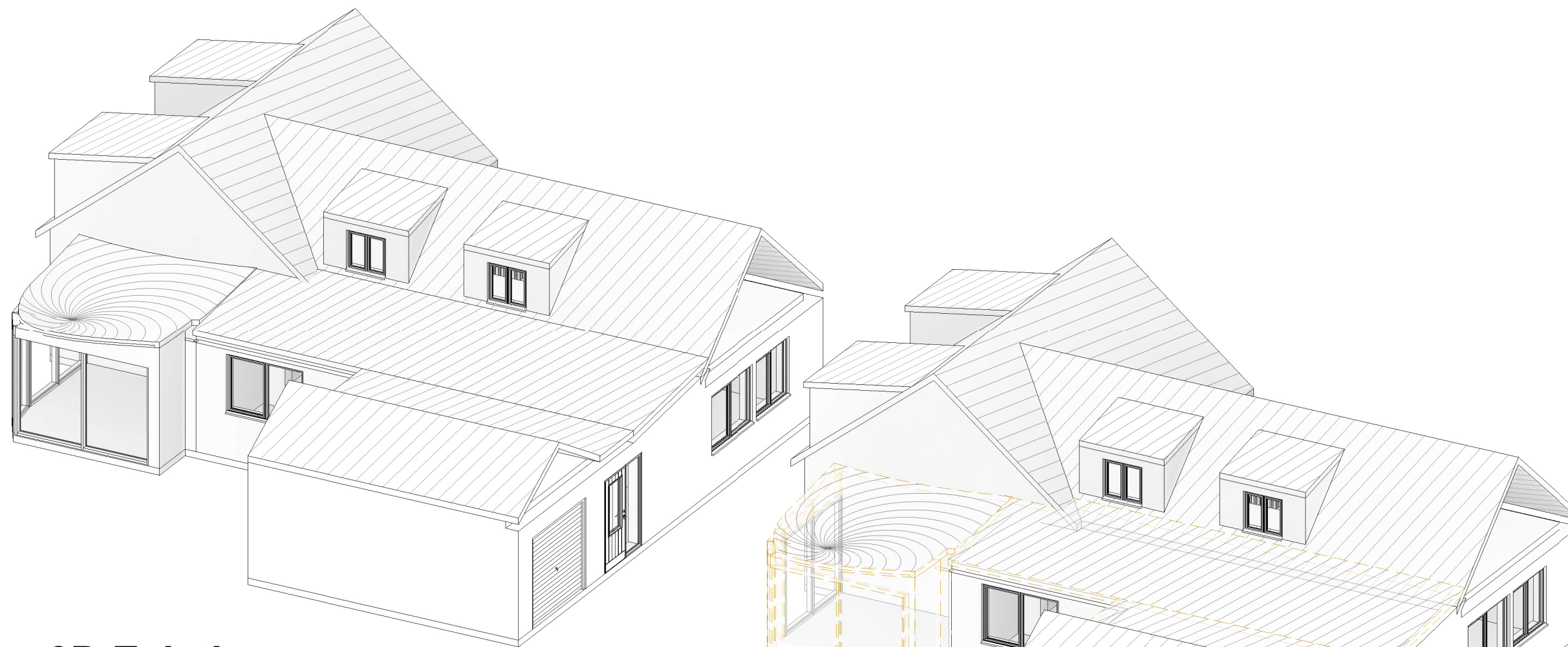

1 3D Existing

3 3D Demo

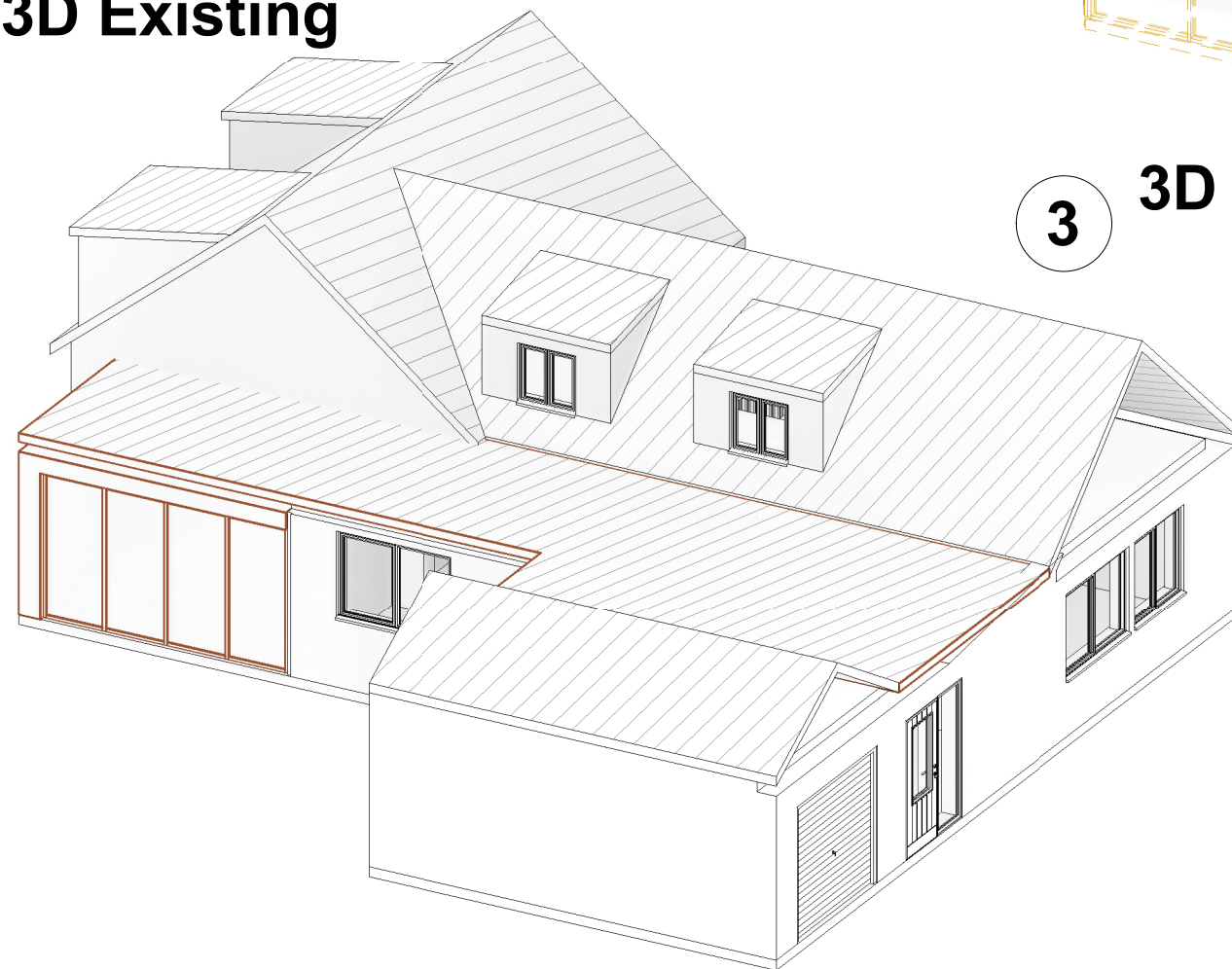

2 3D Proposed