

Shiplap boarding to all sides of shed

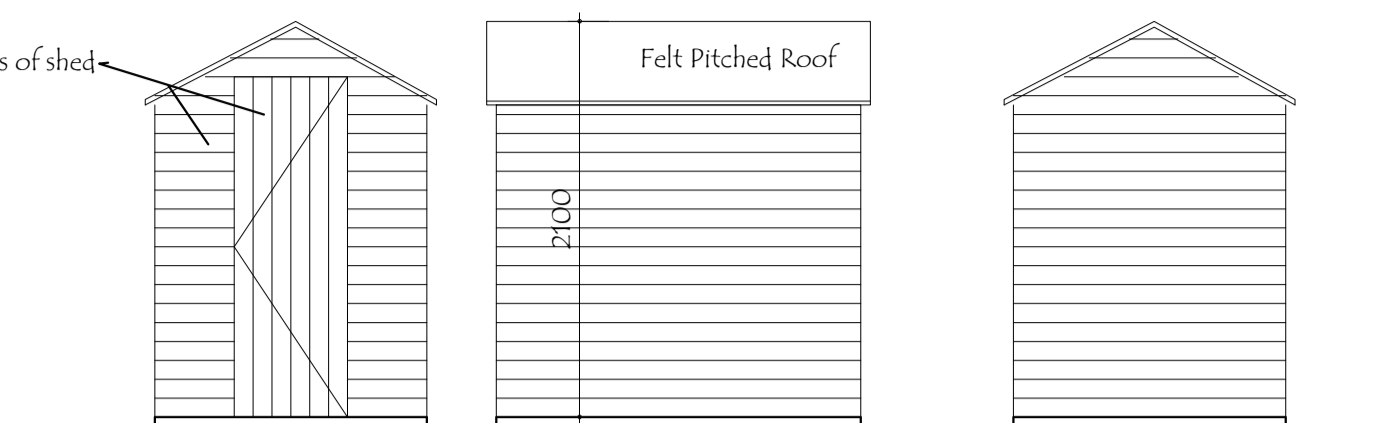

Typical Elevations - 1:50

Ceiling mounted light for each cycle store wired from individual apartments

Shiplap gates to front with key lock for security

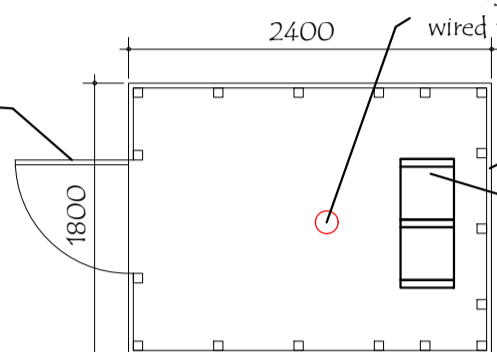

Plan - 1:50

Shiplap boarding to all sides of shed

3no. Stainless steel cycle rack securely bolted to base



Matthew Hollands Associates Ltd.
Yew Tree Farm, 48 Venus Street,
Congresbury, Somerset. BS49 5EZ.

Project: Proposed Dwelling at
24 Worlebury Park Road, Weston Super Mare

Scale: 1:200@A2

Title: Proposed Site Layout & Shed Details

Drawn: MH

Dwg No: 2334 / 02

Date: Oct 2023

t. 07808 249410 e. mha.architecture@btinternet.com

