

Location Plan near GL141DF



This Plan includes the following Licensed Data: OS MasterMap Colour PDF Location Plan by the Ordnance Survey National Geographic Database and incorporating surveyed revision available at the date of production. Reproduction in whole or in part is prohibited without the prior permission of Ordnance Survey. The representation of a road, track or path is no evidence of a right of way. The representation of features, as lines is no evidence of a property boundary. © Crown copyright and database rights, 2021. Ordnance Survey 0100031673

0m 20m 40m 60m 80m 100m

Scale: 1:1250, paper size: A4

Forest of Dean D.C.
Planning
Rec'd U 6 OCT 2021



emapsite[™]
plans

P1551/21/FUL

Existing

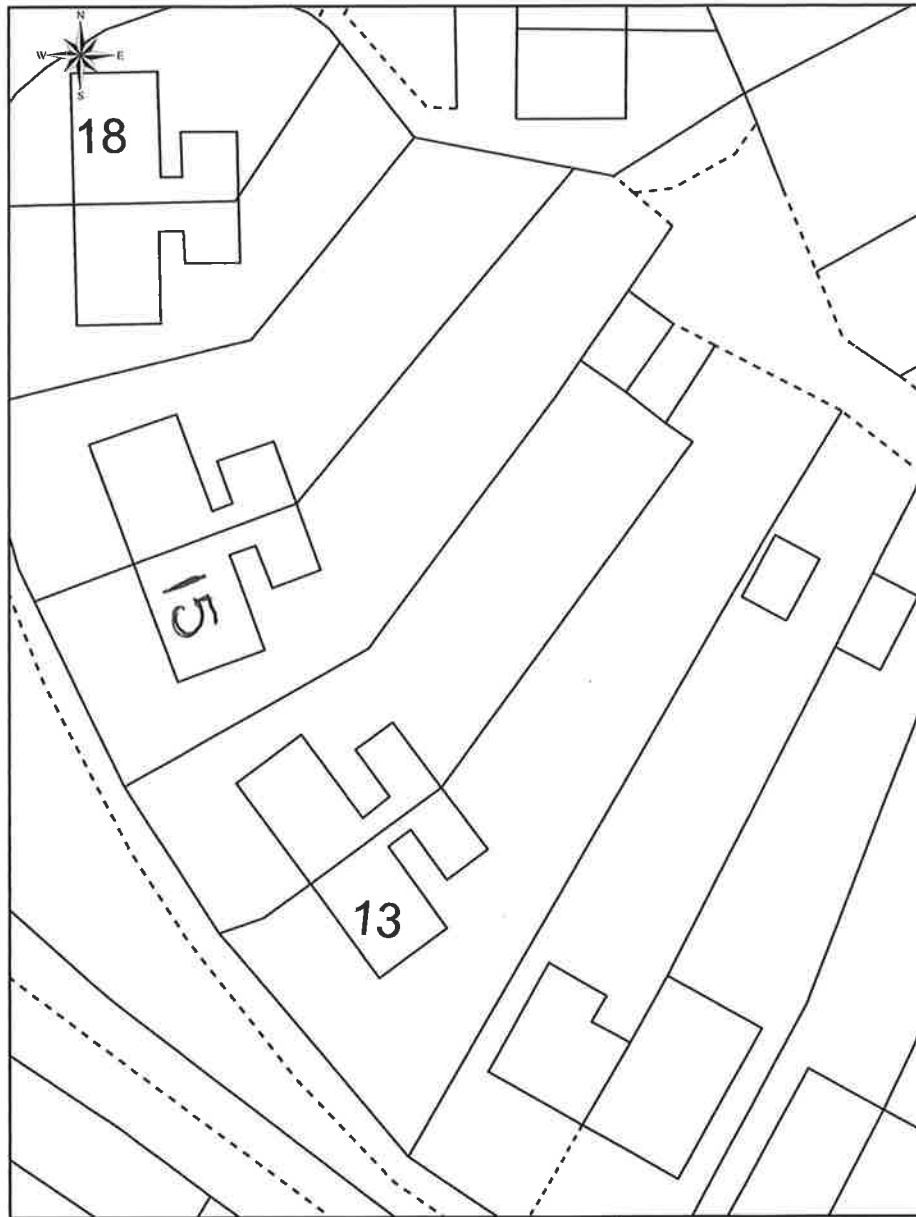

This Plan includes the following Licensed Data: OS MasterMap, Black and White Site Plan/Block Plan by the Ordnance Survey National Geographic Database and incorporating surveyed revision available at the date of

0m 5m 10m 15m 20m

Forest of Dean D.C.
Planning
Rec'd U b OCT 2021

P1551/21/FUL

Proposed.

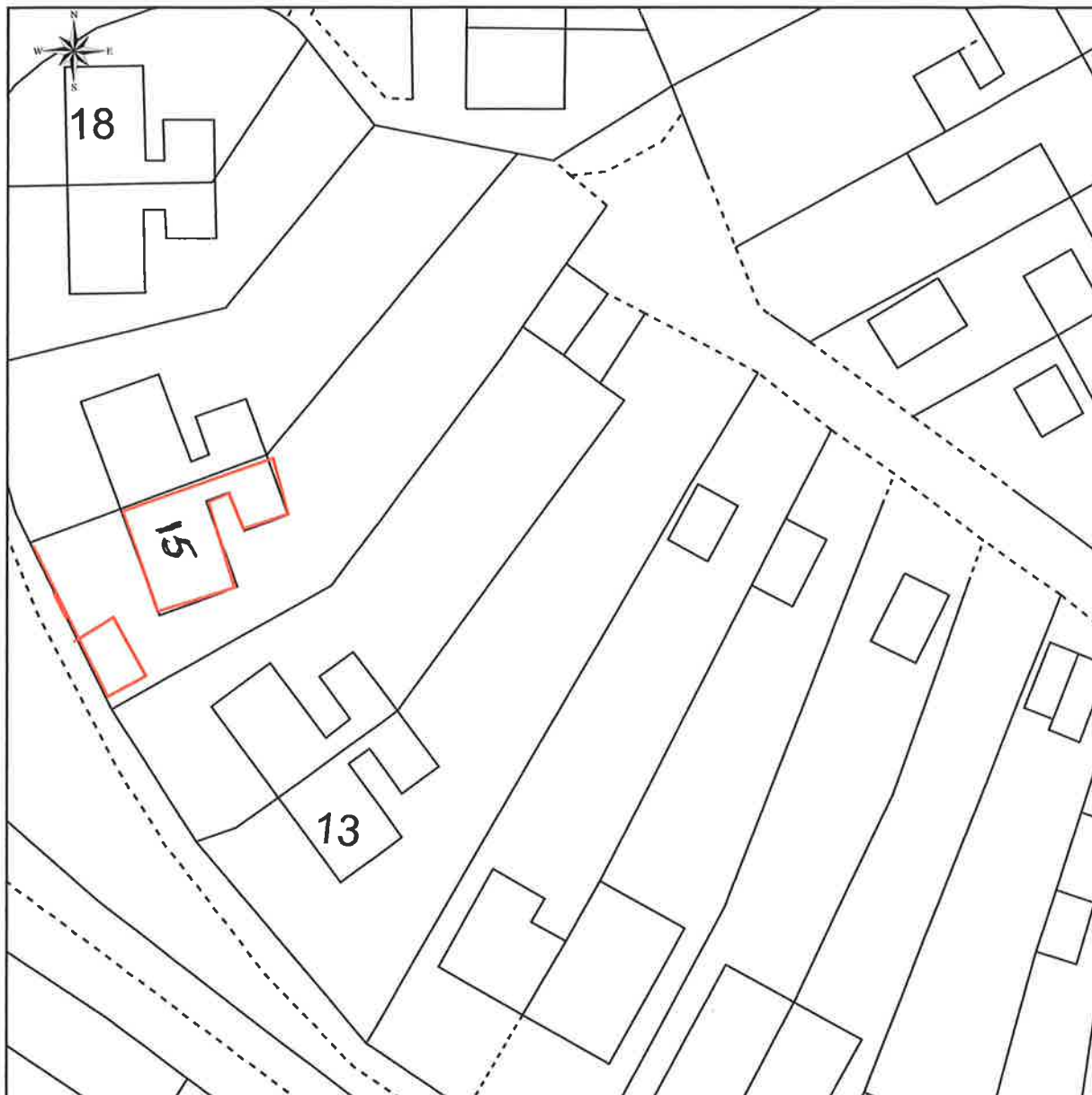

This Plan includes the following Licensed Data: OS MasterMap, Black and White Site Plan/Block Plan by the Ordnance Survey National Geographic Database and incorporating surveyed revision available at the date of production. Reproduction in whole or in part is prohibited without the prior permission of Ordnance Survey. The representation of a road, track or path is no evidence of a right of way. The representation of features, as lines is no evidence of a property boundary. © Crown copyright and database rights, 2021. Ordnance Survey 0100031673

0m 5m 10m 15m 20m 25m 30m 35m 40m

Scale: 1:500, paper size: A4

P1551/21/FUL

Forest of Dean D.C.
Planning

Rec'd U6 OCT 2021



emapsite™
plans

4.9mtr

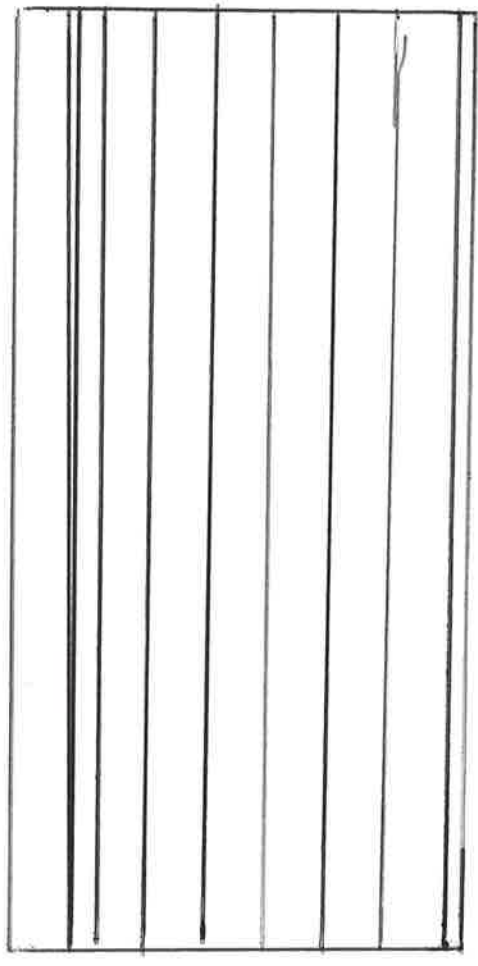
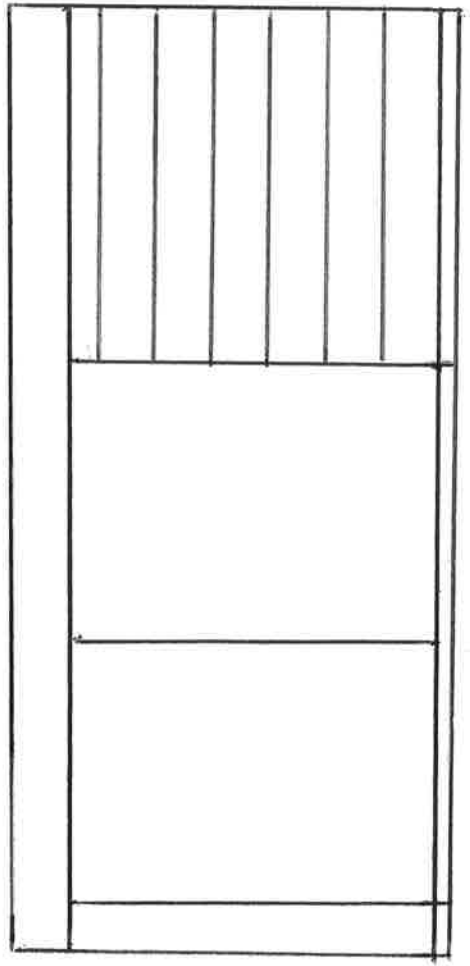

4.2mtr

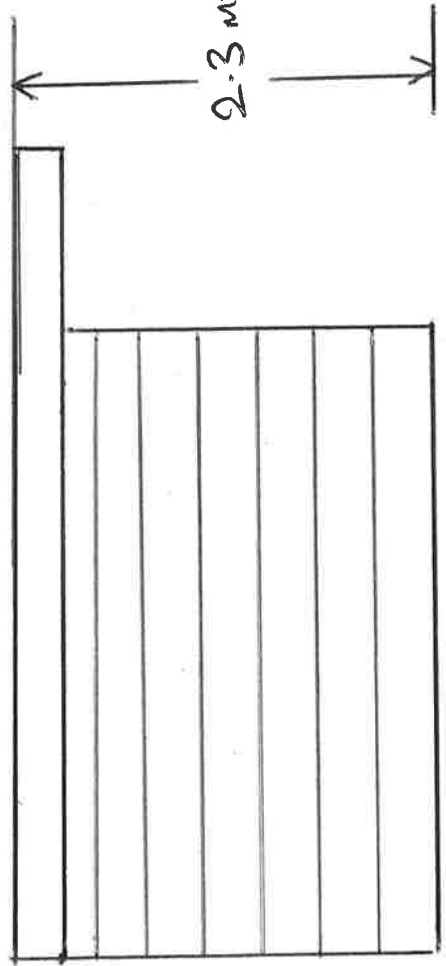

2.3mtr

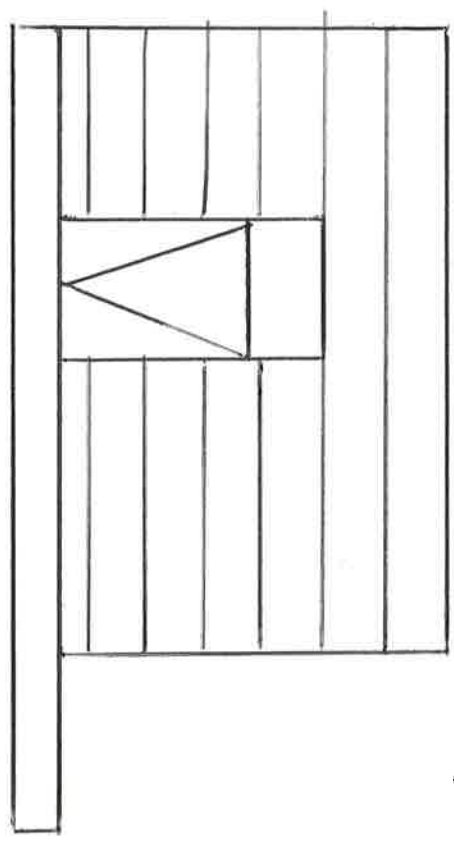

PVC PATIO DOOR + WINDOWS.
TIMBER CONSTRUCTION
RUBBER FLAT ROOF.
TIMBER CLADDING.

Forest of Dean D.C.
Planning
Rec'd U 6 OCT 2021

3.3mtr

P1551/21/FUL

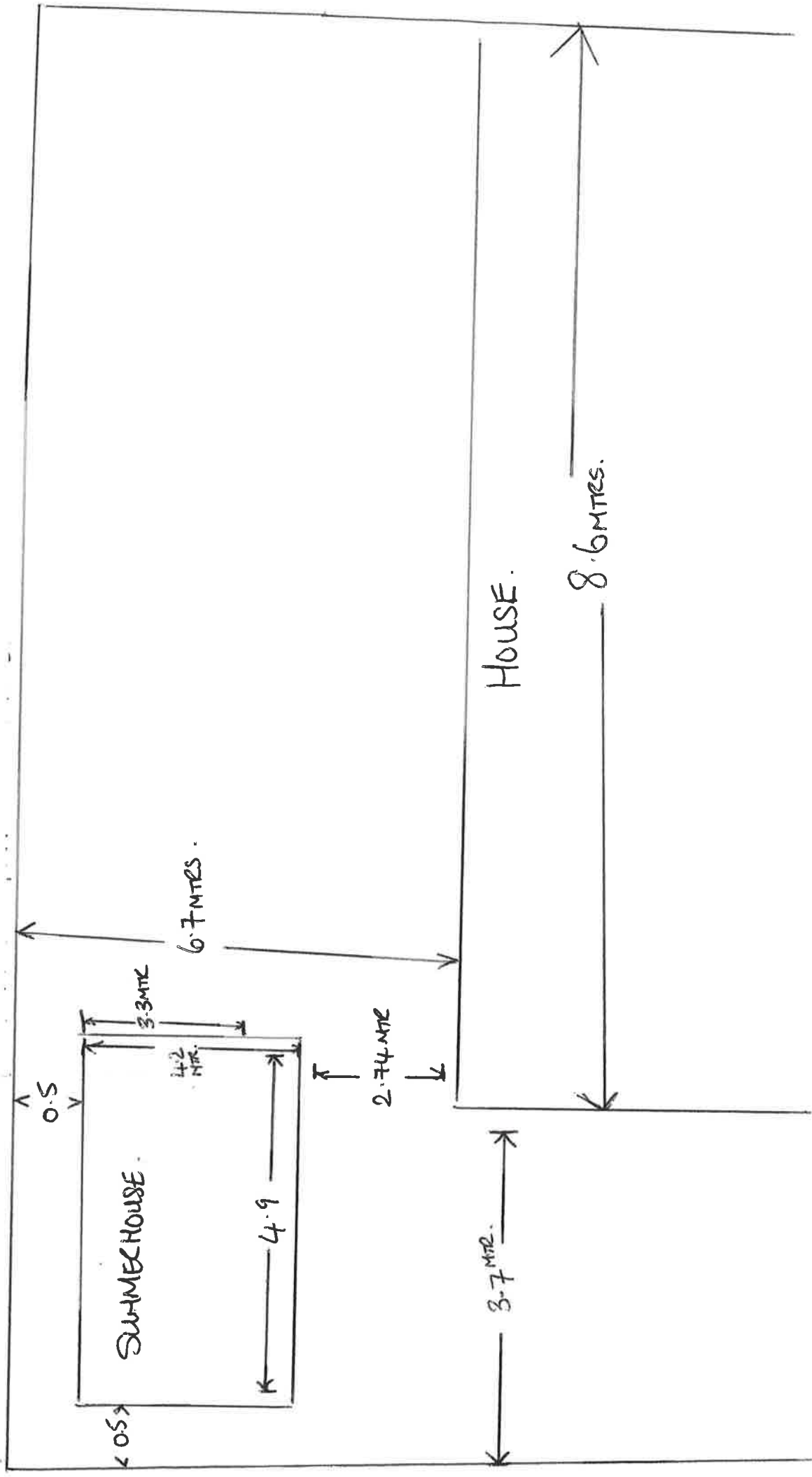

Forest of Dean D.C.
 Planning
 Rec'd 06 OCT 2021

P1551/21/Ful