

Trees at Hillier House, Farnham Road, Guildford

TPO No.	Tree No.	Species	Ht (m)	Branch Spread (m)				Stem diameters (cm)					More than 5 stems	Height of crown clearance (m)	Height of first branch (m) (to nearest 0.1m)	Age class	Category grading	Estimated remaining contribution (yrs)	Condition Physiological / Structural	Preliminary management recommendations	Root protection radius (m)	Root protection area (sqm)	
				N	E	S	W	Single stem	2-5 stems														
									Stem 1	Stem 2	Stem 3	Stem 4											Stem 5
	1	Horse chestnut	8	3	3	3	3	20a						2	2W	S	C1	>10	Small tree growing in adjoining property.		2.40	18	
	2	Horse chestnut	7	2	2	2	2	15e						2	2E	S	C1	>10	Small tree growing in adjoining property.		1.80	10	
P1/201/374	3	Group of beech	7av	3av				15av						2	2S	S	C2	>10	Group of small beech trees growing outside of site.		1.80	10	
P1/201/374	4	Group of beech	19av	6av				65av						7	7W	E	B2	>20	Tightly spaced group of trees growing outside site. All trees have been pruned on the western side to provide clearance for the current building. Understorey of beech saplings and yew.		7.80	191	
	5	Field maple	8	2	2	2	2						10av	7	1	1N	S	C1	>10	Multi-stemmed tree growing in adjoining property.		3.17	32
P1/201/374	6	Beech	19	8	9	9	9	85e						6	6N	M	A1	>40	Visually significant tree growing in adjoining property. Some small cavities associated with past branch loss.		10.20	327	
	7	Lawson cypress	4	1	1	1	1	15e						0	-	S	C1	>10	Small tree growing against corner of building.		1.80	10	
P1/201/45	8	Beech	17	9	7	10	9	131						3	3N	M	A1	>40	Visually significant tree growing within central courtyard. Has recently been crown reduced to control its dimensions.		15.00	707	
	9	Group of yucca	10av	3av				25av						0	-	S	C2	>10	Group of trees growing beyond path at western edge of site.		3.00	28	
	10	Holly	4	1.5	1.5	1.5	1.5	27						2	2E	S	C1	>10	Small tree growing along eastern boundary of site.		3.24	33	

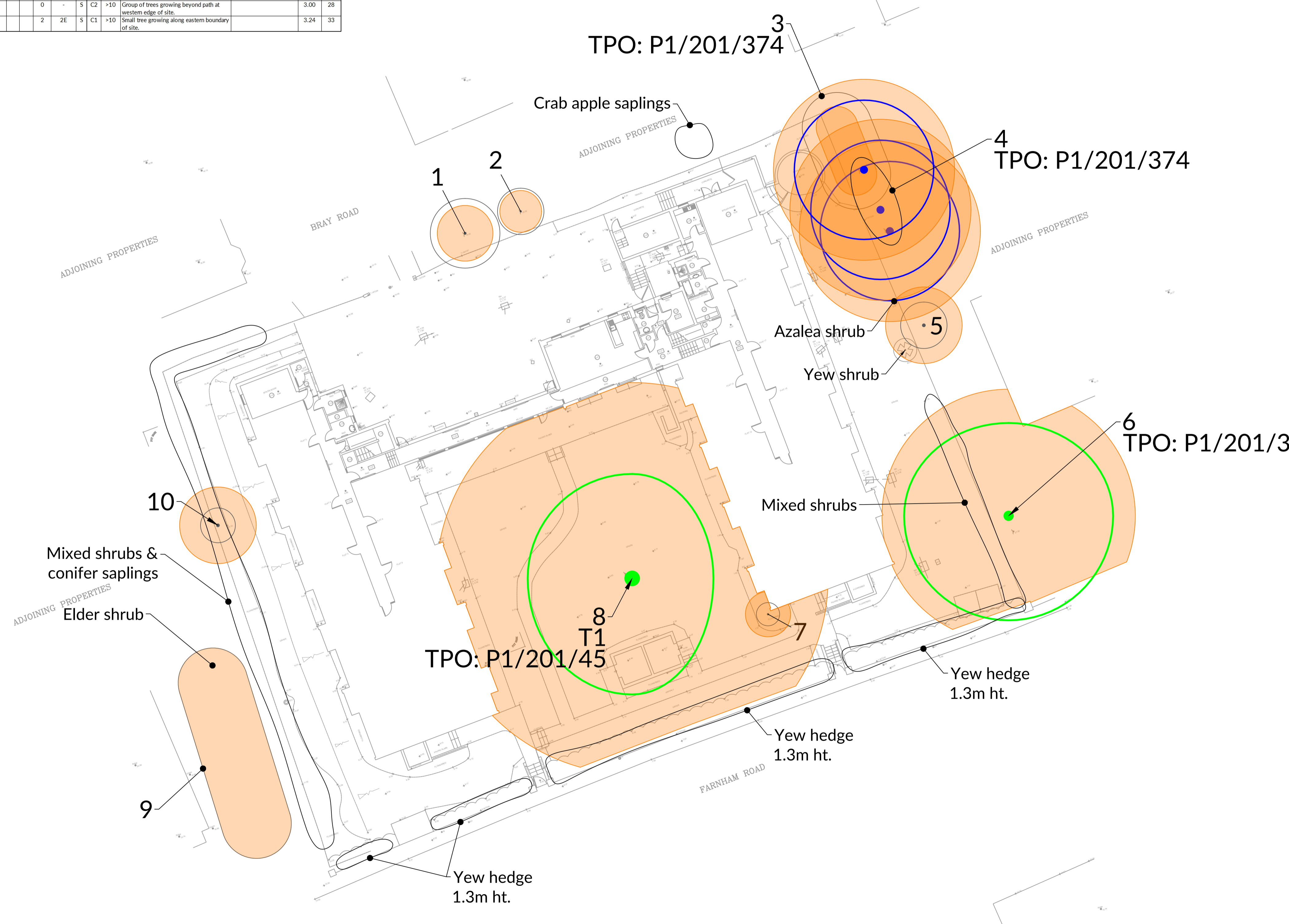

- NOTES**
- This survey information has been prepared for planning purposes only. Additional detail will be needed for foundation design.
 - The original of this drawing was produced in colour - a monochrome copy should not be relied upon.
 - Scale for planning purposes only.
 - All dimensions to be checked on site.
 - The copyright of this document resides with Keen Consultants unless assigned in writing by the company.
 - Details shown on this drawing are devised with reference to BS5837:2012: Trees in relation to design, demolition and construction Recommendations.
 - Tree Preservation Order based on Guildford Borough Council interactive map.
 - EXISTING TOPOGRAPHICAL SURVEY based on HB Surveys Ltd drawing number 23035-02-T-E.
 - Where trees were not identified on the topographical survey they have been plotted by eye.

- KEY**
- Trees to be considered for retention: (Coloured line indicates extent of canopy)
 - Tree Category A 1,2 or 3 - Trees of high quality
 - Tree Category B 1,2 or 3 - Trees of moderate quality
 - Tree Category C 1,2 or 3 - Trees of low quality
 - Trees unsuitable for retention: (Coloured line indicates extent of canopy)
 - Tree Category U - Trees that cannot realistically be retained due to their condition
 - Protection Areas:
 - Root Protection Area (RPA) (where RPAs overlap the shading will appear darker)
 - Tree/Hedge numbering:
 - 1 - Tree number - refer to schedule for information

KEY TO TREE SCHEDULE

Column Heading	Explanation
TPO No.	If applicable and where known
Tree No.	Unique number corresponding with number on plan
Species	English names
Ht (m)	Height in metres
Branch Spread	Crown radius in metres to cardinal points of the compass
Stem Dia	All measurements conform to Annex C of BS 5837:2012
	Single stem - Stem diameter in centimetres measured at 1.5m above ground level.
	Multi-stemmed tree with 2 to 5 stems - Diameter of each stem
	Multi-stemmed tree with more than 5 stems - Average stem diameter and number of stems
Height of crown clearance	Height in metres between the ground and underside of canopy
Height of first major branch and direction of growth	Height from ground level to base of first major branch and the approximate direction of growth
Abbreviations as suffix to a dimension	Suffix 'v' denotes an estimated dimension
Age Class	Suffix 'av' denotes an average dimension
	Age Class definitions:
	Y = Young S = Semi-mature E = Early mature
	M = Mature O = Over mature
Category grading and Estimated remaining Contribution (yrs)	Summary of BS 5837: 2012 categorisation:
	1. Trees unsuitable for retention:
	U = those in such a condition that they cannot realistically be retained as living trees in the context of the current land use for longer than 10 years.
	2. Trees to be considered for retention:
	A1, 2 or 3 = trees of high quality (substantial contribution >40 yrs)
	B1, 2 or 3 = trees of moderate quality (significant contribution >20 yrs)
	C1, 2 or 3 = trees of low quality (but adequate, ie >10 yrs or young trees - until new planting can be established)
Estimated remaining contribution	Note: Useful estimated remaining contribution of the tree or tree group based on figures stated in BS5837:2012
Condition	Brief description including physiological and structural defects
Preliminary management recommendations	Describes current arboricultural requirement for the tree in its current context
Root Protection Radius	Radius of minimum root protection area in metres calculated from section 4.6 and Annex D of BS5837:2012
Root Protection Area	Total area of minimum root protection area extrapolated from root protection radius

A	Topographical survey added	11.04.23
0	Preliminary issue	10.03.23

Rev	Description	Date
-----	-------------	------

KEEN CONSULTANTS
 Keen Consultants is a trading name of Keen (Europe) Limited. Registered No: 12641584
 Registered office: 4 Sudley Road, Bognor Regis, West Sussex, PO21 1EU

The Studio, Timbers,
 Gables Road, Church Crookham
 Fleet, Hampshire
 GU52 6QY
 T 01252 850096
 mail@keenconsultants.co.uk
 keenconsultants.co.uk

Client
 MRS VAL RICHARDS

Project
 HILLIER HOUSE,
 FARNHAM ROAD, GUILDFORD

Title
 TREE CONSTRAINTS PLAN

Date
 MARCH 2023

Scale
 1:200@A1

Drawn by
 THL

Checked by
 JTK

Drawing Number
 2120-KC-XX-YTREE-TCP01RevA