

CLASS S BEDDING DETAIL
SCALE 1:20

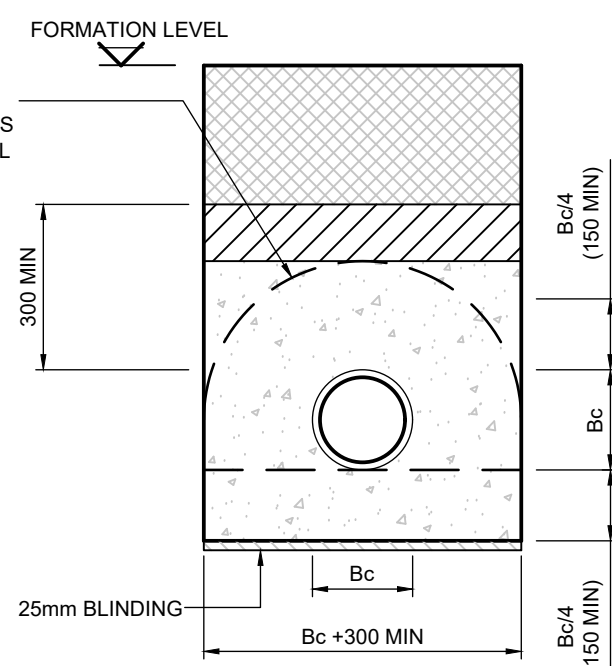

CLASS Z CONCRETE BEDDING DETAIL
(EXTERNALLY AS PER NOTE 15 OF DRAINAGE NOTES)
SCALE 1:20

4/20 COARSE GRADED AGGREGATE GRADING TABLE	
SIEVE SIZE (mm)	PERCENTAGE PASSING (%)
40	100
31.5	98 - 100
20	90 - 99
10	25 - 70
4	0 - 15
2	0 - 5

TABLE 2: 4/20 COARSE GRADED AGGREGATE GRADING TABLE

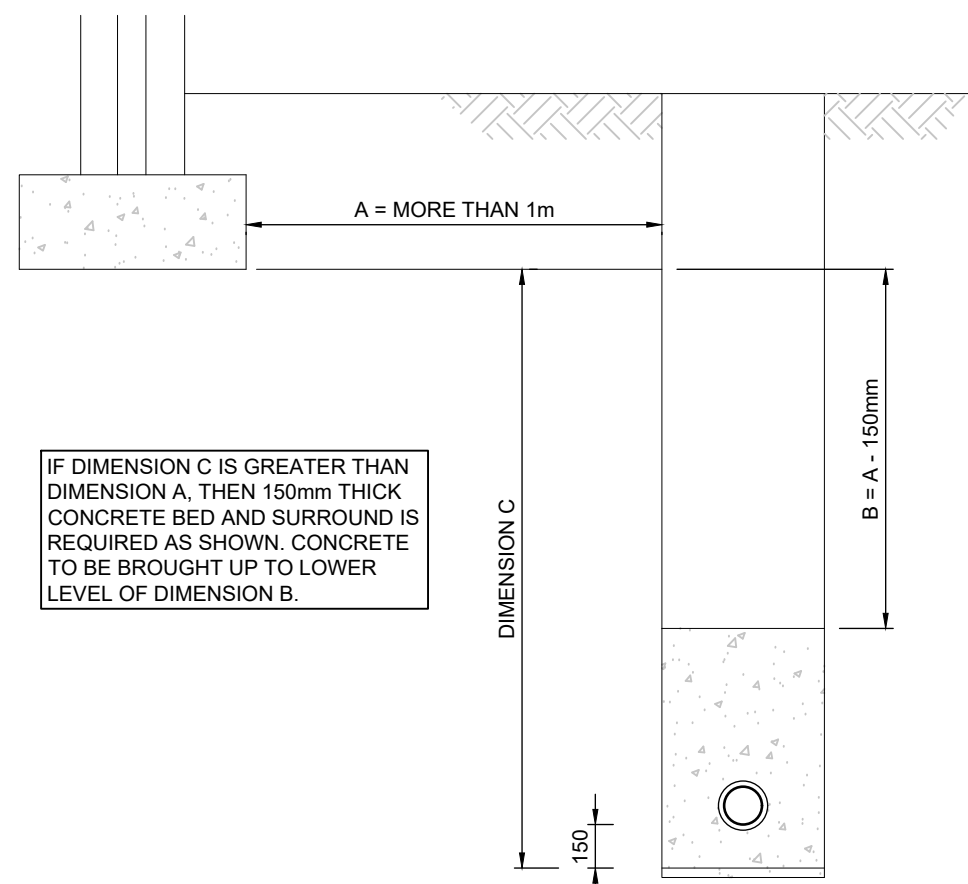

DRAIN TRENCH EDGE MORE THAN 1.0m FROM FOOTING/FOUNDATION EDGE
SCALE 1:20

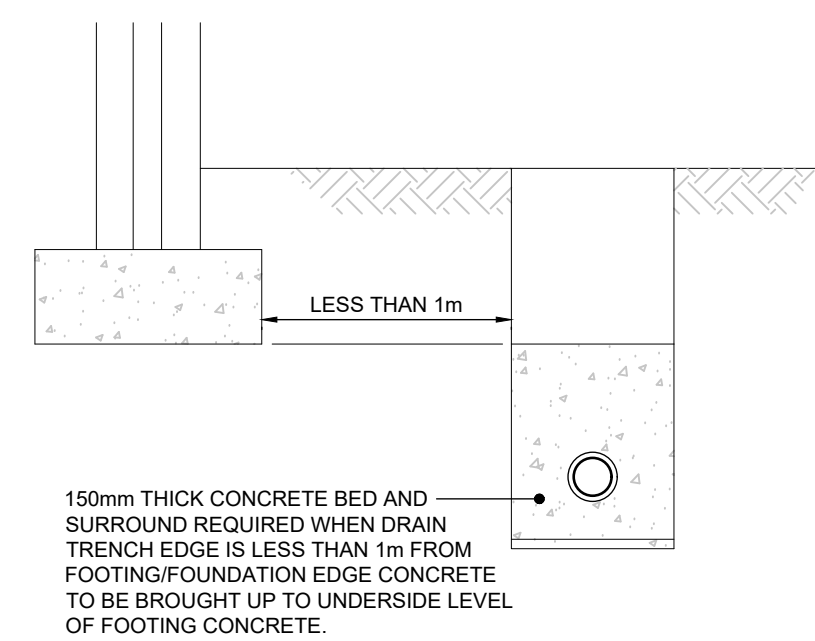

DRAIN TRENCH EDGE LESS THAN 1.0m FROM FOOTING/FOUNDATION EDGE
SCALE 1:20

NOMINAL PIPE DIA (mm)	SINGLE SIZED (mm)	GRADED (mm)
100	10	N/A
OVER 100 TO 150	10 OR 14	14 TO 5
OVER 150 TO 300	10, 14 OR 20	14 TO 5 OR 20 TO 5
OVER 300 TO 525	14 OR 20	14 TO 5 OR 20 TO 5
GREATER THAN 525	14.20 OR 40	14 TO 5, 20 TO 5 OR 40 TO 5

GRANULAR BEDDING MATERIAL TABLE
(ALL AGGREGATES TO BS EN 13242, PD 6882-6:2003 & BS EN 13055-2)

NOTES

- A) Bc = OUTSIDE DIAMETER OF PIPE BARREL.
 B) Y = FOR UNIFORM SOILS:
 SLEEVE JOINTED PIPES, MIN. 50mm OR 1/6Bc, WHICHEVER IS THE GREATER. SOCKETED PIPE, MIN. 100mm OR 1/6Bc, WHICHEVER IS THE GREATER UNDER BARRELS, NOT LESS THAN 50mm UNDER SOCKETS. FOR ROCK OR MIXED SOILS CONTAINING ROCK BANDS, BOULDERS, STONES OR OTHER IRREGULAR HARD SPOTS: SLEEVE JOINTED PIPES, MIN. 150mm OR 1/4Bc, WHICHEVER IS THE GREATER. SOCKETED PIPE, MIN. 200mm OR 1/4Bc, WHICHEVER IS THE GREATER UNDER BARRELS, NOT LESS THAN 150mm UNDER SOCKETS.
 CONCRETE BED AND SURROUND TO BE DISCONTINUED AT EVERY PIPE JOINT (NOT TO EXCEED 5m) USING COMPRESSIBLE FILLER. COMPRESSIBLE FILLER TO BE 18mm THICK FOR PIPEWORK UP TO 450mm DIAMETER. FOR PIPES OVER 450mm FLEXCELL JOINTS TO BE 36mm THICK

PIPE BEDDING DETAIL KEY

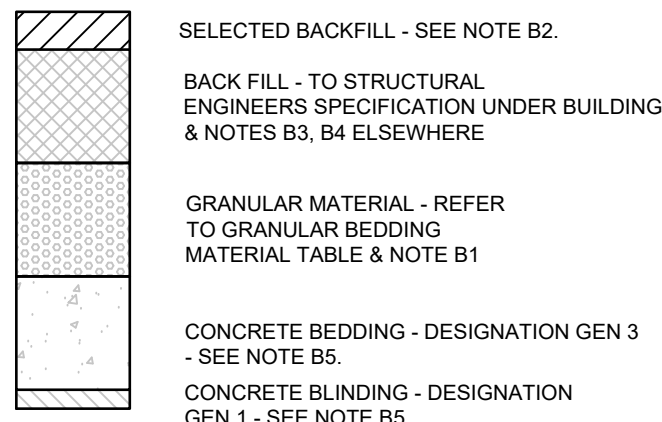

BEDDING NOTES:

- B1. PIPE BEDDING MATERIALS TO COMPLY GENERALLY WITH SHW - SERIES 500 - CLAUSE 503. GRANULAR BEDDING MATERIALS TO ALSO COMPLY WITH BS EN 13242 & THE GRANULAR BEDDING MATERIAL TABLE ON THIS DRAWING.
 B2. SELECTED BACKFILL MATERIAL TO BE PROVIDED ABOVE THE PIPE SURROUND TO A HEIGHT OF 300mm MINIMUM ABOVE THE TOP OF THE PIPE. SELECTED BACKFILL MATERIAL TO BE CLASS 8 - LOWER TRENCH FILL MATERIAL IN ACCORDANCE WITH SHW - SERIES 600 TABLE 6/1 & TO COMPRISE OF UNIFORM SOIL, FREE FROM STONES LARGER THAN 40mm, LUMPS OF CLAY OVER 100mm, TIMBER, FROZEN MATERIAL & VEGETABLE MATTER. SELECTED BACKFILL MATERIAL TO BE PLACED & COMPACTED IN LAYERS NOT EXCEEDING 150mm IN THICKNESS. SHOULD THE MATERIAL BE UNSUITABLE OR WEATHER CONDITIONS AFFECT THE MATERIALS STABILITY, THEN A SUITABLE HARD GRANULAR MATERIAL SHALL BE USED.
 B3. GENERAL BACKFILL TO DRAINAGE TRENCHES (OTHER THAN FILTER DRAINS) IN VEHICULAR TRAFFICKED AREAS ABOVE THE PIPE BEDDING & SELECTED BACKFILL SHALL BE CLASS 1, 2 OR 3 GENERAL FILL MATERIAL IN ACCORDANCE WITH SHW - SERIES 600.
 B4. GENERAL BACKFILL UNDER NON-VEHICULAR TRAFFICKED AREAS TO BE SUITABLE AS-DUG MATERIAL COMPACTED IN ACCORDANCE WITH SHW - SERIES 600 IN LAYERS NOT EXCEEDING 225mm. EACH LAYER COMPACTED TO FORM A STABLE TRENCH BACKFILL. SHOULD THE MATERIAL BE UNSUITABLE OR WEATHER CONDITIONS AFFECT THE MATERIALS STABILITY, THEN A HARD GRANULAR MATERIAL SHALL BE USED UP TO FORMATION LEVEL.
 B5. ALL CONCRETE TO BE DESIGNATED CONCRETE TO CONFORM TO BS 8500-2.

HEALTH & SAFETY RISKS

IN ADDITION TO THE STANDARD HAZARDS AND RISKS NORMALLY ASSOCIATED WITH THE TYPE OF WORK DETAILED ON THIS DRAWING, PLEASE NOTE THE FOLLOWING RESIDUAL HEALTH AND SAFETY RISKS

CONSTRUCTION RISKS

CR01. SERVICES ASSOCIATED WITH PREVIOUS USE
 EXISTING SERVICES PRESENT WITHIN THE CONSTRUCTION SITE: MSE CONSULTANT TO ADVISE ON STATUS (LIVE OR DEAD) OF ABOVE AND BELOW GROUND SERVICES. EXCAVATIONS TO BE COMPLY WITH HSG47 (AVOIDING DANGER FROM UNDERGROUND SERVICES). CONTRACTOR TO OBTAIN PERMIT TO DIG, UNDERTAKE TRIAL HOLES AND CAT SCAN OF WORK SITE PRIOR TO EXCAVATION. HAND DIG WHERE NECESSARY. LIVE SERVICES TO BE DIVERTED AND/OR PROTECTED WHERE THEY ARE TO REMAIN AND BE BUILT INTO THE PROPOSED WORKS. CARE TO BE TAKEN WHILST WORKING AROUND LIVE SERVICES.

CR02. EXCAVATION SUPPORT AND TEMPORARY WORKS

GROUND INVESTIGATIONS UNDERTAKEN IDENTIFY POTENTIALLY UNSTABLE GROUND AND HIGH GROUND WATER LEVELS. DUE TO THE NATURE OF THE GROUND, EXCAVATIONS WILL REQUIRE TEMPORARY SUPPORT AND EDGE PROTECTION. CONTRACTOR TO UTILISE APPROPRIATE TEMPORARY WORKS, DESIGNED BY A TEMPORARY WORKS DESIGNER, AS NECESSARY TO ENSURE THE SAFETY OF ALL OPERATIVES.

CR03. DEEP EXCAVATIONS

NO PERSON TO ENTER ANY UNSUPPORTED EXCAVATION DEEPER THAN 1.20m OR LESS IF GROUND IS UNSTABLE.

CR04. CONTAMINATED GROUND

UNFORESEEN POTENTIAL BURIED HAZARDOUS MATERIALS AND SUBSTANCES INCLUDING ASBESTOS. SIMILAR MATERIALS MAY BE PRESENT IN EXISTING STRUCTURE TO BE DEMOLISHED. CONTRACTOR TO MAKE ALLOWANCE FOR REMOVAL OF SUCH SUBSTANCES.

CR05. CONSTRUCTION ADJACENT TO PUBLIC HIGHWAY

SITE SITUATED NEXT TO PUBLIC HIGHWAY AND FOOTPATH WHICH WILL REMAIN IN USE DURING CONSTRUCTION. CONTRACTOR TO ENSURE EXCAVATION AND SITE ARE MADE SECURE SO ACCESS CAN NOT BE ACHIEVED.

OPERATION & MAINTENANCE RISKS

THERE ARE NO UNUSUAL / ONEROUS RESIDUAL HAZARDS ASSOCIATED WITH THE OPERATION AND MAINTENANCE OF THE WORKS HIGHLIGHTED ON THIS DRAWINGS WHICH A COMPETENT USER / MAINTAINER WOULD NOT ORDINARILY BE REASONABLY AWARE OF.

DEMOLITION RISKS

THERE ARE NO UNUSUAL / ONEROUS RESIDUAL HAZARDS ASSOCIATED WITH THE DEMOLITION OF THE WORKS HIGHLIGHTED ON THIS DRAWINGS WHICH A COMPETENT DEMOLITION CONTRACTOR WOULD NOT ORDINARILY BE REASONABLY AWARE OF.

IT IS ASSUMED THAT ALL WORKS WILL BE CARRIED OUT BY A COMPETENT CONTRACTOR WORKING IN ACCORDANCE WITH THE REQUIREMENTS DEFINED IN THE CDM REGULATIONS.

NOTES:

- THESE NOTES ARE INTENDED TO AUGMENT DRAWINGS AND SPECIFICATIONS. WHERE CONFLICT OF REQUIREMENTS EXIST THE ORDER OF PRECEDENCE SHALL BE AS SHOWN IN THE SPECIFICATION, OTHERWISE THE STRICTEST PROVISION SHALL GOVERN.
- THIS DRAWING IS TO BE READ IN CONJUNCTION WITH ALL OTHER RELEVANT ENGINEERS AND ARCHITECTS DRAWINGS.
- ALL DIMENSIONS TO BE CHECKED ON SITE BY THE CONTRACTOR. ANY DISCREPANCIES TO BE NOTIFIED TO THE ENGINEER AND FURTHER INSTRUCTIONS OBTAINED BEFORE WORK IS COMMENCED.
- THE STRUCTURE IS DESIGNED TO BE SELF-SUPPORTING AND STABLE AFTER THE BUILDING IS FULLY COMPLETED. IT IS THE CONTRACTORS SOLE RESPONSIBILITY TO DETERMINE THE ERECTION PROCEDURE AND SEQUENCE AND ENSURE THAT THE BUILDING AND ITS COMPONENTS ARE SAFE DURING ERECTION. THIS INCLUDES THE ADDITION OF WHATEVER TEMPORARY BRACING, GUYS OR TIE-DOWNS WHICH MAY BE NECESSARY. SUCH MATERIAL REMAINING THE PROPERTY OF THE CONTRACTOR ON COMPLETION, AND FOR ENSURING THAT THE WORKS AND ANY ADJACENT PROPERTIES ARE SAFE IN THE TEMPORARY CONDITION.

P1	FIRST ISSUE	16.11.23	AC	BI	--
Rev	Description	Date	By	Chk	App

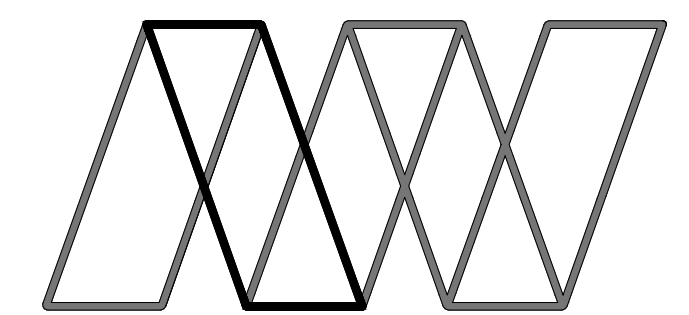

Alan Wood & Partners

York Office Omega 2 Monks Cross Drive York YO32 9GZ T. 01904 611594 www.alanwood.co.uk	Consulting Civil & Structural Engineers Project Managers Building Surveyors Hull Lincoln London Scarborough Sheffield Leeds T. 01482 442138 T. 01522 390310 T. 02071 860761 T. 01723 865484 T. 01142 440077 T. 01135 311098
---	--

Project:	We Jar It Ltd., Wheldrake, York				
Client:	Mercer Foods Ltd.				
Drawing:	Drainage Details (Sheet 1)				
Role:	Civil Engineer				
Drawing Status:	Work In Progress				
Job. no.	49768				
Scale@ A1:	As Noted				
Rev.	P1				
Project Originator	Volume	Level	Type	Role	Number
WJI - AWP - ZZ - XX - D - C - 3700					

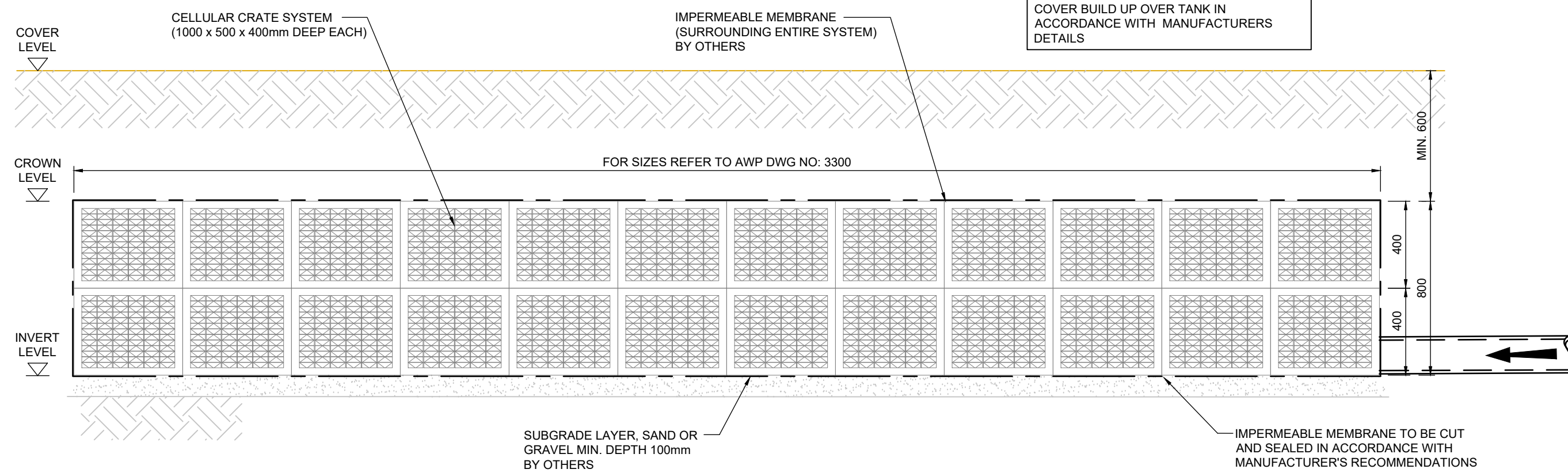

TYPICAL ATTENUATION TANK DETAIL
SCALE 1:20