

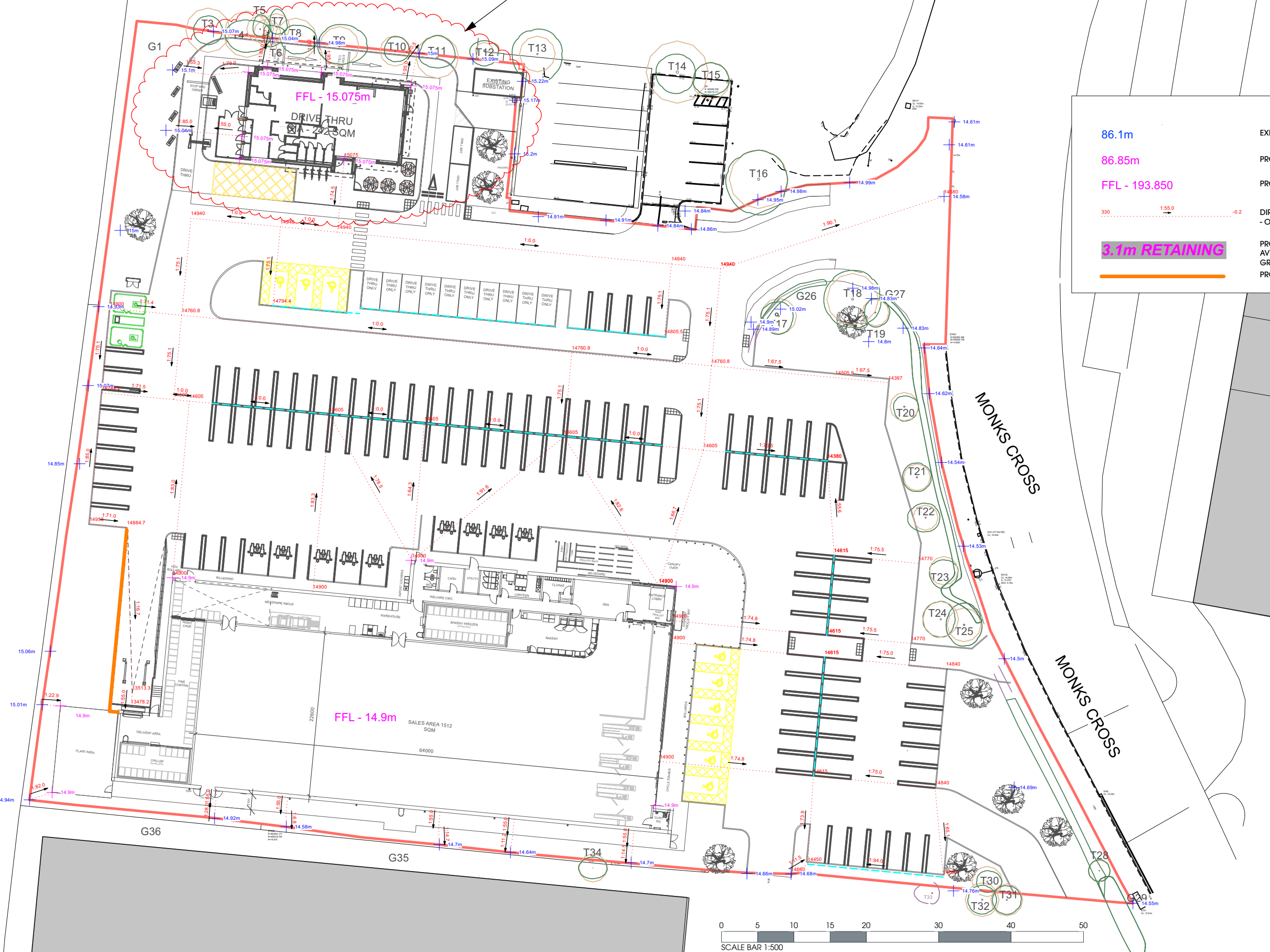

DRIVE THRU LEVELS SUBJECT TO CONSULTATION



86.1m	EXISTING EXTERNAL LEVEL
86.85m	PROPOSED EXTERNAL LEVEL
FFL - 193.850	PROPOSED FLOOR LEVEL
330      1.55.0      -0.2	DIRECTION OF FALL - INCLUDING FALL ANGLE SET AT 1:X - OUTSIDE DIMENSIONS INDICATE THE LEVELS
<b>3.1m RETAINING</b>	PROPOSED RETAINING WALL HEIGHT INDICATOR - AVERAGE HEIGHT IN LOCATION NOTED FROM EXISTING GROUND LEVEL
	PROPOSED RETAINING WALL

Rev	Date	Description	BM	Drawn
A	27/09/2023	Text adjusted		

**htcarchitects**

York Place Studio  
8 Britannia Street  
Leeds  
LS1 2DZ  
T: (0113) 244 3457  
W: www.htcarchitects.co.uk  
E: info@htcarchitects.co.uk

client  
**Lidl GB Ltd.**



project  
**Monks Cross,  
York**

drawing title  
**Proposed Levels Strategy**

date **August 2023**  
status **Planning**  
scale **1:500 @ A3**  
drawn **NG** checked **BM**  
job no. **2504** dwg no. **P434** rev. **A**

