

THIS DRAWING IS COPYRIGHT AND REMAINS THE PROPERTY OF HTC ARCHITECTS. IT MUST NOT BE REPRODUCED, USED, DISCLOSED OR TRANSMITTED TO THIRD PARTIES IN ANY FORM, IN WHOLE OR IN PART, WITHOUT PRIOR WRITTEN PERMISSION.

DO NOT SCALE!
ALL DIMENSIONS SHOULD BE CHECKED ON SITE BEFORE WORK COMMENCES

SHOWN BOUNDARY AS PER TITLE NR NYK24283
SUBJECT TO RECEIPT OF OFFICIAL TITLE DEEDS

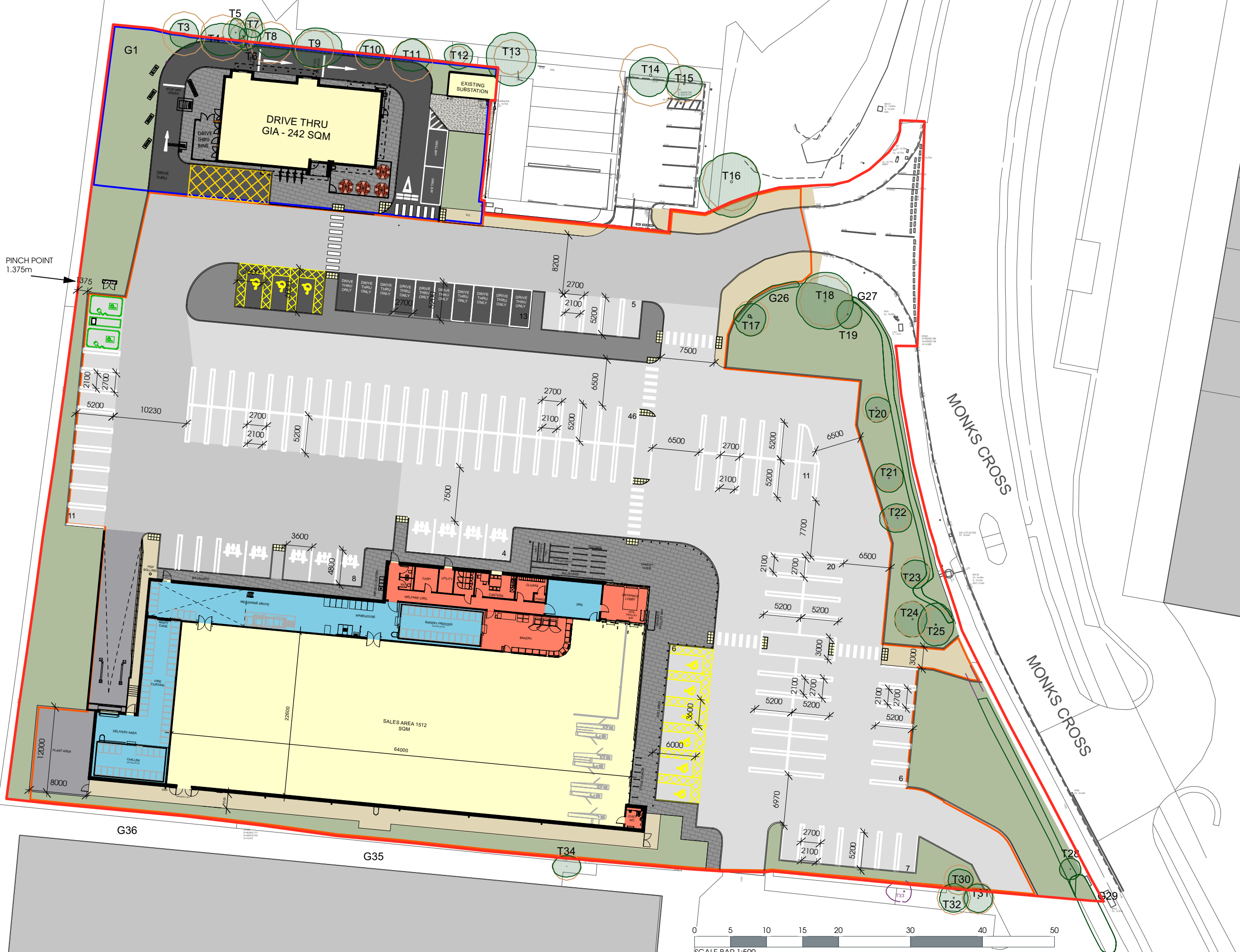

CAR PARK SCHEDULE

TOTAL IN SITE	(137)
LIDL TOTAL	(124)
DISABLED	6
PARENT AND CHILD	9
STANDARD SPACES	107
EVC	2
DRIVE THRU UNIT TOTAL	(13)
DISABLED	3
STANDARD SPACES	10

Site Area

Site Area=	12,621m ² /3.11 acres
------------	-------------------------------------

Developable Areas

Orange Area	9,785m ² /2.42 acres
Blue Area	1,199m ² /0.29 acres

SCHEDULE OF AREAS (TYPE 1500):

SALES	= 1512 m ²
WAREHOUSE	= 447 m ²
ANCILLARY	= 213 m ²
GIA	= 2172 m ²

C	03/11/2023	Proposed Tree planting removed and added annotation	BM
B	10/10/2023	Site entrance amended, car park adjusted following comments from Highways engineer	BM
A	25/09/2023	Adjusted parking layout to include pedestrian links	BM
Rev	Date	Description	Drawn

htcarchitects

York Place Studio
8 Britannia Street
Leeds
LS1 2DZ
T: (0113) 244 3457
W: www.htcarchitects.co.uk
E: info@htcarchitects.co.uk

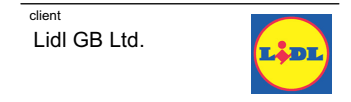

client
Lidl GB Ltd.

project
Monks Cross, York

drawing title
Proposed Site Plan (Type 1500)

date **August 2023**
status **Planning**
scale **1:500 @ A3**
drawn **NG** checked **BM**
job no. **2504** dwg no. **P432** rev. **C**

