

THIS DRAWING IS COPYRIGHT AND REMAINS THE PROPERTY OF HT ARCHITECTS. IT MUST NOT BE REPRODUCED, USED, DISCLOSED OR TRANSMITTED TO THIRD PARTIES IN ANY FORM, IN WHOLE OR IN PART, WITHOUT PRIOR WRITTEN PERMISSION.

DO NOT SCALE!
ALL DIMENSIONS SHOULD BE CHECKED ON SITE BEFORE WORK COMMENCES.

SHOWN BOUNDARY AS PER TITLE INFORMATION
SUBJECT TO RECEIPT OF OFFICIAL TITLE DEEDS



— Site Area = 12,621 SQM
/3.11 ACRES

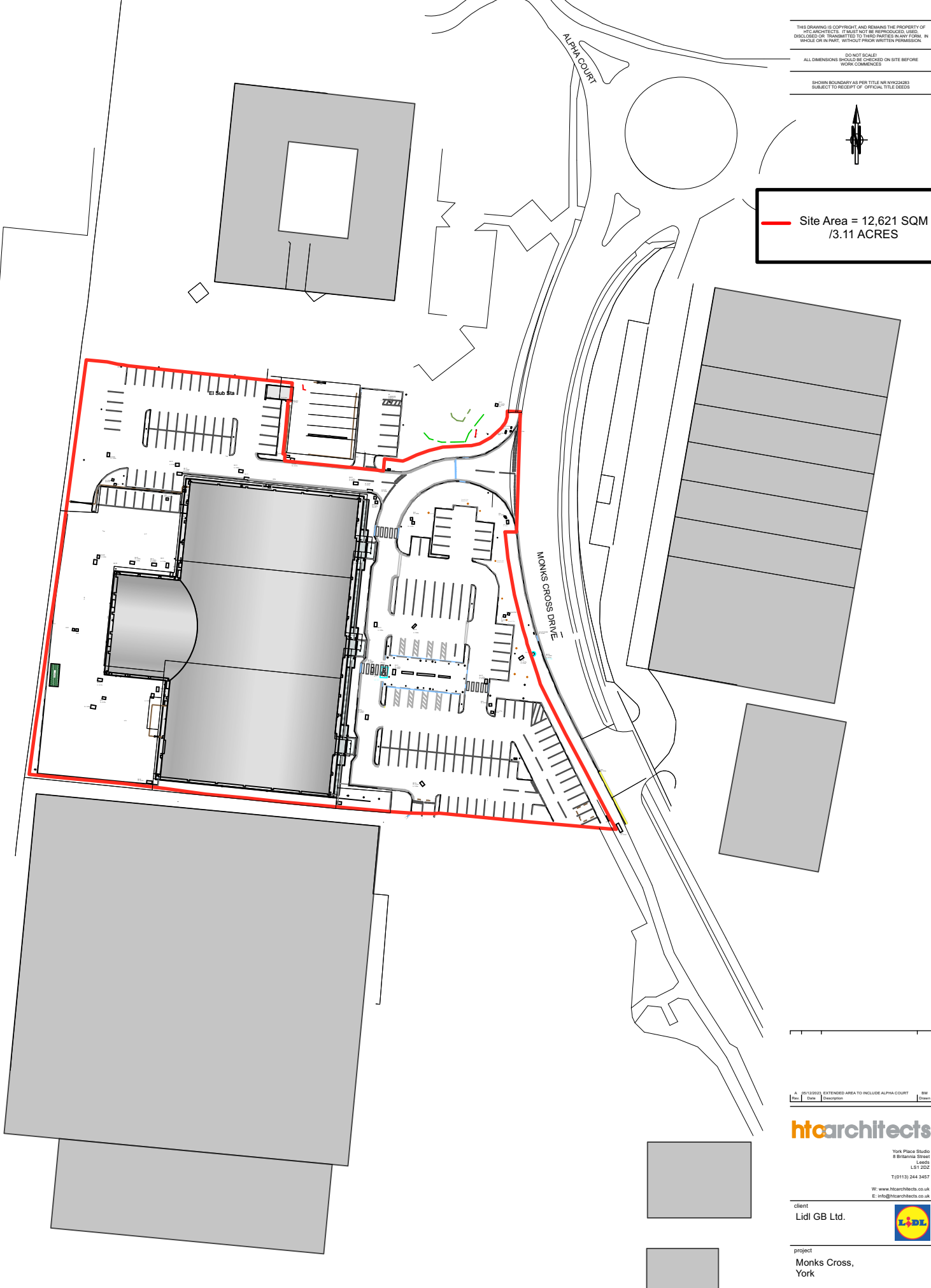

Rev.	Date	Description	By	Drawn
A	20/12/2023	EXTENDED AREA TO INCLUDE ALPHA COURT	BM	

htarchitects
York Place Studio
8 Britannia Street
Leeds
LS1 2DZ
T: (0113) 244 3457
W: www.htarchitects.co.uk
E: info@htarchitects.co.uk

Client
Lidl GB Ltd.



Project
**Monks Cross,
York**

Drawing title
Location Plan

date August 2023
status Planning
scale 1:1250 @ A3
drawn NG checked BM
job no. 2504 dwg no. P430 rev. A