

**PROTECTION OF EXISTING VEGETATION**

Existing vegetation to be retained on site shall be protected where necessary during works by 2300mm high mesh panel fencing secured to a scaffold tubing framework with fluorescent tape to the top rail. Protective fencing shall be erected on the canopy drip line wherever possible. Laminated, waterproof A4 signs shall be placed to the fence posts at 10m intervals bearing the words 'PROTECTED TREES ZONE' and 'NO CUTTING OR OPERATIONS WITHIN FENCED AREA'.  
Tracking of machinery, storage of chemicals and building systems shall not be permitted within the protected area. Loads or spills should be removed immediately and the contaminated soil replaced. No bonfires shall be lit within 10m of the canopy spread. Any excavation work beneath the canopy spread shall be approved by hand.  
All works affecting trees within the development shall be subject to BS 3837:2015.

**KEY**

- Existing trees, hedges and vegetation to be retained
- Existing trees, hedges and vegetation to be removed
- Proposed Extra heavy standard (16-18cm girth) tree
- Proposed ornamental shrub planting
- Proposed native hedgerow
- Proposed instant Beech hedge
- Proposed native scrub
- Proposed mown amenity grass
- Proposed species rich flowering lawn mix
- Existing grass verge retained
- Proposed blue slate chippings
- Block paving (stretcher bond)
- Tarmac (MGV vehicular)
- Tarmac (vehicular)
- Tarmac (pedestrian)
- Concrete (cast in situ)
- Proposed 1800mm high close boarded timber fence (detailed by others)
- Proposed 1800mm steel palisade fence and gate (detailed by others)
- Proposed wildlife habitat boxes - Bird Nest Box (Schwegler 18)
- Proposed hedgehog holes 130x130mm at base of timber panel fencing

**PLANTING SCHEDULES**

**SHRUB SCHEDULE**

ORNAMENTAL PLANTING SCHEDULE				
Nr	Name	Ht in cm	Pot(L)	Density
50	Bergenia cordifolia 'Purpurea'	3L	5.00	
Nr	Name	Ht in cm	Pot(L)	Density
40	Ceanothus thyrsiflorus repens	30-40cm(D)	3L	5.00
48	Choysya ternata 'Sundance'	30-40cm	3L	5.00
64	Cornus sanguinea 'Mid Winter Fire'	40-60cm	3L	5.00
219	Corylus avellana	60-80cm	3L	5.00
42	Euonymus fortunei 'Emerald Gaiety'	30-40cm	3L	5.00
192	Euonymus fortunei 'Emerald Gaiety'	20-30cm(D)	3L	5.00
163	Hebe albicans 'Red Edge'	20-25cm	3L	5.00
134	Hebe pingiufolia 'Page'	20-30cm(D)	3L	5.00
87	Hebe pingiufolia 'Sutherlandii'	20-25cm	3L	5.00
24	Ilex aquifolium	50-60cm	3L	5.00
134	Lavandula angustifolia 'Hidcote'	20-25cm	3L	5.00
34	Pachysandra terminalis	20-30cm(D)	3L	5.00
20	Philadelphus 'Manteau d'Hermine'	30-40cm	3L	5.00
21	Prunus laurocerasus 'Otto Luyker'	30-40cm	3L	5.00
49	Rosa arvensis	60-80cm	3L	5.00
127	Spiraea japonica 'Goldflame'	30-40cm	3L	5.00
149	Viburnum davidii	20-25cm	3L	5.00
49	Viburnum opulus	60-80cm	3L	5.00
23	Vicia minor 'Bowles Variety'	15-20cm(D)	3L	5.00

All shrub material shall be first quality, sturdy, well rooted non-refrigerated stock with well branched heads and fibrous root systems. Shrubs shall be planted into 450mm deep good quality fibrous topsoil, that complies with BS 3882. Incorporate organic compost and slow release fertiliser in the planting mixture in accordance with all good horticultural practices. A proprietary geotextile membrane (such as plantex weed control membrane) is to be installed between the soil and mulch of the planted areas, cut with T or X slits to fit around the plants required. All plant material shall be a minimum of 24 pot size unless otherwise specified and conform to BS3838 Part 1 and BS4428. Finished beds shall be lightly forked over and dressed with 50mm depth blue slate mulch.

**TREE SCHEDULE**

SPECIES	Ht in m	NUMBERS REQUIRED		
		Girth in cm	12-14	14-16
Acer platanoides 'Deborah' (ApD)	-	-	-	2
Carpinus betulus 'Frans Fontaine' (CbFF)	-	-	-	3
Sorbus aucuparia (Sau)	-	-	-	3
Tilia cordata (Tc)	-	-	-	5

All trees to have clear stems to 2.0m above ground level with well developed branching heads with a single, central leader and healthy, fibrous root systems. Trees shall be planted into pits of an appropriate size to accommodate the root system without restriction, backfilled with a 3:1 topsoil/compost mix and shall be secured to a machine rounded stake using 1 no. tree tie with rubber spacer. Finished height of stake shall not exceed 1/3 height of staked tree above ground.

**NATIVE HEDGE**

NATIVE HEDGE SCHEDULE				
Nr	Name	Height/cm	Age	Root
24	Acer campestre	60-80cm	1/1	BR
122	Carpinus betulus	60-80cm	1/1	BR
219	Corylus avellana	60-80cm	1st	BR
24	Ilex aquifolium	50-60cm	-	C 3L
49	Rosa arvensis	60-80cm	1/1	BR
49	Viburnum opulus	60-80cm	-	BR

Hedge to be planted in a previously prepared trench, 500mm wide and 450mm deep backfilled with a 3:1 mix of multipurpose topsoil to BS3882:2007 and planting compost. Bareroot transplants to be dipped in a suitable mycorrhizal dip before planting. Plants to be planted in a double staggered row, 300-350mm wide, at 5m plants per linear metre with species planted randomly throughout in groups of 7 to 30 of a single species. The hedge lines shall be matched after planting with blue slate mulch (nominal size 40mm) to a uniform depth of 50mm.

**NATIVE SPECIES SHRUB SCHEDULE**

NATIVE SHRUB MIX SCHEDULE				
Nr	Name	Height/cm	Age	Root
23	Cornus sanguinea	60-80cm	1/1	B
17	Ilex aquifolium	60-80cm	-	C 3L
17	Prunus spinosa	60-80cm	1/1	B
6	Rosa canina	60-80cm	1/1	B
17	Ilex europaeus	20-40cm	-	C 3L
34	Viburnum opulus	60-80cm	1/1	B

Native species shall be planted into 450mm depth, good quality clean topsoil incorporating organic compost and slow release fertiliser, over un-compacted sub-grade. Prior to planting all bareroot plant stock shall be dipped into a suitable mycorrhizal plant dip in accordance with the manufacturers recommendations. Plants shall be planted in groups of 3-11 of a single species with the taller growing species to the back of the areas of the areas and the lower growing species to the edges of the areas. Planted areas to be matched after planting with coarse grade forest mulch to a uniform depth of 50mm.

**INSTANT BEECH HEDGE**

Species	Age	Size in cm	No Req'd
Fagus sylvatica	Instant	120-150	8

Hedge to be planted as an 'instant hedge'; plants are to be container grown in 1m long troughs, supplied as mature.  
**TURFING**  
The topsoiled area to be turfed, is to be grade and cross-graded to even running falls, to allow the finished levels of the turf to be 40mm above the adjoining paved areas. The surface should be lightly and uniformly firmed by rolling or treading and reduced to a fine silt up to 25mm in depth. All rubbish, stones greater than 50mm in diameter etc, shall be removed from the surface.  
Apply an even application of approved fertiliser at a rate of 70g/m<sup>2</sup> and rake in. No turves shall be laid in exceptionally frosty weather or in other unsuitable weather conditions. The turves shall be laid in a stretcher bond pattern, closely butted and firmed into position, to the correct levels. The turves should be laid off planks, working over turves previously laid. A dressing of fine, sifted topsoil (complying with BS 3882) should be applied to the laid turf and brushed well into the joints.  
Turves shall be watered regularly to prevent them drying out before they establish.

**GRASS SEEDING**

**SPECIES RICH GRASS MIX**  
100mm depth of topsoil complying with BS3882 to be spread to area.  
Soil to be cultivated using a disc harrow or rotovator, to 50mm depth then further cultivated and rolled to produce a firm seed bed.  
Species rich grass seed mix such as Emergo's E11 Flowering Lawn Mix to be sown at the supplier's recommended rates.

**PREPARATION AND PLANTING**

Organic matter to be proprietary shrub planting compost, or approved compost derived from recycled organic material, or similar.  
**TREES AND SHRUBS**  
1 Provide 30 litres of water per tree during prolonged dry periods and as instructed by the Landscape Architect on site.  
2 Keep areas free from weed growth.  
3 Annually apply a slow release fertiliser in Spring.  
4 Replace all failures.  
5 Prune all damaged or broken branches.  
6 Top-up mulch as required.  
7 Check tree ties and stakes.

Rev. B: Updated to include hedgehog holes (SF)  
Rev. A: Updated to revised site layout P432B (SF)  
October 2023  
October 2023

 Westleigh Hall Westfield Road Denby Dale Huddersfield HD8 8JQ Telephone 01484 86511 Fax 01484 86506 16th 0424 86600 email info@fdalandscape.co.uk www.fdalandscape.co.uk	client	Lidl GB Ltd
	project	Proposed Retail Development
		MONKS CROSS YORK NEW SPEC STORE REPLAN
	drawing title	LANDSCAPE DETAILS
	scale	date
1:200/AD	Feb 22	CS
		drawing no
		R/2576/2B

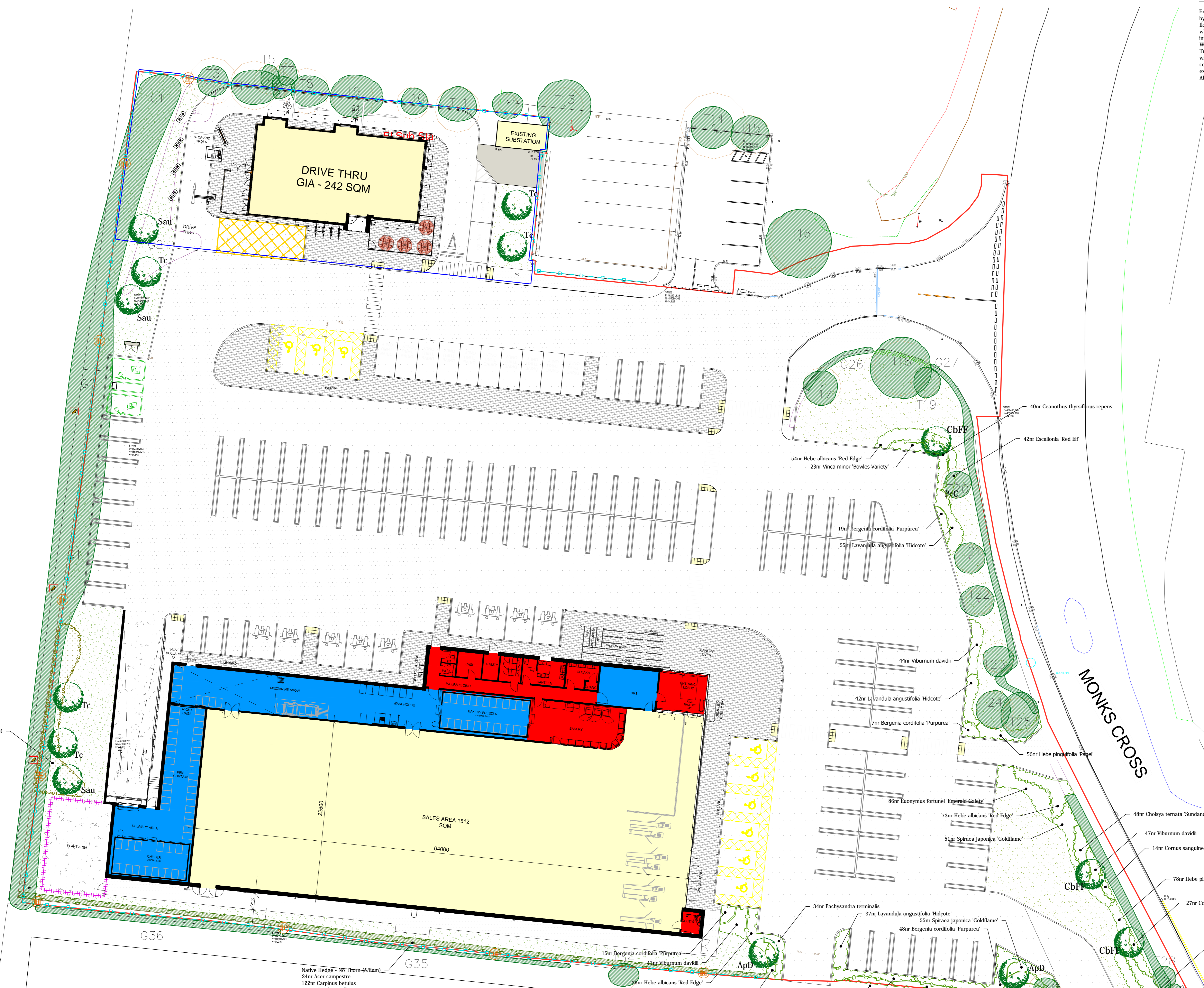

- Native Shrub Mix (0.75 ctrs)
- 23nr Cornus sanguinea
- 17nr Ilex aquifolium
- 17nr Prunus spinosa
- 6nr Rosa canina
- 17nr Ilex europaeus
- 34nr Viburnum opulus

- Native Hedge - No Thorn (4.5m)
- 24nr Acer campestre
- 122nr Carpinus betulus
- 219nr Corylus avellana
- 24nr Ilex aquifolium
- 49nr Rosa arvensis
- 49nr Viburnum opulus