

THE EASTGATE
Inverness, HIGHLAND, IV2 3PP

Ground Level
Internal Area Plan



NOTES

This drawing complies with the 6th edition of the BCS code and is produced to an accuracy commensurate with standard presentation scales. It shall in a scaled digital CAD format.

Black dashed line denotes In Terms of Zone A Boundary calculation.

Coloured dashed line denotes professional estimation made to position structural features(s).

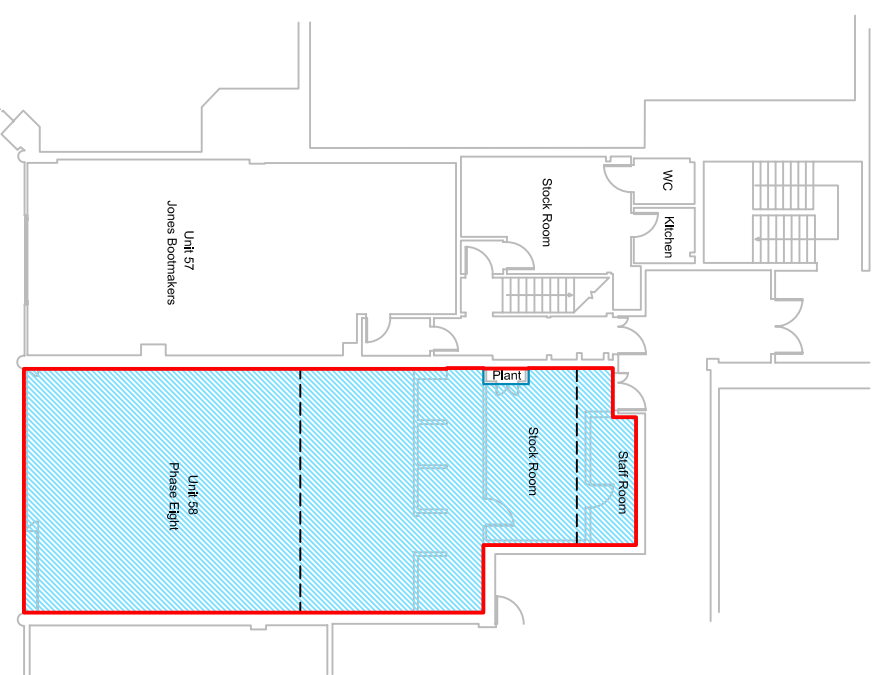

| NIA | | ITZA | |
|--------------------|-------------------|-------------------|-------------------|
| Zone A (A/1) | 73.6 sq m | 792 sq ft | 792 sq ft |
| Zone B (A/2) | 66.1 sq m | 711 sq ft | 356 sq ft |
| Zone C (A/4) | 10.2 sq m | 110 sq ft | 28 sq ft |
| Zone D (A/8) | 0.0 sq m | 0 sq ft | 0 sq ft |
| Remainder (A/1/6) | 0.0 sq m | 0 sq ft | 0 sq ft |
| TOTAL AREA: | 149.9 sq m | 1613 sq ft | 1176 sq ft |

| | | |
|-------------------|-------------------|-------------------|
| TOTAL GIA: | 150.7 sq m | 1622 sq ft |
|-------------------|-------------------|-------------------|



CBRE Limited, St Martins Court, 10 Paternoster Row,
London, EC4M 7HP
Switchboard: 0207 182 2000 Fax: 0207 182 3007
Web: www.cbre.com

| | |
|------------------|----------------------------------|
| Address: | Unit 58 - Trading as Phase Eight |
| | Inverness |
| | Highland |
| | IV2 3PP |
| Drawing: | Unit 58 |
| Date: | March 2012 |
| Scale: | 1:200@A4 |
| Drawn: | ICS |
| Dwg. No.: | 319817-U58-G |
| | Project No. 319817 |
| | Alt. Scale: |
| | Checked: AG |
| | Rev A |