

Copyright, design rights or other intellectual property rights in this drawing remain the property of the author. The plans and information contained within are supplied on the express condition that they are not used in connection with the production of any building components nor the design, erection or construction of any building unless with the permission of the author. The plans may not be copied or used, disclosed nor passed to any third party for any other purpose without the express consent of the author.

Do not scale working dimensions from this drawing, with all dimensions to be checked and verified on site.



Key:

- Existing structure
- Proposed Structure
- Walls to be demolished

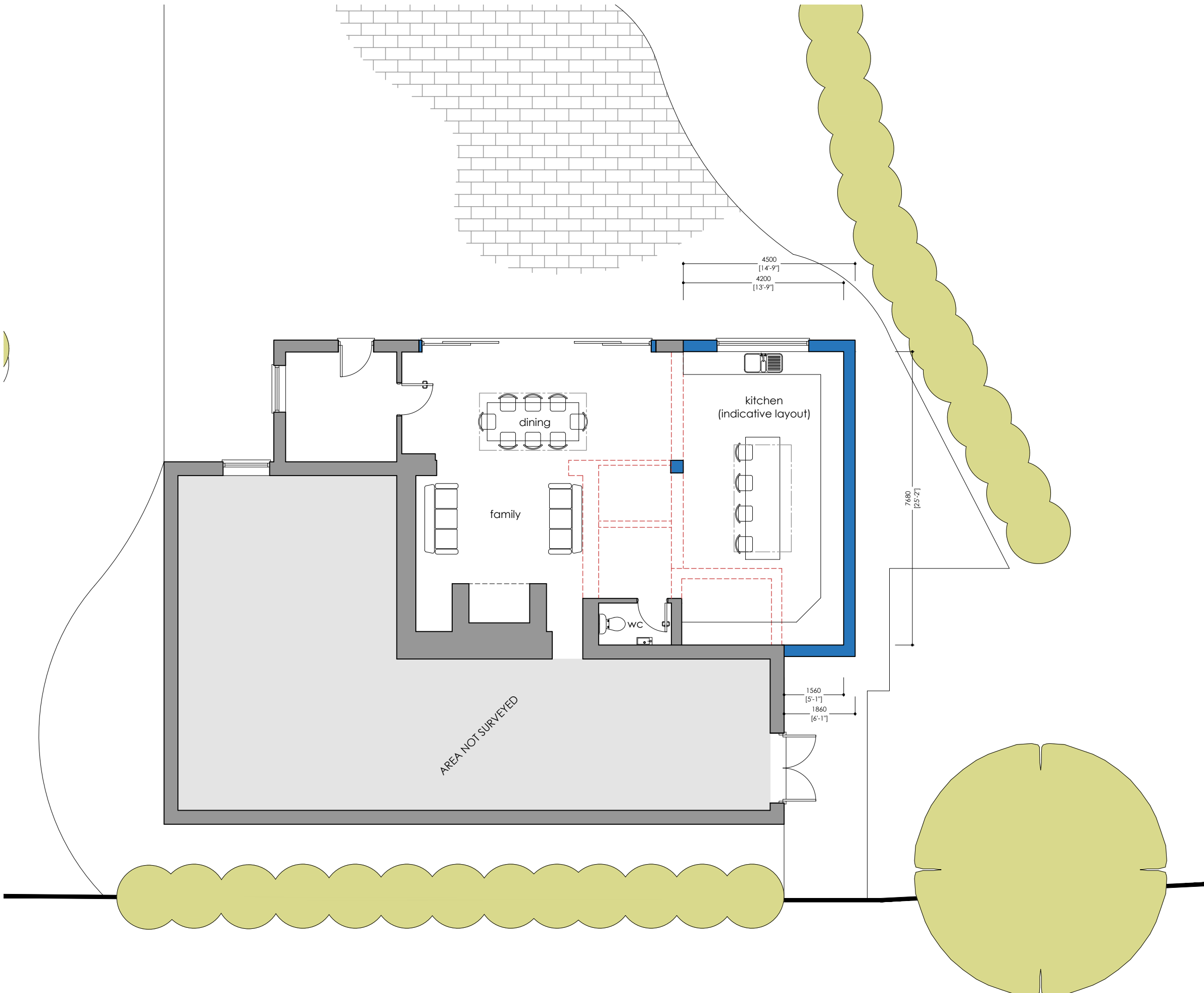

Project Title

Mr & Mrs Martin,
Westerfield
Fleming Road
Woodnesborough
Kent
CT13 0PU

Drawing Title

PLANNING APPLICATION
Proposed ground floor plan

Scale

1:50 @ A3

Drawing No.
177/06

Revision.
B



block plan