

This drawing forms part of a set of Planning Application drawings.
It is not intended for Building Control, Tender or Construction purposes.

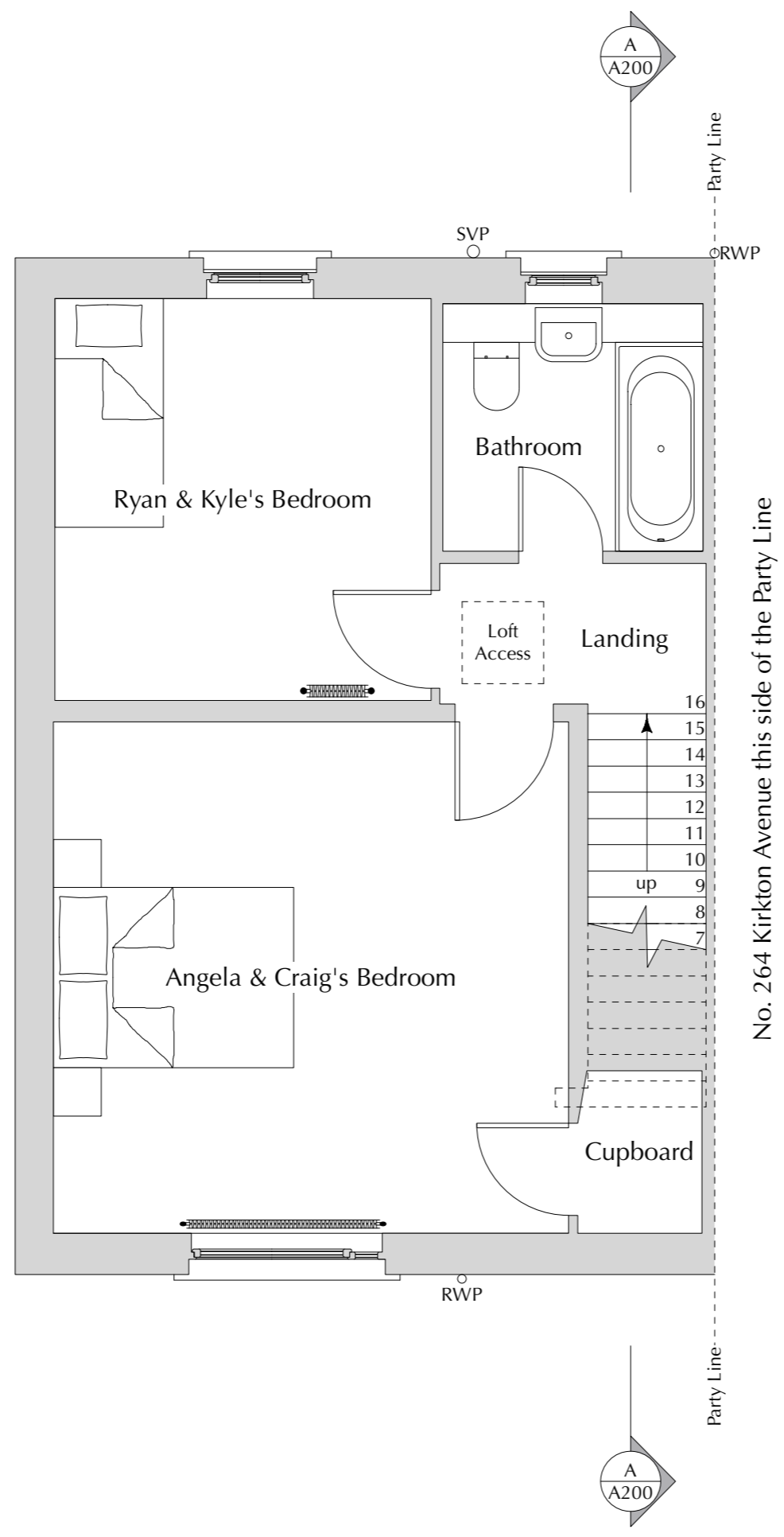

A	Amended as bubbled	24.11.23	KL
-	Initial Issue	13.11.23	KL

REV	DESCRIPTION	DATE	INITIALS
-----	-------------	------	----------

Stage
PLANNING

JOB No.	DRAWING No.	REV	SCALE
2301	A 101	A	1: 50 @ A3

DRAWING	Existing First Floor Plan
PROJECT	SINGLE STOREY EXTENSION
ADDRESS	266 Kirkton Avenue, Knightswood, Glasgow, G13 3SW
CLIENT	Angela & Craig McKechnie

KENNETH LYNCH
ARCHITECTURAL DESIGN

1 Sydenham Court, 18 Kingsborough Gardens, Glasgow G12 9QD
T: 0141 334 7173 M: 07989 302 456 E: ken@klad.co.uk W: klad.co.uk ©

