

This drawing forms part of a set of Planning Application drawings.
It is not intended for Building Control, Tender or Construction purposes.

Boundary & Landscaping retained insitu except where noted

No. 264 Kirkton Avenue this side of the Party Line

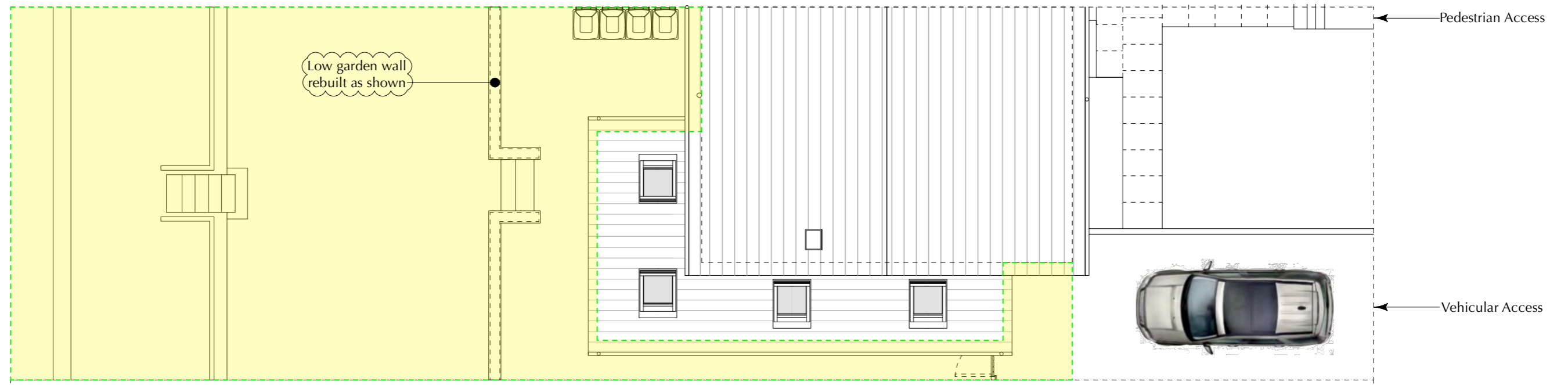

B	Amended as bubbled	24.11.23	KL
A	Amended as bubbled	23.11.23	KL
-	Initial Issue	13.11.23	KL

REV	DESCRIPTION	DATE	INITIALS
-----	-------------	------	----------

Stage
PLANNING

JOB No.	DRAWING No.	REV	SCALE
2301	A 004	B	1: 100 @ A3

DRAWING PROPOSED Site Plan Showing Roof
 PROJECT SINGLE STOREY EXTENSION
 ADDRESS 266 Kirkton Avenue,
Knightswood,
Glasgow, G13 3SW
 CLIENT Angela & Craig McKechnie

KENNETH LYNCH
ARCHITECTURAL DESIGN
 1 Sydenham Court, 18 Kingsborough Gardens, Glasgow G12 9QD
 T: 0141 334 7173 M: 07989 302 456 E: ken@klad.co.uk W: klad.co.uk ©

Original Usable Garden Space: 156 m2 (100%)
Footprint of Proposed Extension: 23.5 m2 (15% of Original Usable Garden Space)
Retained Usable Garden Space: 132.5 m2 (85% of Original Usable Garden Space)

