

SCALE
1:50@A3

Pitch Roof 47x150xC24 Rafters @400mm c/c Rafters doubled up under dormer cheeks using M12 dia bolts @ 600mm

47x150 C24 @400mm c/c slope rafters with 47x150 C24@ 400mm c/c ceiling jo

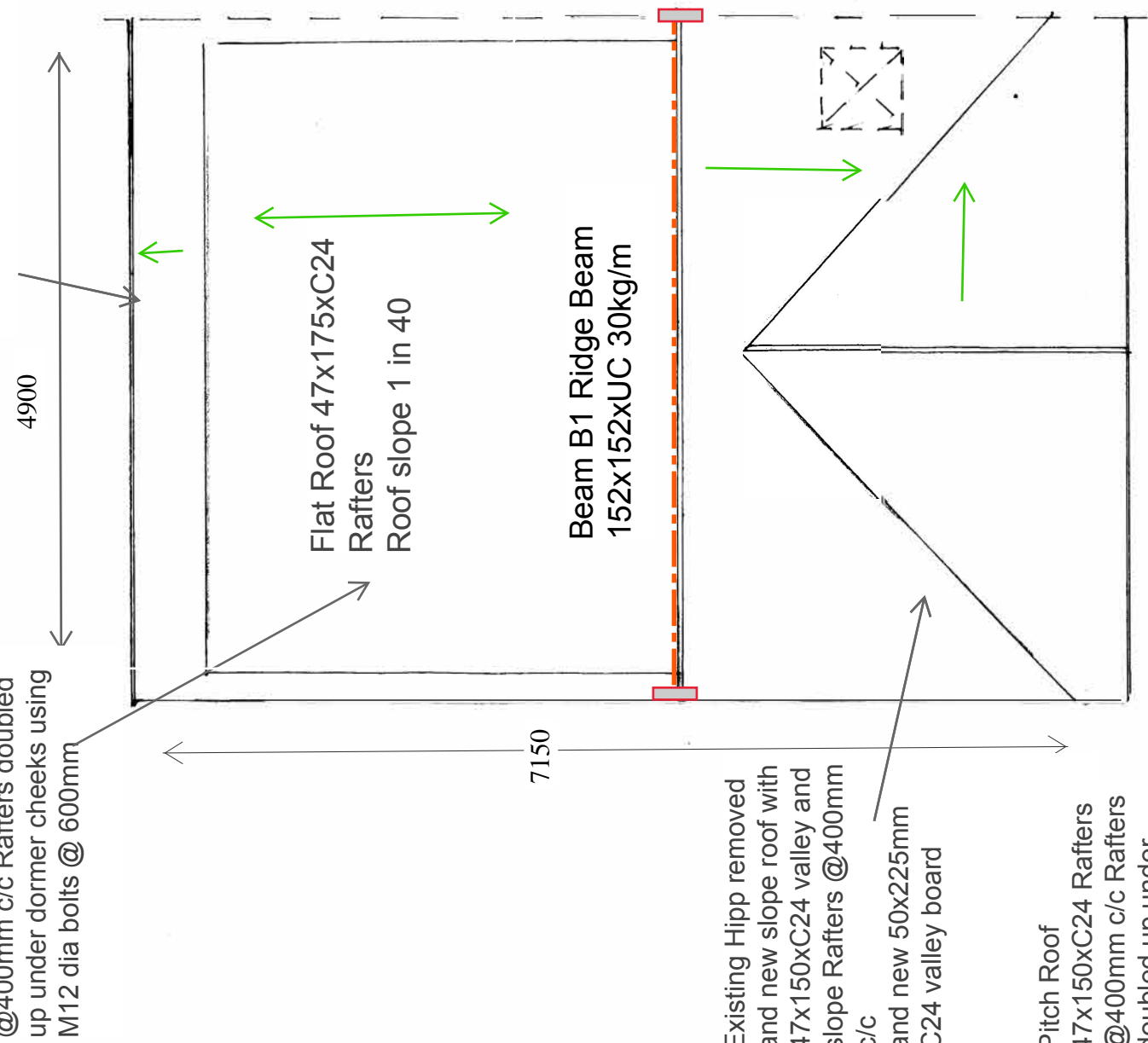

Existing HIPP removed and new slope roof with 47x150xC24 valley and slope Rafters @400mm c/c and new 50x225mm C24 valley board

Pitch Roof 47x150xC24 Rafters @400mm c/c Rafters doubled up under dormer cheeks using M12 dia bolts @ 600mm

PROPOSED ROOF PLAN

Floor Joist 47x150C24 @350 mmc/c Floor Joists doubled up and bolted together using M12 dia bolts @ 600mmc/c under partitions and around staircase well

250 x 100 x 15.0 mm THICK MILD STEEL SPREADER PLATE under all beams with 100mm bearing.

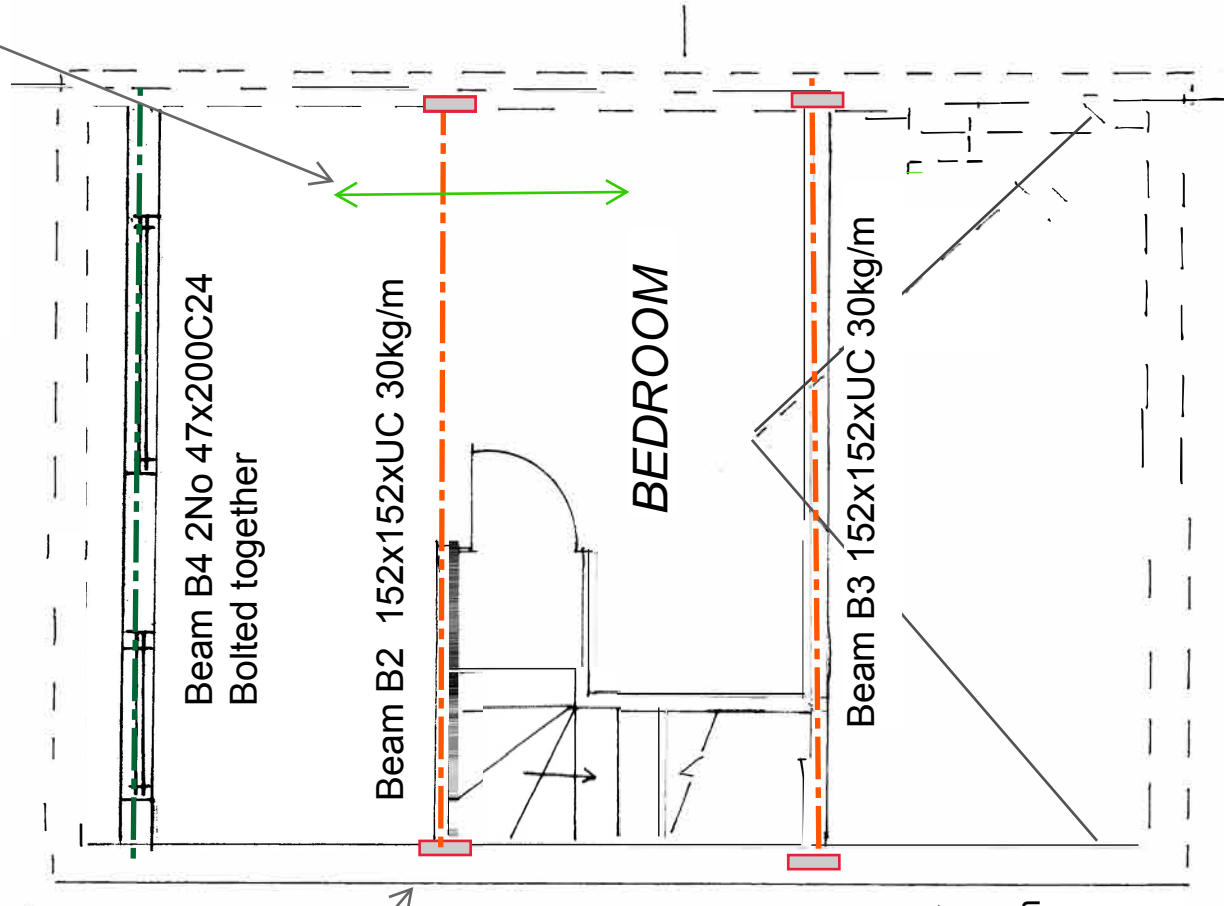

BEDROOM

Existing chimney stack removed in loft and above roof. Removal of stack above roof level to be agreed with neighbour and the whole stack removed

PROPOSED SECOND FLOOR PLAN

All structural steelwork to be Grade S355.. All steelwork to be in accordance with the general requirements of BS5950, All new steel beams in the roof space to be have 2 coats of intumescent fire retardant paint to BS 476 Part 21 applied on site.

Client Mr P AKHTER
 Project Proposed Loft Extension 140 Walton Road Woking
 Drg Ref Proposed Second Floor and Roof Plans
 Drg No WRL-02 Date - 19-08-2023
 Scale 1:50@A3