

Hatch indicates footprint of proposed dwellings

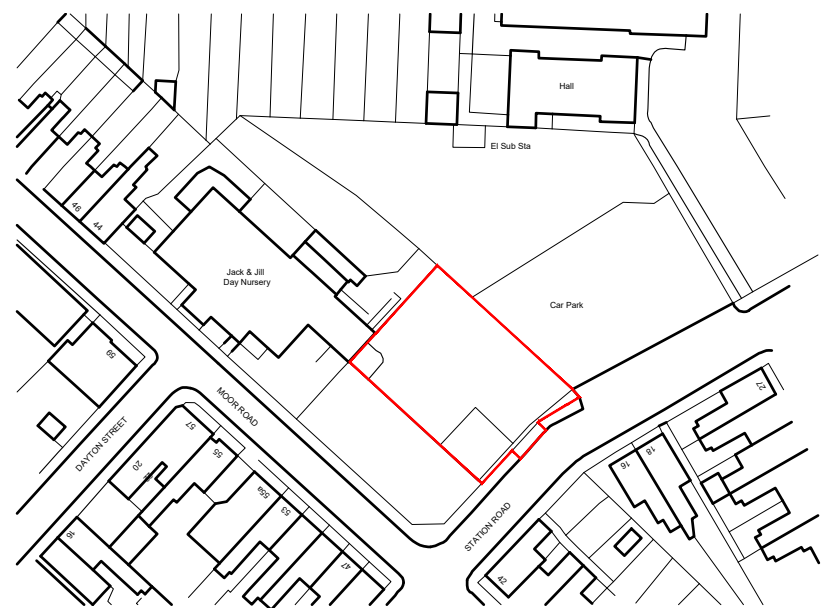

Existing Site Location Plan
Scale 1:1250

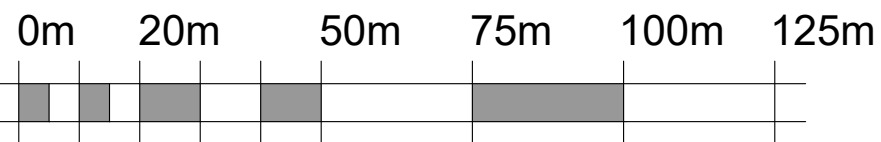
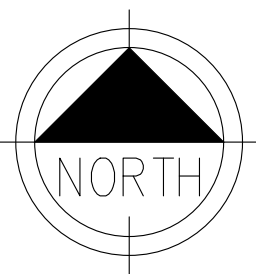

Scale 1:1250

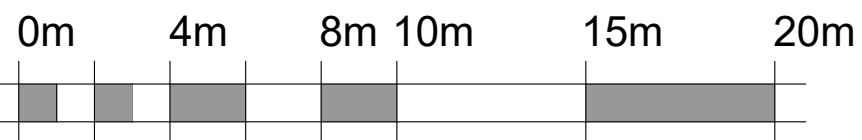

Scale 1:200



Proposed Block Plan - Scale 1:200

PLANNING ISSUE
PLEASE NOTE
THESE DRAWINGS ARE FOR THE PURPOSE OF
PLANNING ONLY
THESE ARE NOT CONSTRUCTION DRAWINGS



5 BLOTTS BARN, BROOKS ROAD, RAUNDS, NORTHANTS, NN9 6NS
01933 551389 :: info@blueprintdesign.org.uk

Car Park

| REV. | DETAILS | INIT. | DATE |
|------|--|-------|----------|
| A | Dimensions to surrounding properties added | RW | Dec 2023 |

| | | | |
|--------|---|---------|------------|
| TITLE | Proposed Residential Development on land at Station Road, Rushden, Northants NN10 9TP | | |
| DETAIL | Existing Site Location Plan & Proposed Block Plan | | |
| SCALE | 1:1250 / 1:200 | SHEET: | A3 |
| DRAWN | RW | CHECKED | 22-124-09A |
| DATE | February 2023 | ISSUE | |

CONTRACTORS MUST CHECK ALL DIMENSIONS ON SITE. ONLY FIGURED DIMENSIONS ARE TO BE WORKED FROM DISCREPANCIES MUST BE REPORTED TO BLUEPRINT BEFORE PROCEEDING. © THIS DRAWING IS COPYRIGHT.