

NOTES:

This drawing has been prepared for PLANNING APPLICATION and is not to be used for any other purpose. Dimensions are indicative and should be referenced against measured surveys only.

This drawing is the property of LUNDI ARCHITECTS and must not be reproduced, in part or whole, or deviated from, without their permission.

Dotted blue line shows indicative RPA
Refer to Tree Survey from Bernie Harverson

AMENDMENTS

DATE

AMENDMENTS	DATE
A GENERAL AMENDMENT	13.11.23

CLIENT

TONI & NEIL LANGFORD

PROJECT

PROPOSED GARAGE REPLACEMENT AND FIRST FLOOR EXTENSION
58A SOUTH ROAD, HORNDEAN
PO8 0EP

DRAWING TITLE

GROUND FLOOR SITE PLAN AS EXISTING

DATE

OCTOBER 2023

SCALE

1:100 @ A3

DRAWING No.

LA2358 04

REVISION

A

LUNDI ARCHITECTS

Lundi Architects Ltd
THE STUDIO
12A FIVE HEADS ROAD
HORNDEAN
HANTS, PO8 9NW

www.lundi-architects.co.uk
studio@lundi-architects.co.uk

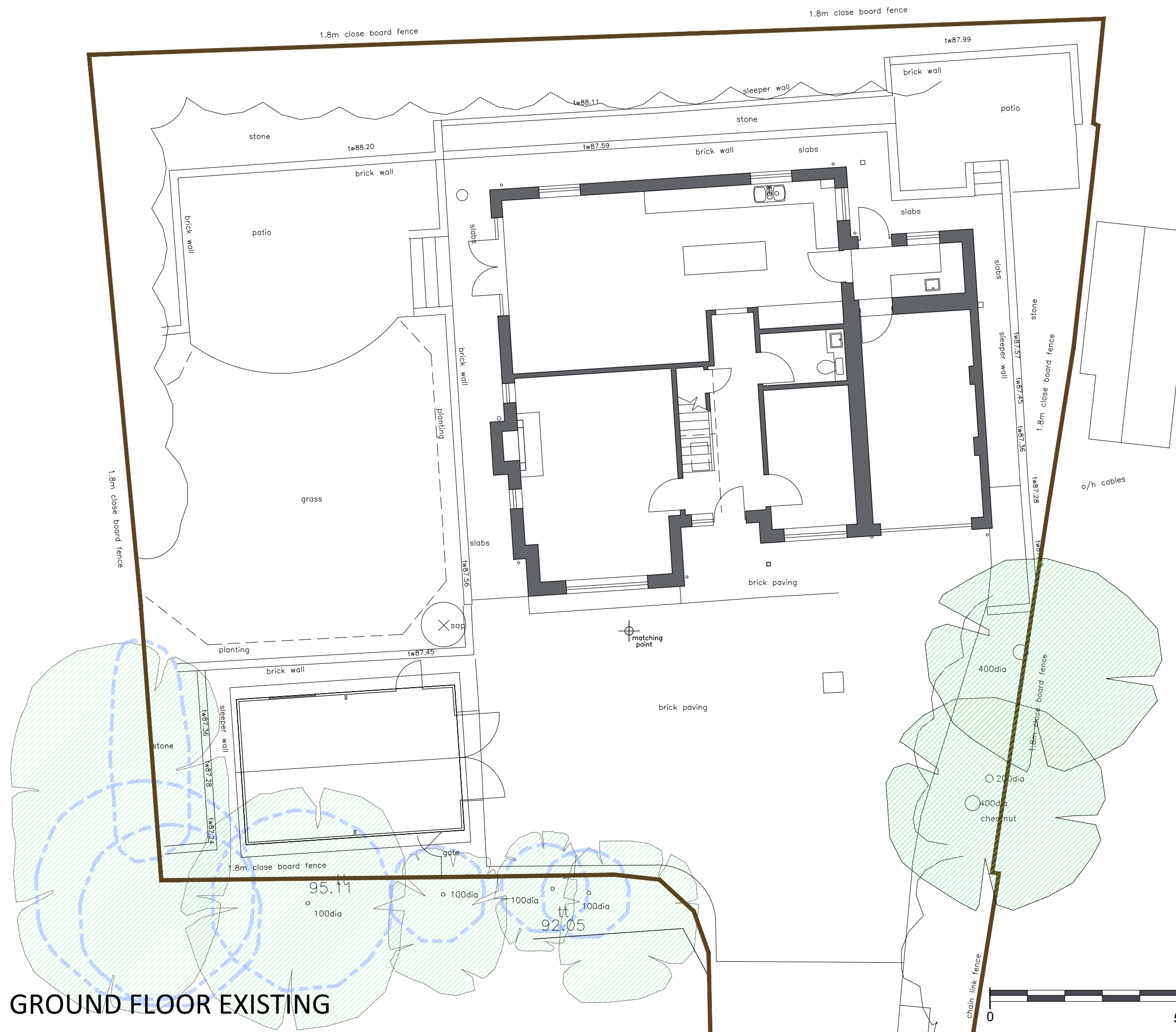

GROUND FLOOR EXISTING

