

**NOTES:**

This drawing has been prepared for PLANNING APPLICATION and is not to be used for any other purpose. Dimensions are indicative and should be referenced against measured surveys only.

This drawing is the property of LUNDI ARCHITECTS and must not be reproduced, in part or whole, or deviated from, without their permission.

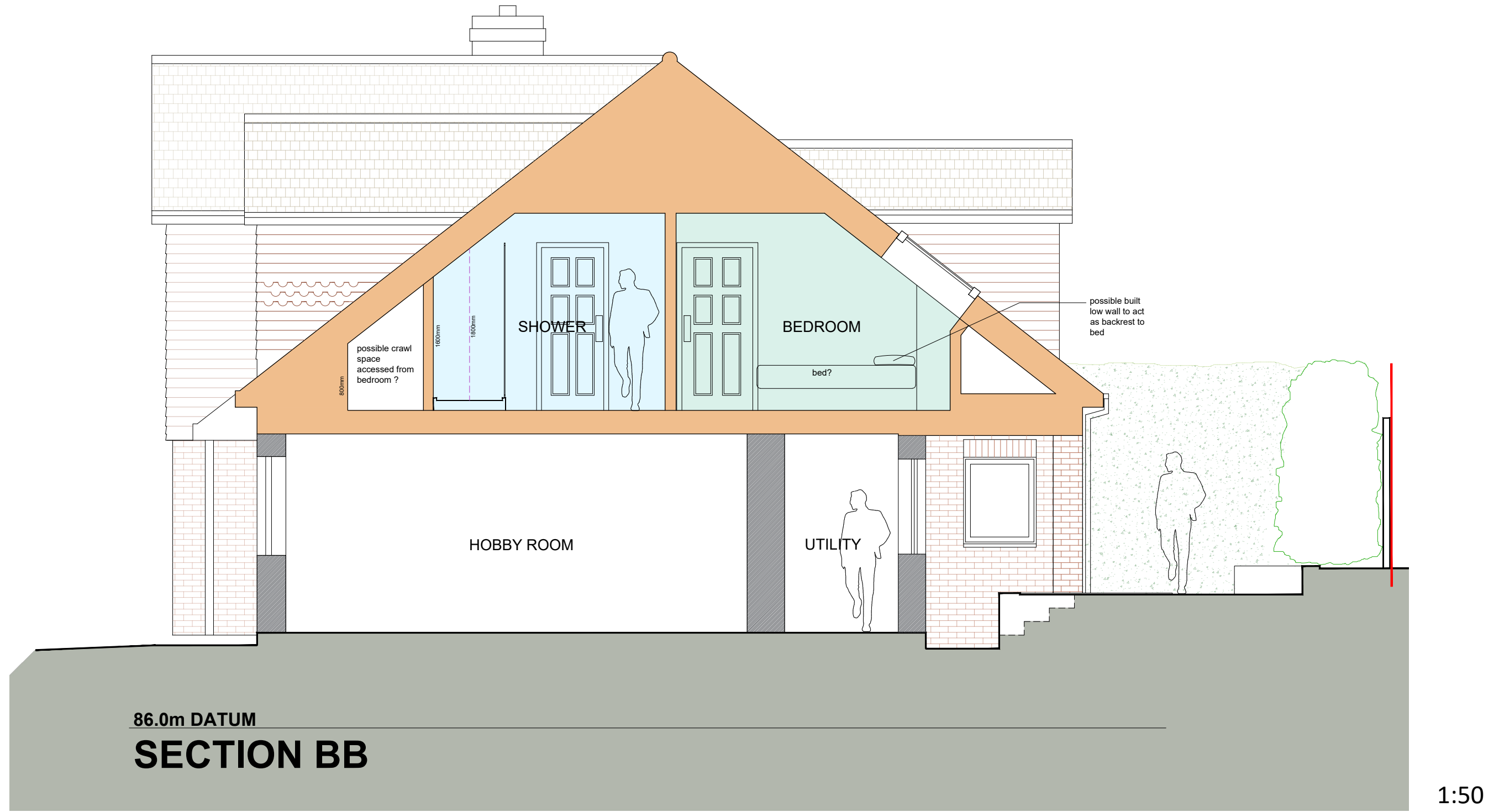

86.0m DATUM  
**SECTION BB**

1:50



AMENDMENTS	DATE
A Scale bar added	27.11.23

**LUNDI ARCHITECTS**

Lundi Architects Ltd  
THE STUDIO  
12A FIVE HEADS ROAD  
HORNDEN  
HANTS, PO8 9NW

[www.lundi-architects.co.uk](http://www.lundi-architects.co.uk)  
[studio@lundi-architects.co.uk](mailto:studio@lundi-architects.co.uk)

CLIENT  
**TONI & NEIL LANGFORD**

PROJECT  
**PROPOSED GARAGE REPLACEMENT  
AND FIRST FLOOR EXTENSION**  
58A SOUTH ROAD, HORNDEN  
PO8 0EP

DRAWING TITLE  
**CROSS SECTION BB  
AS PROPOSED**

DATE  
OCTOBER 2023

SCALE  
1:50 @ A3

DRAWING No.  
**LA2358 022**

REVISION  
**A**