

NOTES:

This drawing has been prepared for PLANNING APPLICATION and is not to be used for any other purpose. Dimensions are indicative and should be referenced against measured surveys only.

This drawing is the property of LUNDI ARCHITECTS and must not be reproduced, in part or whole, or deviated from, without their permission.

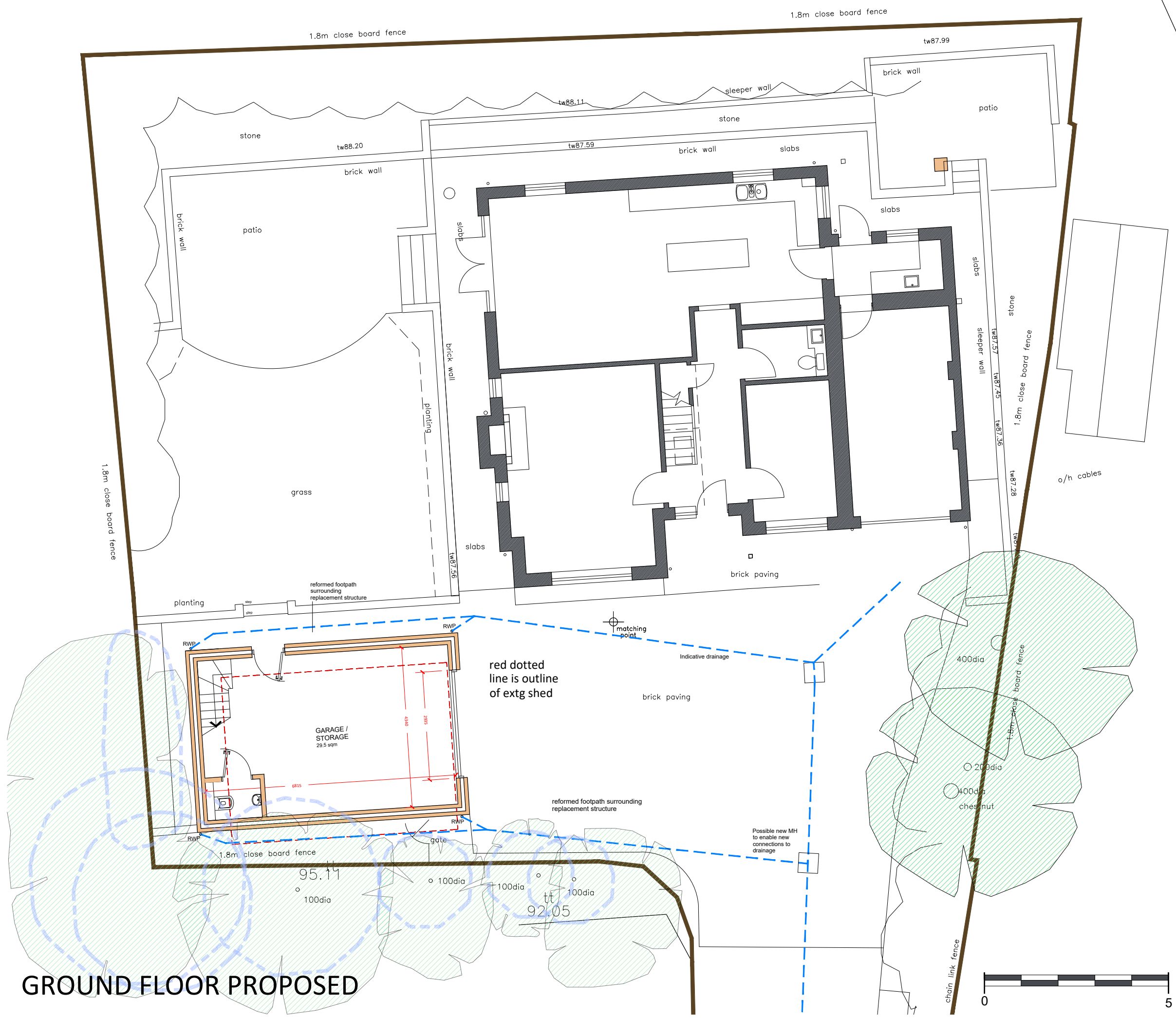

AMENDMENTS	DATE
B GENERAL AMENDMENT	16.11.23
A GENERAL AMENDMENT	13.11.23

CLIENT
TONI & NEIL LANGFORD

PROJECT
PROPOSED GARAGE REPLACEMENT AND FIRST FLOOR EXTENSION
 58A SOUTH ROAD, HORNDEAN
 PO8 0EP

DRAWING TITLE
GROUND FLOOR LAYOUT AS PROPOSED

DATE
 OCTOBER 2023

SCALE
 1:100 @ A3

DRAWING No.
LA2358 06

REVISION
B

LUNDI ARCHITECTS

Lundi Architects Ltd
THE STUDIO
 12A FIVE HEADS ROAD
 HORNDEAN
 HANTS, PO8 9NW
www.lundi-architects.co.uk
studio@lundi-architects.co.uk

