

This drawing is the copyright of LMA Architects and may not be copied or reproduced without permission.

LMA Architects does not accept responsibility for errors made by others in scaling from this drawing. All construction information should be taken from figured dimensions only. If in doubt refer to LMA Architects.

Dimensions for fixed in items to be checked on site prior to manufacture.

Main contractor to enquire into the availability of Asbestos surveys where applicable, and ensure they take their own precautions for dealing with the associated risks.

Any unusual risks will be identified within the project design for construction, maintenance or demolition. End user and Main Contractor to review project with residual risks in mind and report any unforeseen previously to LMA Architects.

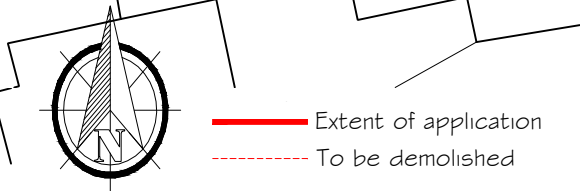
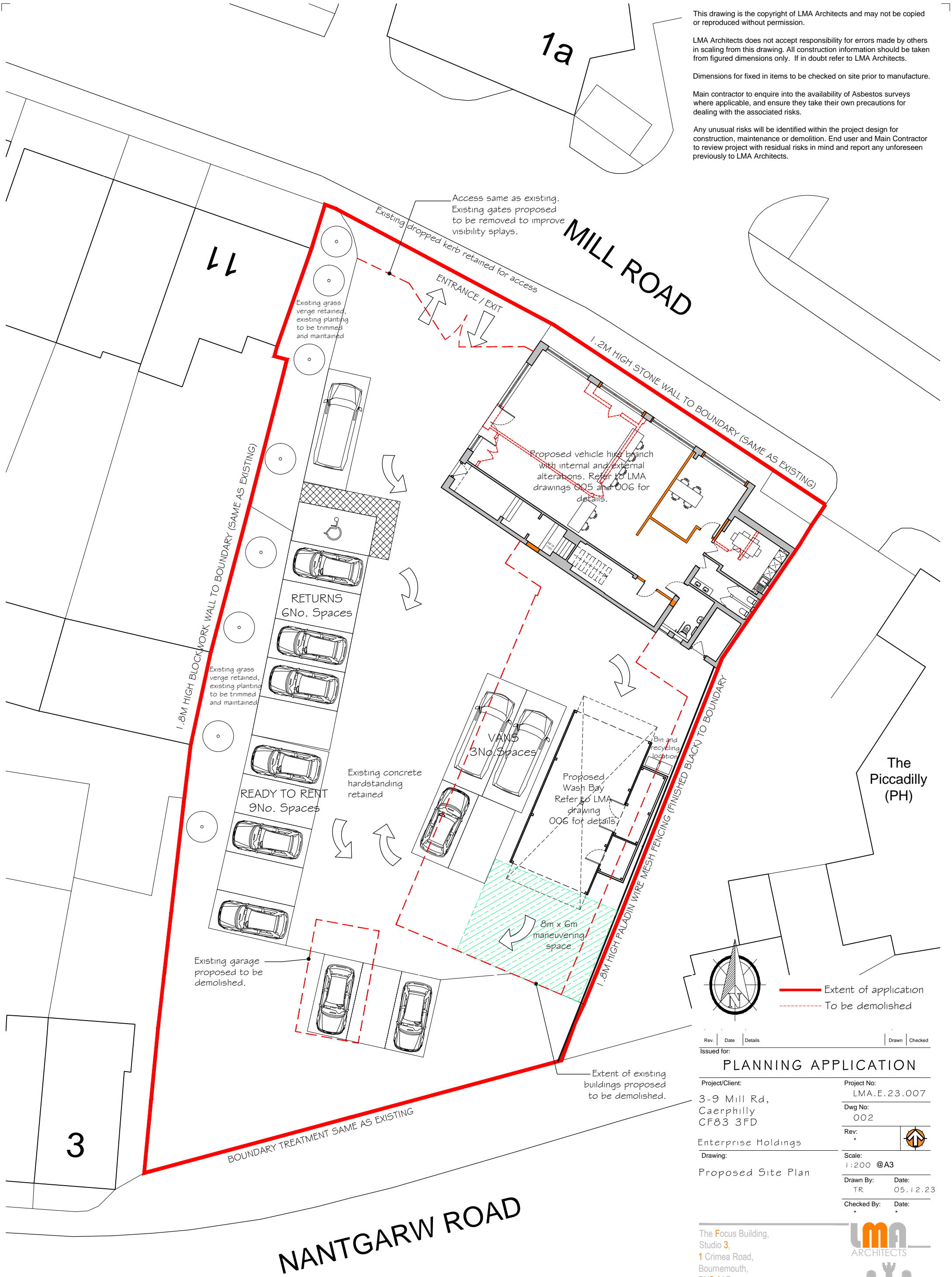

Rev.	Date	Details	Drawn	Checked
Issued for:				
<b>PLANNING APPLICATION</b>				
Project/Client:		Project No:		
3-9 Mill Rd, Caerphilly CF83 3FD		LMA.E.23.007		
Enterprise Holdings		Dwg No:		
Drawing:		002		
Proposed Site Plan		Rev:		
		Scale:		
		1:200 @A3		
		Drawn By:		
		Date:		
		TR 05.12.23		
		Checked By:		
		Date:		

The Focus Building,  
Studio 3,  
1 Crimea Road,  
Bournemouth,  
BH9 1AP

**LMA**  
ARCHITECTS

T:01202 375818  
info@lmaarchitects.co.uk  
www.lmaarchitects.co.uk

