

DR ANDREW YATES MB BS FRCA

21 November 2023

Winchester County Council
Planning Control, City Offices
Colebrook Street
Winchester
SO23 9LJ

Dear Sir or Madam:

Re: Oak at front corner of stables

I have a large oak tree, which has a TPO put on it years ago.

This oak at the corner of a stable block is causing some concern. Whilst there is no intention to remove the tree, we have sought professional advice. It is their opinion that it would benefit from a 30% reduction back to growth points and a rebalancing of said tree. More of a worry is that the root system may be encroaching on the stables but there is no evidence of this as yet.

Of note this oak tree was previously assessed in 1996 (Case No 9602455TPO your ref: WTPO/1253/01) and had some remedial work carried out involving some trimming.

I would be grateful if you can give this your consideration, as I would like to deal with this sooner rather than later, if consent is granted. Access to the property is easy and the tree is visible from the drive on the right of the stable block.

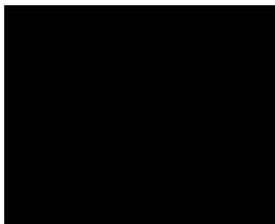

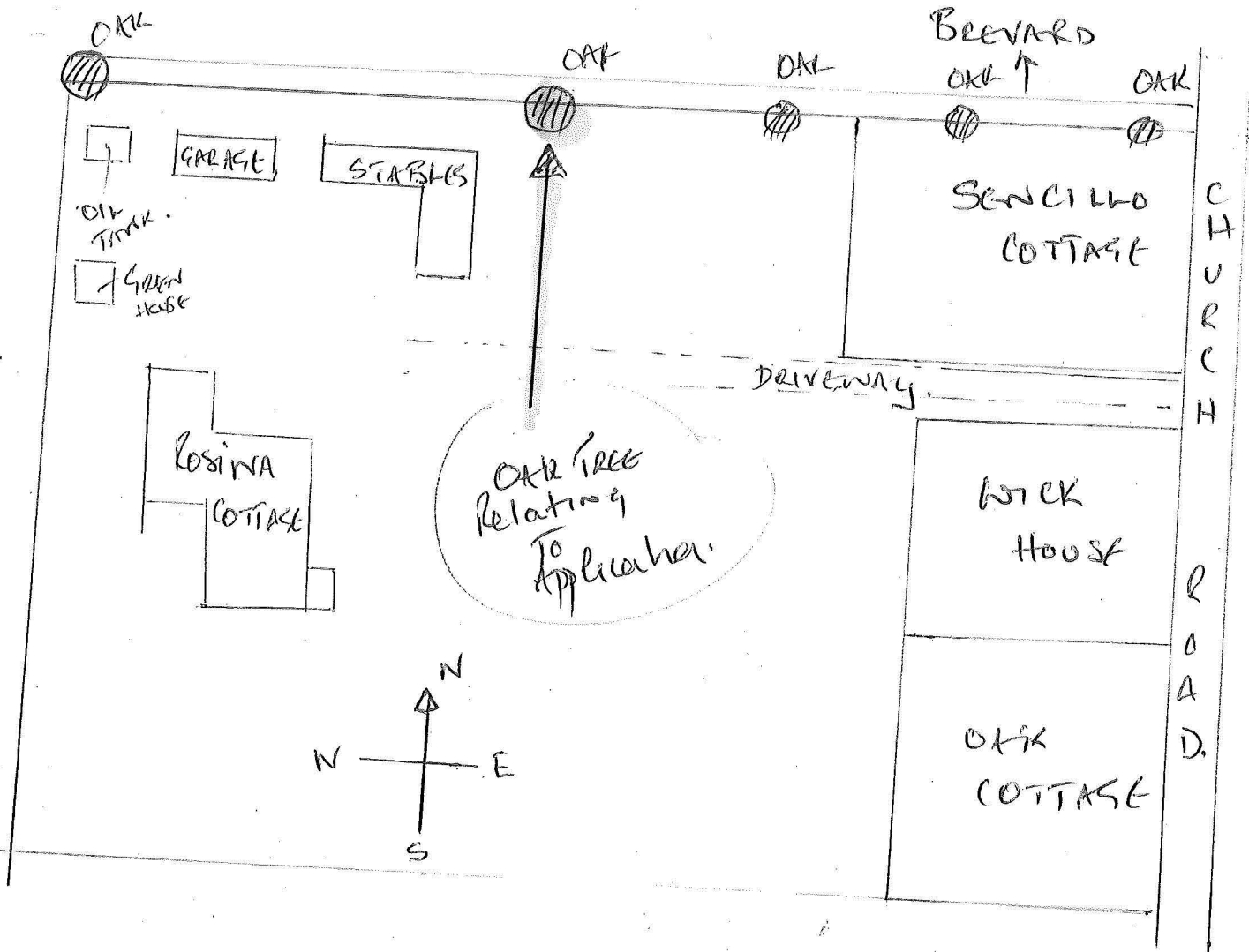

OAK TREE
Relation
To
Application.

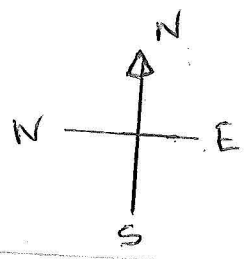

TPO letter enquiry - WCC

From Natural Environment <NaturalEnvironment@winchester.gov.uk>

To [REDACTED]

Date 2023-11-28 09:47

 scan_ajanicki_2023-11-27-13-49-32.pdf (~364 KB)  TWApplicationForm_GuidanceNotes.pdf (~184 KB)  TWApplicationForm.pdf (~987 KB)

Dear Dr Yates,

Thank you for sending the attached letter.

The attached area is covered by TPO, so for any trees within this area, an application will be required before carrying out any tree work.

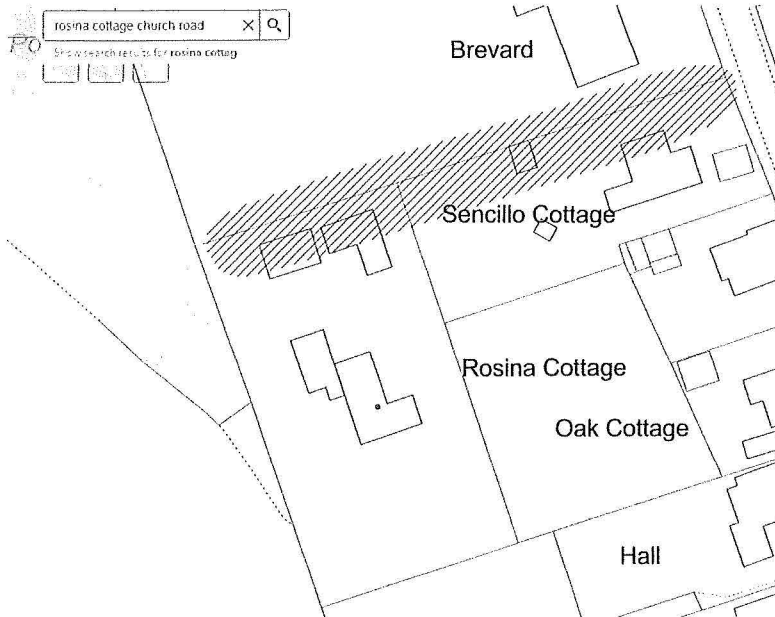

Please see attached application form and separate guidance notes for tree works .

Once completed please return to:

By Post

Natural Environment and Recreation
City Offices
Colebrook Street
Winchester
SO23 9LJ

Email

naturalenvironment@winchester.gov.uk

Online

Alternatively you can submit your application online via the Planning Portal by clicking on the link below

<https://www.planningportal.co.uk/>

You will be directed to the Planning Portal and required to register as a new user before you can submit your application.

For 'Application type' scroll down to other consents and select 'Tree Works'