

NOTES:  
 This drawing has been produced solely for PLANNING/DESIGN.  
 Do not Scale from this Drawing except for planning purposes.  
 Any drainage shown is presumed and to be checked on site  
 before commencement of works.  
 This drawing is the copyright of MF Designs Ltd.

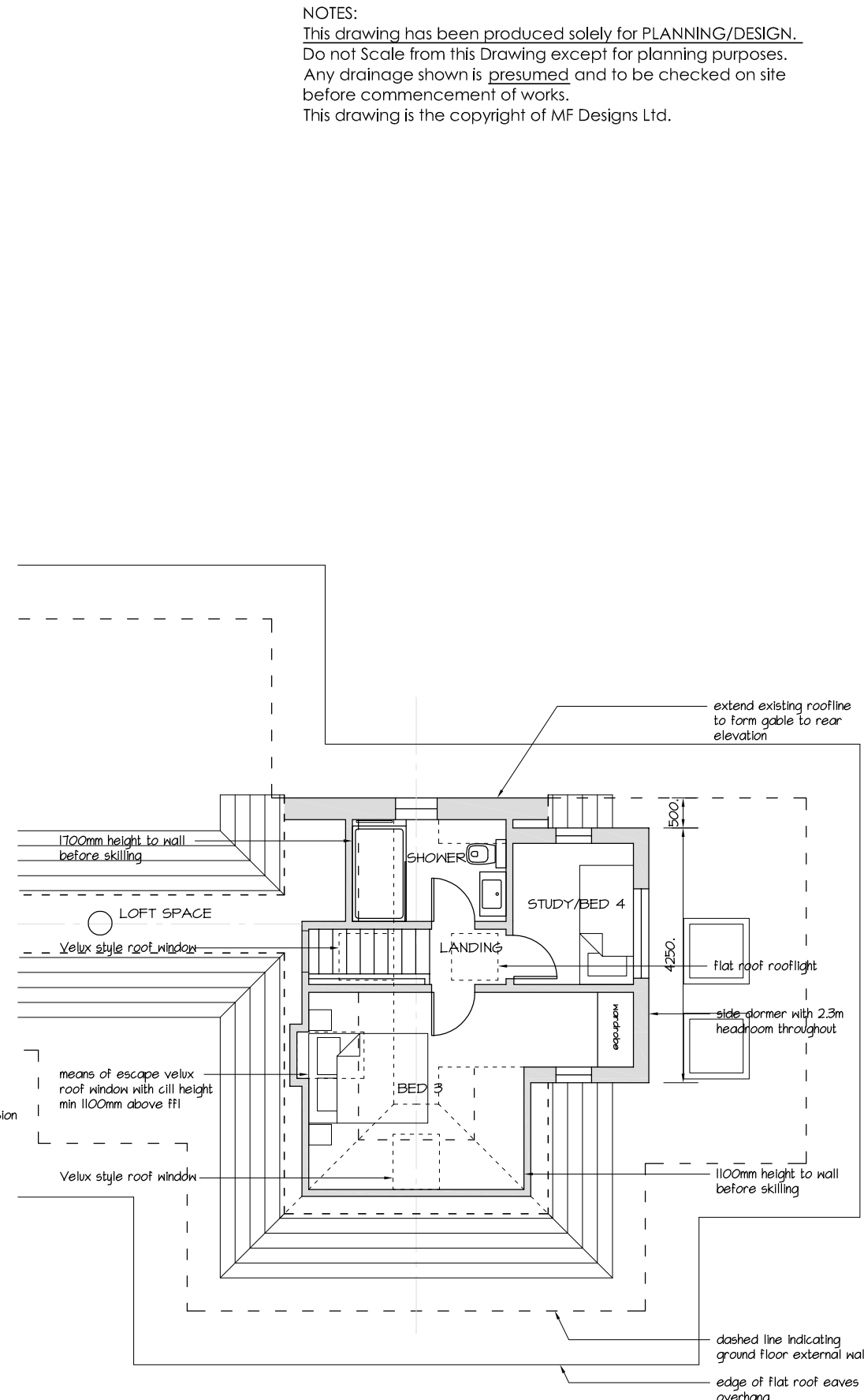
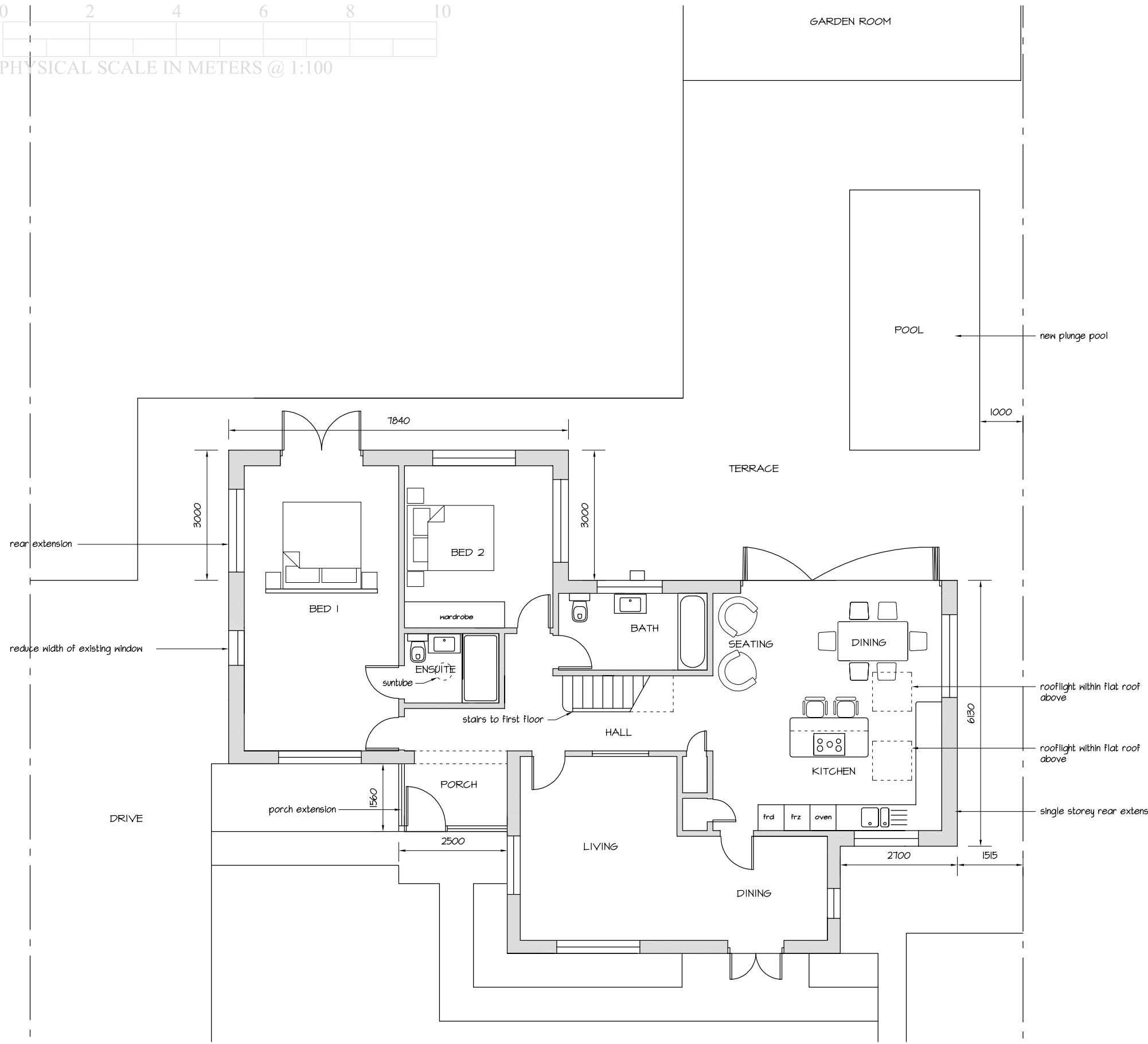

Proposed Ground

Proposed First

(single storey extensions as approved under application SB/23/00937/DOM)

EXTENSION & ALTERATIONS with ROOF EXTENSION  
 51 Breach Avenue, Southbourne. PO10 8NB

B: 14/11/2023 - Roof conversion/extension with side dormer window  
 A: 15/09/2023 - western side extension omitted/ revised Bed 1 window

**mf designs ltd**

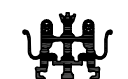

Chartered Architects



36 Grove Road • Havant • Hampshire • PO9 1AR      t/f 02392 470967  
 Director: Martin Farrer RIBA • Co Registration No.4507379      e admh@mfdesigns.org.uk

Date: April 2023      Job No: 3315  
 Scale: 1:100      Drg No: P\_01 B