

REV A: Amendment to include scale bar.

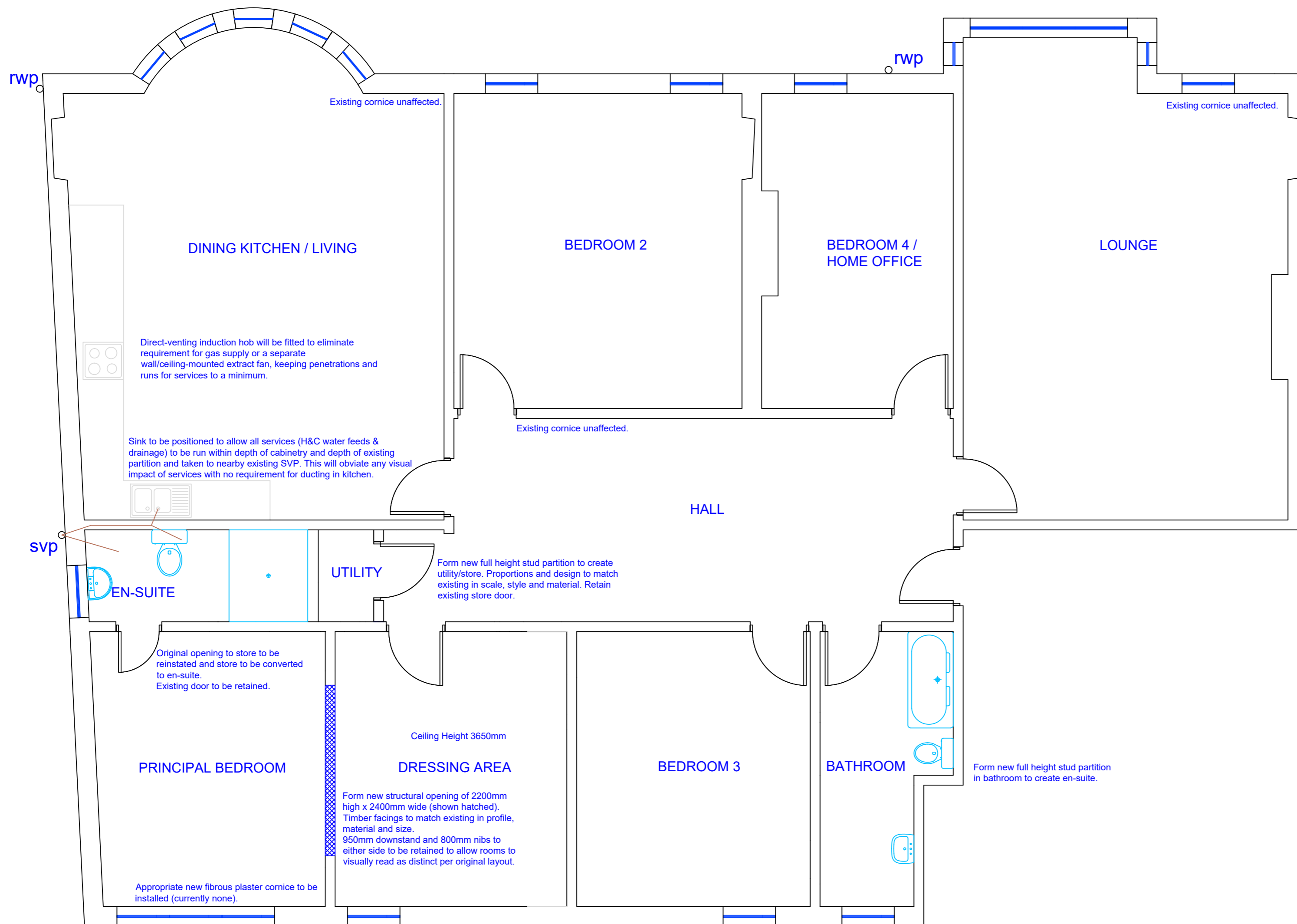

AS PROPOSED

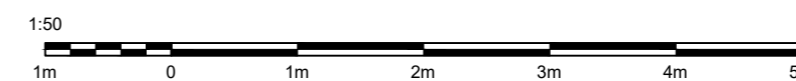

MCM Consultants

Tel. (+34) 6551 33580
Email: mcmconsultants@outlook.com

Date: 8th Dec 2023 PS: A2

Client:	Mr Chris McManus & Miss Rhiannon Halfpenny
Project:	Alterations to 3/1, 1 Novar Drive, Hyndland, G12 9PX
Drawing:	4 Bedroom Flat Floorplan - As Proposed
Dwg. No:	ND_002 Rev A Scale: 1:50