

LOCATION PLAN
1:1250

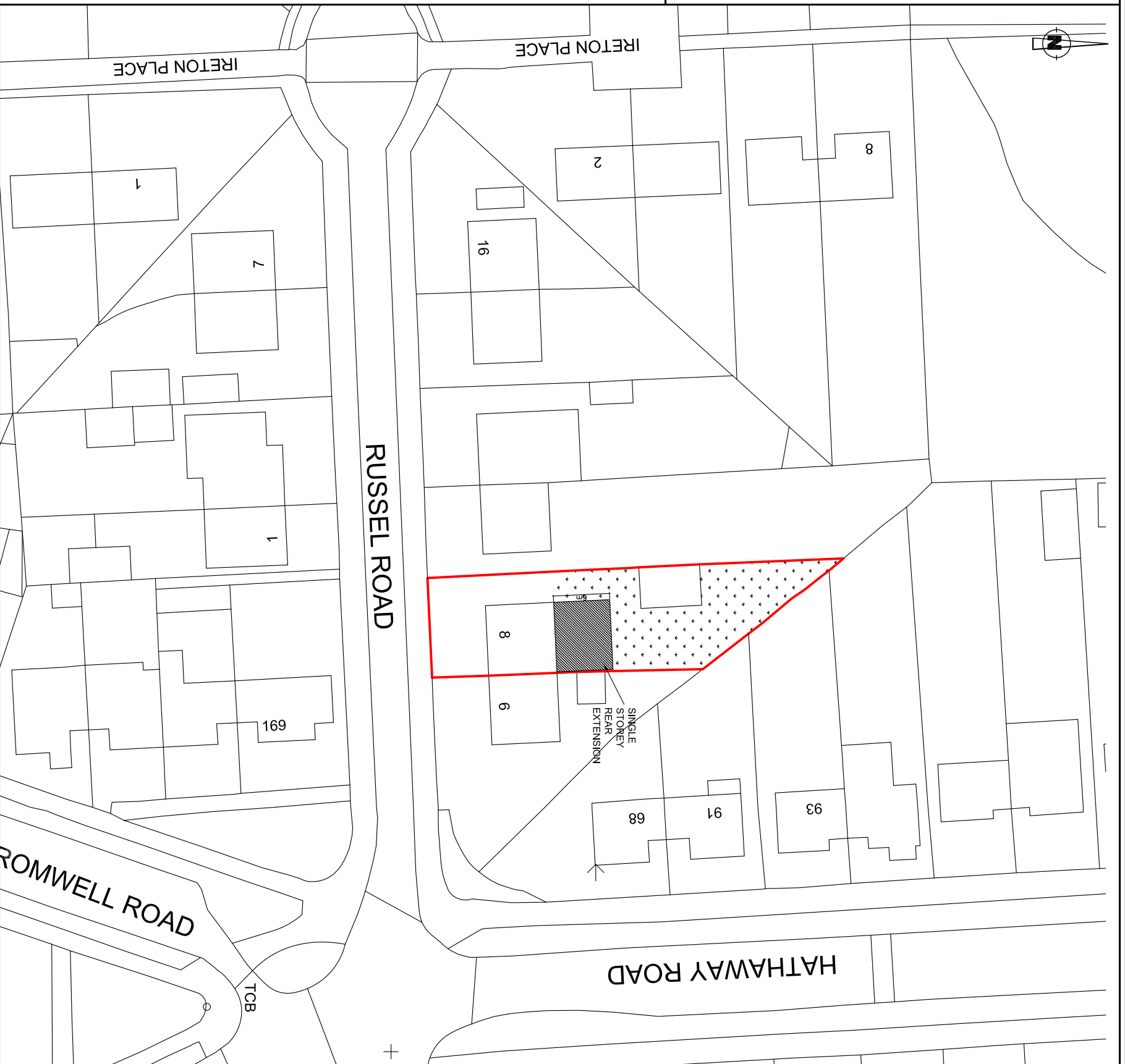

BLOCK PLAN
1:500

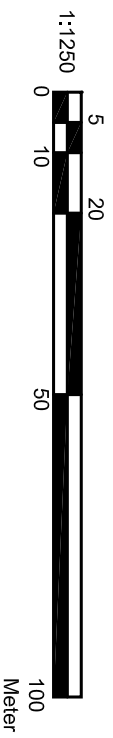

Notes.

- 1 It is the responsibility of the client, contractor and supervising officer to follow the instructions below
 - 2 This drawing to be read in conjunction with all relevant drawings. Any discrepancies found to be notified to the Supervising Officer immediately
 - 3 Only figured dimensions to be used for constructional purposes
 - 4 All works to be carried with all relevant local authority approvals and to the satisfaction of the building control inspector. existing structure to be opened for inspection if required, all dimensions are to be checked on site prior to commencement of works.
 - 5 All external finishes to match existing or conditions imposed on approved planning for scheme
 - 6 This drawing is copyright of JND & can not be reproduced without JND's approval
- THIS IS A PLANNING DRAWING ONLY

REV	AMENDMENT	DATE
A	REDUCED WIDTH OF REAR EXT.	14/12/23



JND2 Designs
DESIGN, ARCHITECTURE, PLANNING AND
PROJECT MANAGING CONSULTANTS

Client:
MR. G. MESHI

Project:
PROPOSED SINGLE STOREY
REAR EXTENSION AT
8, RUSSELL ROAD, GRAYS,
ESSEX RM17 5JX

Title:
LOCATION AND BLOCK PLAN

Scale: 1:500, 1:1250 @A3	Date: NOV, 2023
Drawn: JP	Checked: JC
Dwg. No JND / 1337/ 14	Rev-