

Co-ordinate Schedule: 0794				
Station	Easting	Northing	Height	Remarks
ADS44082	429604.188	137352.569	73.183	PK SURVEY NAIL
ADS44134	429615.805	137342.589	73.936	PK SURVEY NAIL
ADS44135	429637.410	137315.938	74.325	PK SURVEY NAIL

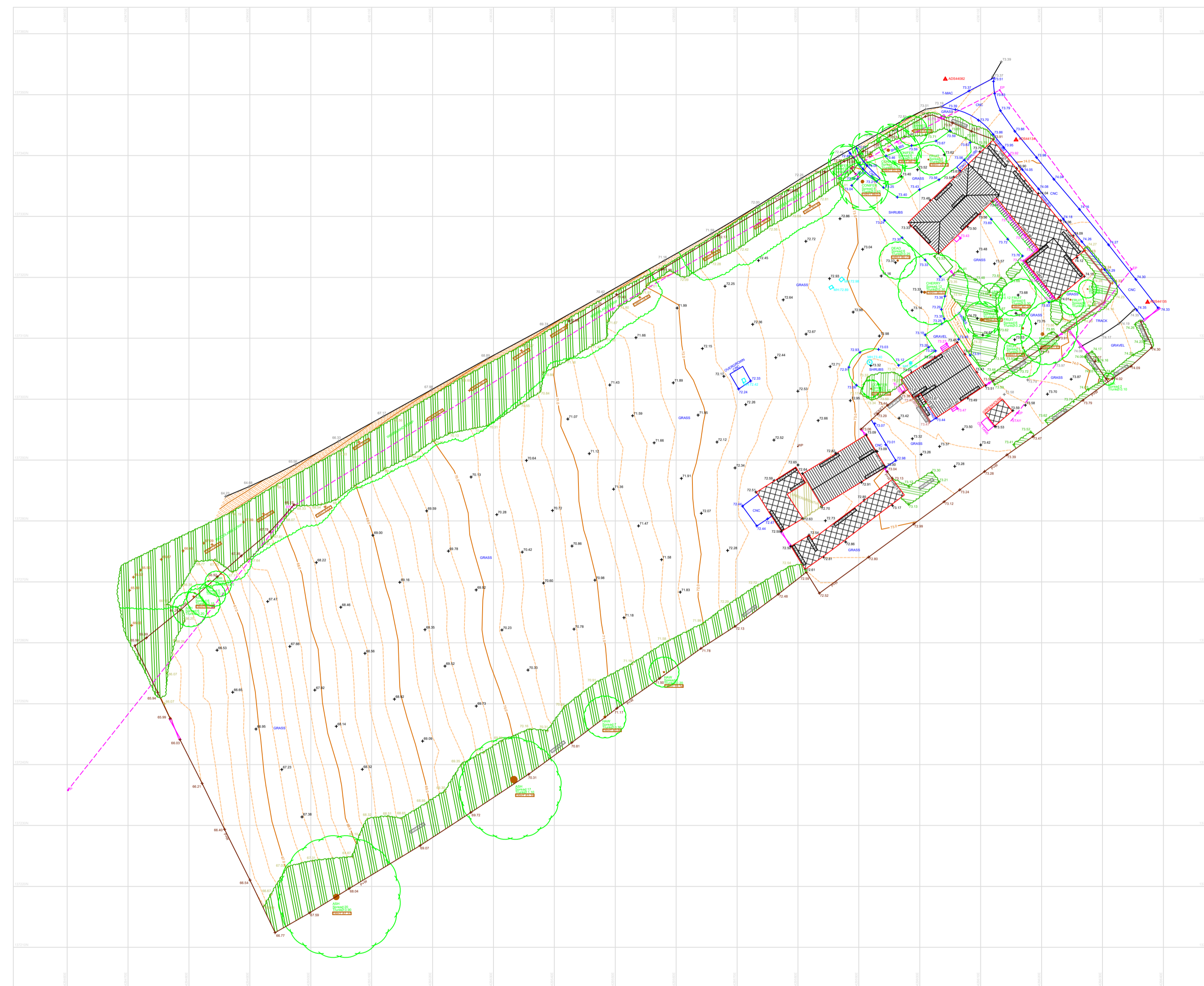

DATE	DETAILS
20/04/22	ORIGINAL ISSUE
	SURVEYED AND PROCESSED BY: ADS DRAWN BY: WJ

NOTES

ADS Surveys Ltd. Own the copyright of this drawing. Their written consent must be obtained before this drawing is copied, forwarded to any third parties, or used for any purpose other than the one for which it was supplied.

This survey has been carried out to an accuracy consistent with a presentation scale of 1:200; therefore interrelated dimensions will be within the tolerance associated with this scale. The same accuracies implied by the plotting scale are equally applicable to digital data supplied for CAD. The scale of this drawing should not be changed without permission.

Boundaries shown are not necessarily legal boundaries.

Building footprints edged with a solid line have been surveyed. Where the outline is merely hatched the footprint is indicative only.

All levels, heights, measurements and dimensions are in metres unless otherwise stated.

Eaves levels are generally surveyed at the end of the roof slate/tille/hatch. In cases where this is not possible the top of gutter is surveyed instead. Where underside of fascia or other features are surveyed these are recorded as such.

All below-ground features (including drainage, voids and services) have been identified from above ground and therefore all details relating to these (such as sizes, depth, pipe positions and alignments; description etc.) will be approximate only.

Underground services have not been traced, but any visible surface features have been located. No allowance has been made for any sub-surface manholes or other chambers or voids below ground level. While every effort is made to identify all visible above-ground features, it should be noted that there may be features obscured at the time of survey.

Spot heights at edges of roads are road/gutter levels, not top of kerb unless otherwise stated.

Trees have been drawn diagrammatically (i.e. Circular) showing average canopy spread, however their true shape in plan will be different.

All heights within the drawing relate to OS datum (AOD) unless specified otherwise.

Measurements to internal walls have been taken to the wall finishes at approximately 1m above floor level and assumed to be vertical.

LEGEND

ACU	AIR CONDITIONING UNIT	DEBM	OS BENCHMARK
AHT	ABRP HEAD HEIGHT	RE	ROOFING EYE
AV	AIR VENT	RS	ROOF SLOPE
BB	BELLISA BEACON	RWP	RUNWAY PPE
BOL	BOLLARD	SC	STOP CODE
CATV	CABLE TV COVER	SC	SIGN POST
CCV	CCTV SECURITY CAMERA	SP	SPRING POINT OF ARCH
CH	CHILL TO HEAD LEVEL	SV	STOP VALVE
CL	COVER LEVEL	SW	SOB & HSBP PPE
CLG	CEILING HEIGHT	TH	THRESHOLD LEVEL
CMC	CONCRETE	TL	TRAFFIC LIGHTS
DK	DROP KERB	TOP	TOP OF FENCE
DPC	DAMP PROOF COURSE	TDF	TOP OF FLOOR JOISTS
EP	ELECTRICITY POLE	TOH	TOP OF RIDGE
ER	EARTHING ROD	TOWP	TOP OF WALL
FB	FLOWER BED	TRP	TOP OF WALL PLATE
FC	FLOOR TO CILL LEVEL	TRT	TRIP
FIL	FINISHED FLOOR LEVEL	TRH	TREE HEIGHT
FH	FIRE HYDRANT	TS	TREE STUMP
FL	FLOOR LIGHTS	UN	UNKNOWN SPECIES
FS	FLAGSTAMP	UB	UNDER-SIDE OF BEAM
GL	GULLY LEVEL	UC	UNDER-SIDE OF CILL
GP	GATE POST	UCOL	UNDER-SIDE OF COLAR
GV	GAS VALVE	UDH	UNDER-SIDE OF DOORHEAD
GV	GULLY	UFB	UNDER-SIDE OF FANCLIA
IC	INSPECTION COVER	UFB	UNDER-SIDE OF FLOORBOARDS
ICB	ICE COVER	UFP	UNDER-SIDE OF POSTS
ICE	ELECTRICITY COVER	UFP	UNDER-SIDE OF FURCH
ICG	IRIS COVER	UGB	UNDER-SIDE OF RIDGE
ICTL	TRAFFIC LIGHT COVER	UGB	UNDER-SIDE OF ROOFBOARD
ICW	WATER COVER	UGSB	UNDER-SIDE OF ROLLED-STEEL JOIST
IL	INVERT LEVEL	UST	UNDER-SIDE OF TRUSS
IL	LAMP POST	USWB	UNDER-SIDE OF WINDOWHEAD
MH	MANHOLE	USWP	UNDER-SIDE OF WALLPLATE
MHW	MANHOLE - FOLI WATER	UTL	UNABLE TO LIFT
MHW	MANHOLE - SURFACE WATER	WM	WATER METRE
MP	MARKER POST	WP	WASTE PIPE
MP	MARKER POST	WV	WATER VALVE

FENCES

AP	ANGLE IRON FENCE
BBF	BAMBOO WOOD FENCE
CBF	CLOSE BOARDED FENCE
CF	CORRUGATED WIRE FENCE
CH	CHAINLINK FENCE
IR	IRON RAILING
LJF	LARCH LAMP FENCE
OB	OPEN BOARD FENCE
PH	POST & RAIL FENCE
PHD	POST & RAIL FENCE
PWF	POST & WIRE FENCE
RW	RETAINING WALL
CS	CONCRETE POST/STEEL POST/TIMBER POST

FEATURES

OVERHEAD WIRE

DRAINAGE INFORMATION (PIPE DIAMETER & FLOW DIRECTION)

TREES

DECIDUOUS

CLIENT
DAVID & PIPPA PERRIN

DRAWING TITLE
TOPOGRAPHICAL SURVEY

PROJECT
NORTHBROOK BARN
KNOCKWOOD LANE
NETHER WALLOP

ADS SURVEYS

ADS Surveys Ltd
Andell House
Highfield Lane
Woodfalls, Wiltshire
SP5 2NG
Tel: 07738 462205
Email: andy@ads-surveys.uk

chartered THE SURVEY ASSOCIATION

The horizontal & vertical control of this survey is based on Ordnance Survey grid as translated from GPS co-ordinates using the OSTN02 & OSGM02 transformation as supplied by OS. We have applied a reverse scale factor to maintain true ground distances. Vertical values may differ from existing OS benchmarks in the vicinity which should be disregarded. All levels should be taken from ADS survey control.

Scale: 1:500 Plotted on A1	REV. -	Drawing No: ADS/0794-TP1 © ADS Surveys Ltd. 2014
----------------------------------	-----------	--

