

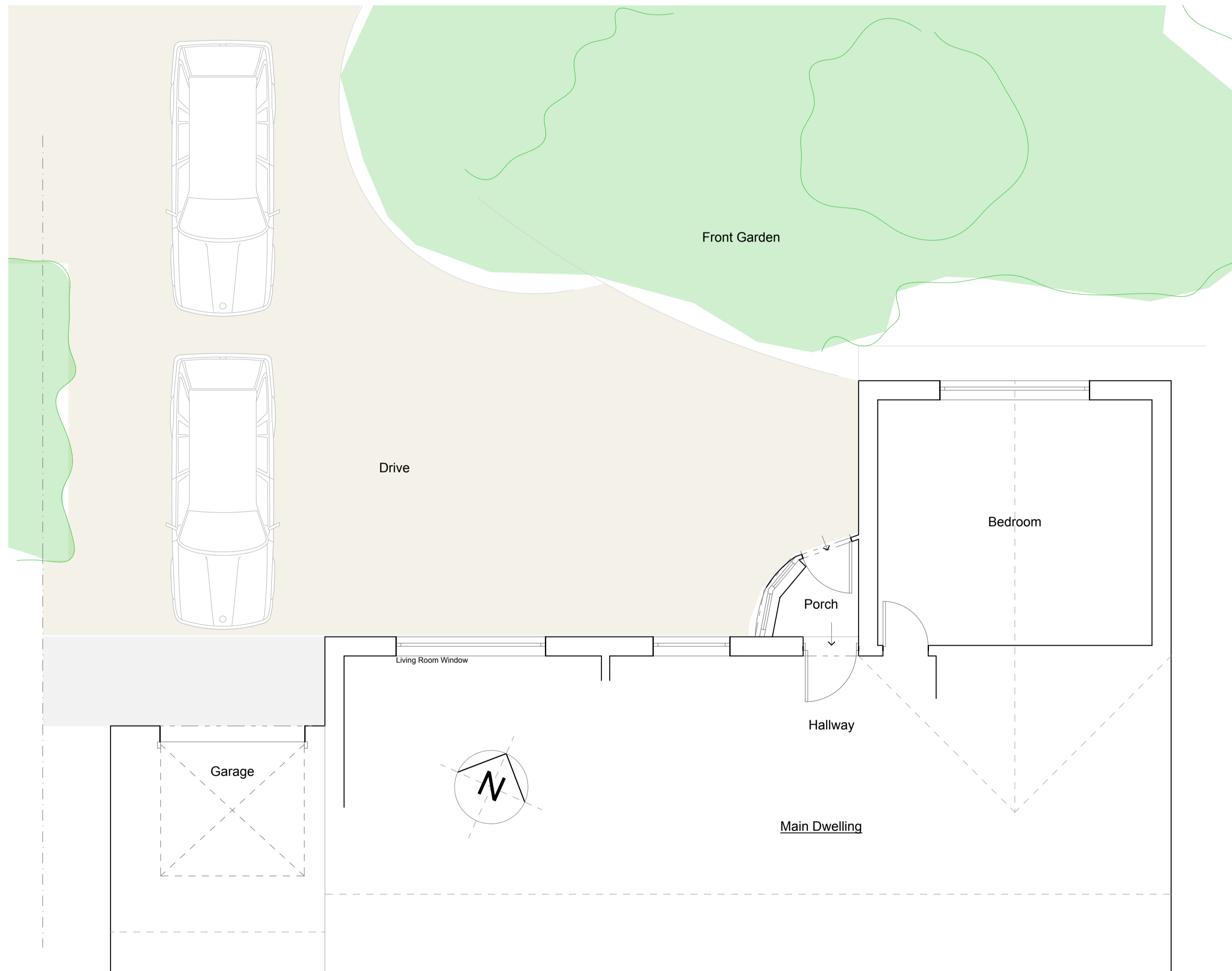

Front Elevation (North) - Existing
scale 1:50



Side Elevation (West) - Existing
scale 1:50



Partial Ground Floor Plan - Existing
scale 1:50

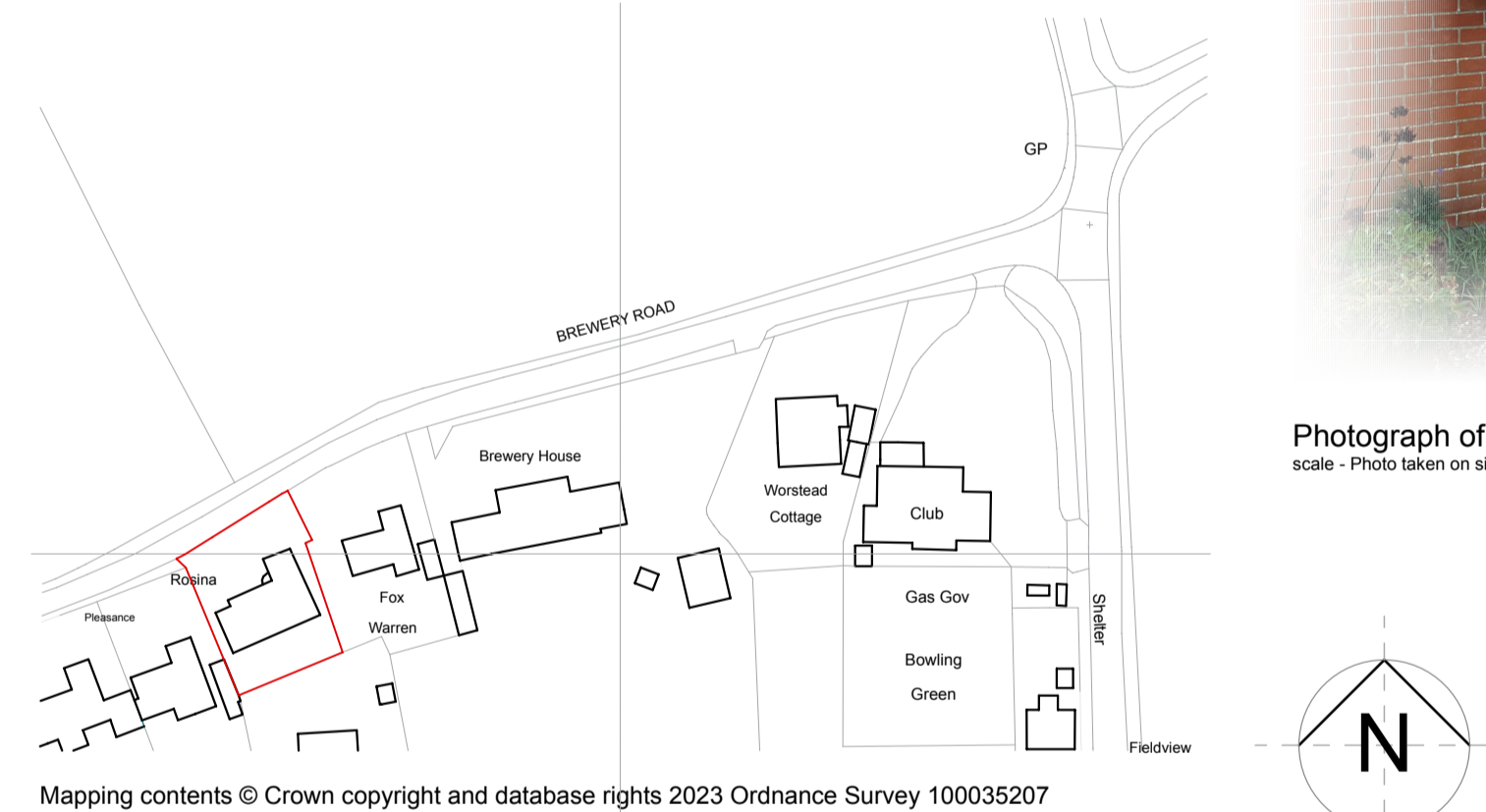

Location Plan - Existing
scale 1:1250



Site Plan - Existing
scale 1:500



Photograph of Porch - Existing
scale - Photo taken on site.

EXISTING DRAWING EX01

Note: Drawing not to be scaled. Contact Sterne Design for any additional dimensions needed.
Note: Contractor to check all dimensions and levels on site before any works are commenced. Report back any queries or discrepancies immediately. If found, Drawing is not for construction purposes and for planning purposes only.

Amendments:

Job Title: Proposed single-storey porch extension to Rosina, Brewery Road, Trunch, Norfolk, NR29 9PU.

Client: Mr & Mrs Raymond
Drawing Title: Existing Drawing EX01 @ A1

STERNE
DESIGN
Architecture | Design | Studio

Drawn: Luke Sterne
Job no. 23/197/45
Date: 11.12.2023
Drawing no. EX01
Rev.

