



**EXISTING SECTION A-A**  
scale 1:100



**PROPOSED SECTION A-A**  
scale 1:100



**EXISTING SECTION B-B**  
scale 1:100

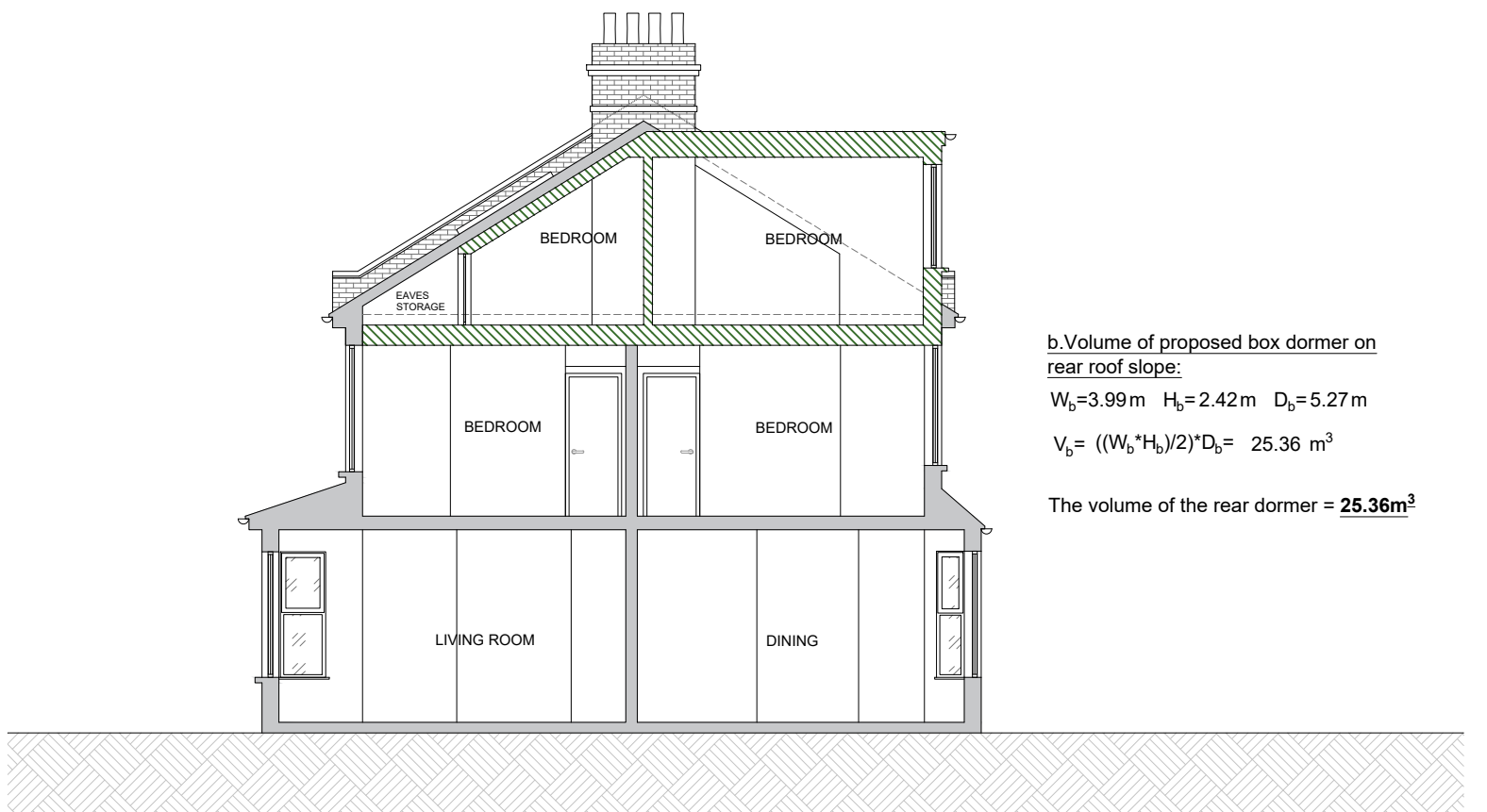

**PROPOSED SECTION B-B**  
scale 1:100

b. Volume of proposed box dormer on rear roof slope:  
 $W_b=3.99\text{ m}$   $H_b=2.42\text{ m}$   $D_b=5.27\text{ m}$   
 $V_b = ((W_b * H_b) / 2) * D_b = 25.36\text{ m}^3$   
 The volume of the rear dormer = **25.36m<sup>3</sup>**



**F-Line Designs**  
 12 Berghem Mews,  
 Blythe Road, London  
 United Kingdom  
 W14 0HN  
 planning@flinedesigns.com  
 020 364 268 00

- GENERAL NOTES**
- All dimensions must be checked on site before any works commencement.
  - All discrepancies must be reported to the Main Architect before works proceed.
  - Only figured dimensions are to be used.
  - Any conflict of given data on the drawing(s) with site condition to be discussed with the Architect.
  - The General Contractor and/or all Sub-contractors working according these drawings and specifications to contact the architect or representative if any measurements do not appear correct or unclear, add up properly or scale correctly to the indicated size upon approvals.

- STRUCTURAL NOTES**
- All drawings to be read in conjunction with structural engineer's drawings and specifications.
  - All Structural Elements Spans must be measured on site before ordering.
  - This drawing must be read in conjunction with the Structural Engineer's Drawings, Calculations and other details.
  - Accurate site dimensions are to be taken by the contractor on site prior to any construction commencing.

**PROJECT**  
 LOFT CONVERSION

**PROPERTY ADDRESS**  
 100 SHAKESPEARE CRES  
 E12 6LP

**TITLE**  
 EXISTING & PROPOSED SECTION  
 DWG REF **FL204** | TAB **A307.2**

REV	DATE	DATE	DATE
28/11 00	06/12/2023		
01/12 01	SV		
04/12 02	DW		
06/12 02	SCALE	1:100 / A3	