

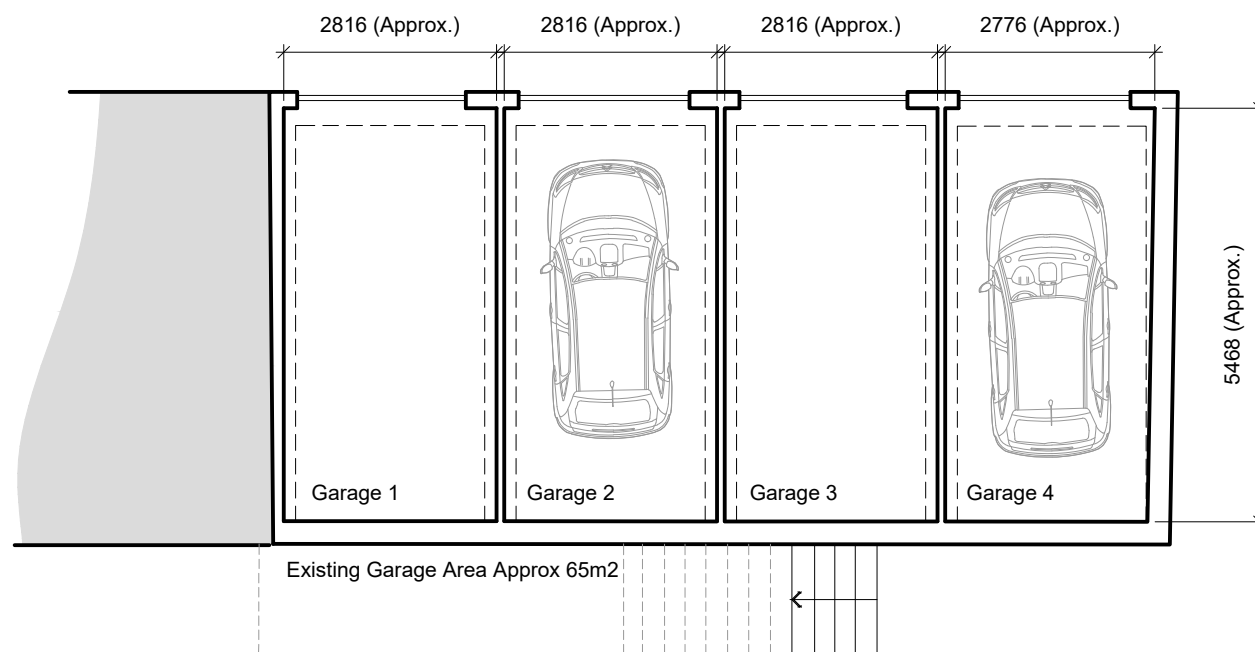

Example of Proposed Cycle Storage Locker



Existing Ground Floor Plan

1:100

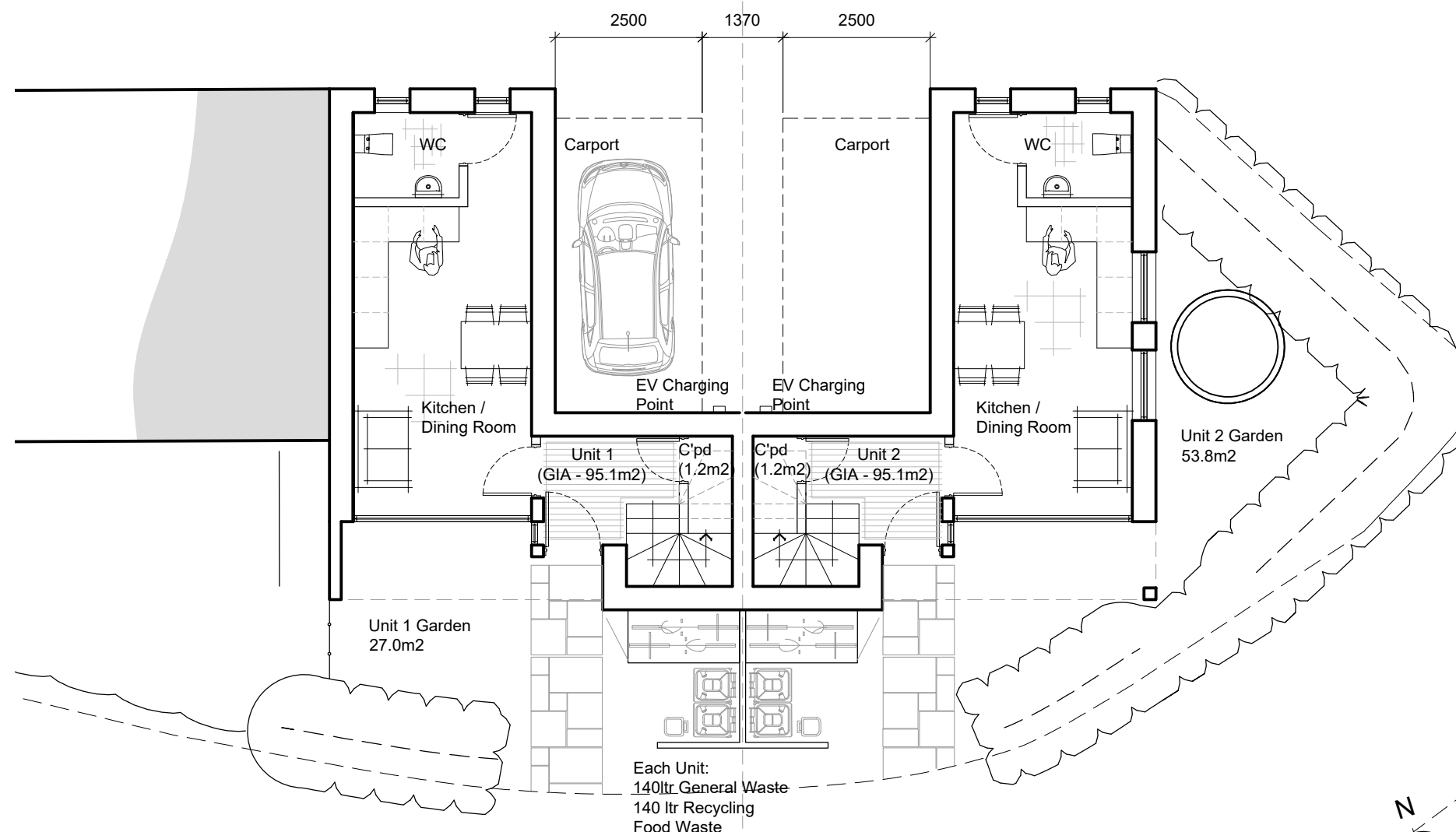

Proposed Ground Floor Plan

1:100



Proposed Residential Development  
19 Hertford Court, Enfield, N13 4DD  
Existing and Proposed  
Ground Floor Plan

Project Name: Drawing Name:

A3

NOTE:

Do Not Scale.  
Report all discrepancies, errors and omissions.  
Verify all dimensions on site before commencing any work on site or preparing shop drawings.  
All materials, components and workmanship are to comply with the relevant British & European Standards, Codes of Practice, and appropriate manufacturers recommendations that from time to time shall apply.  
For all specialist work, see relevant drawings. This drawing is copyright of Urban & Rural Ltd. Urban & Rural LTD is a registered company in England and Wales with company number 9387736.

Revision:	date	note
26.06.23		P1 - Issued in draft for initial comments
12.07.23		P2 - Updated following receipt of survey information
31.07.23		P3 - Updated following comments from planning consultant
10.08.23		P4 - Updated following comments from planning consultant

Drawing No:	A1649-10
Revision:	P4
Date:	June 23
Scale:	1:100@A3
PLANNING	