

**Notes:**

The original of this drawing was produced in colour - a monochrome copy should not be relied upon.

Do not scale from this drawing.

Tree locations were plotted by .

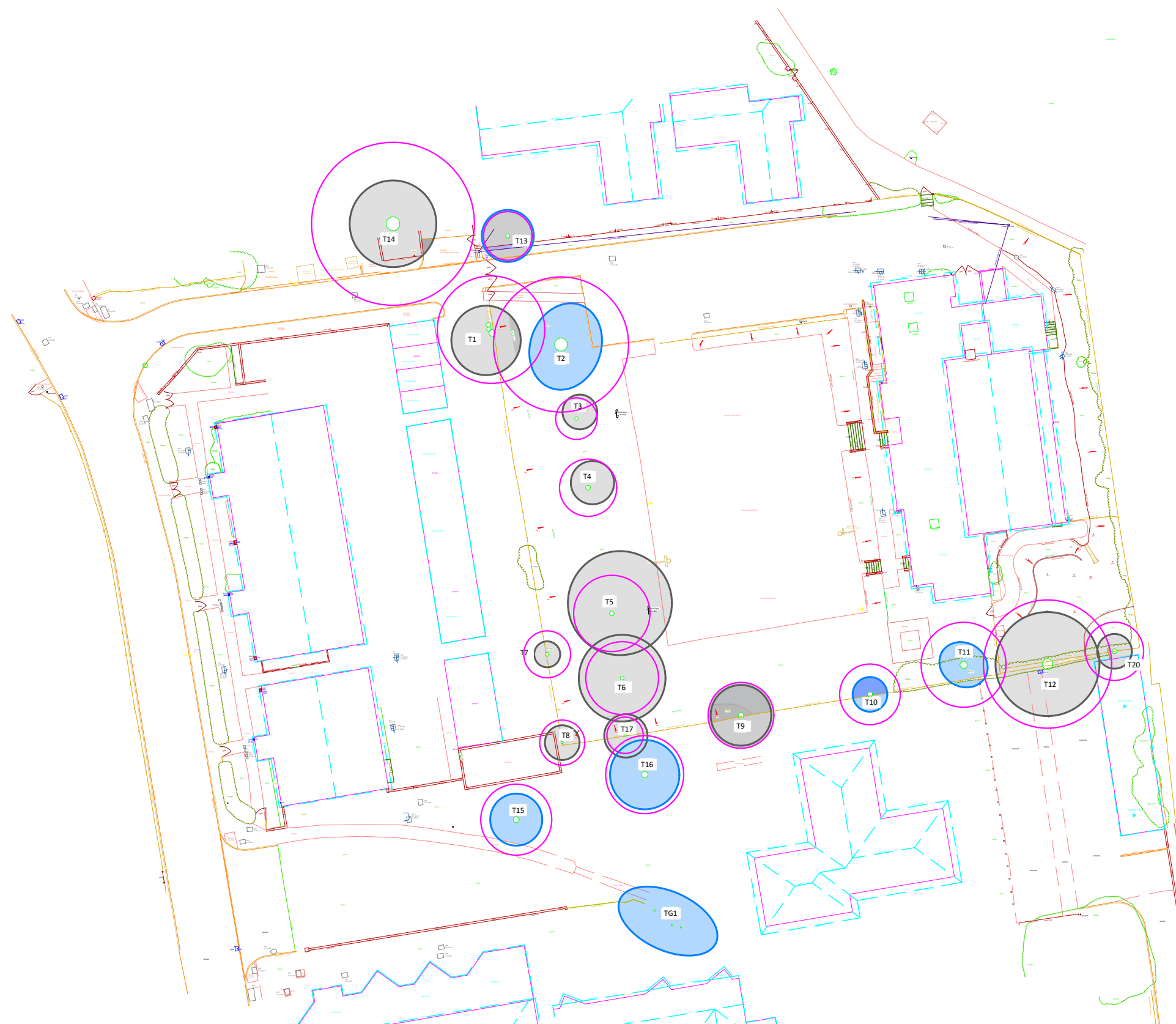
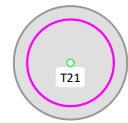

**MWA Key**

● T2	● T2	● T2	● T2	● T2	● T2
Tree No. & Stem Location	Category 'B' Tree	Category 'C' Tree	Root Protection Area	Tree Protection Fencing	No Dig Installation
Ground Protection	Manual Excavation	Proposed Build	H1	Trees to be Removed	

**Tree Categories**

Trees have been assigned a category in accordance with Table 1 of BS 5837:2012 'Trees in Relation to Design, Demolition and Construction'. The category is shown by the colour of the canopy edge (and canopy hatch where present).

- Category 'A' - Tree of high quality and value - Green
- Category 'B' - Tree of moderate quality and value - Blue
- Category 'C' - Tree of low quality and value - Grey
- Category 'U' - Tree of significantly reduced potential - Dark Red