

Notes:
 The original of this drawing was produced in colour - a monochrome copy should not be relied upon.
 Do not scale from this drawing.
 Tree locations were plotted by SE Surveying on the supplied Topographical Survey.

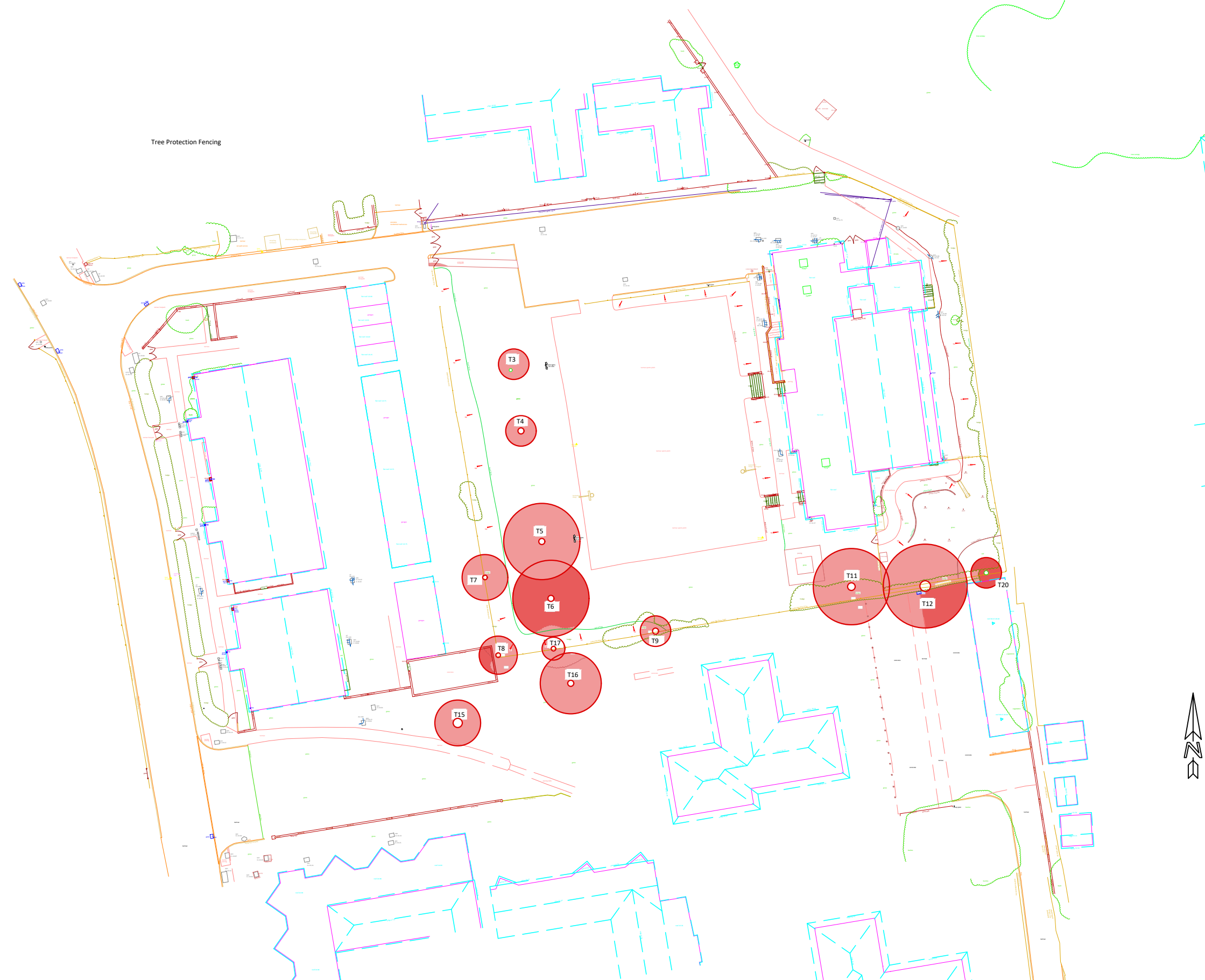

MWA Key

● T2	●	●	○	○	■
Tree No. & Stem Location	Category 'B' Tree	Category 'C' Tree	Root Protection Area	Tree Protection Fencing	No Dig Installation
■	■	■		T6	
Ground Protection	Manual Excavation	Proposed Build		Trees to be Removed	

Tree Categories

Trees have been assigned a category in accordance with Table 1 of BS 5837:2012 'Trees in Relation to Design, Demolition and Construction'. The category is shown by the colour of the canopy edge (and canopy hatch where present).

Categories are shown as below:

- Category 'A' - Tree of high quality and value - Green
- Category 'B' - Tree of moderate quality and value - Blue
- Category 'C' - Tree of low quality and value - Grey
- Category 'U' - Tree of significantly reduced potential - Dark Red