

Granville Ave

Front Street

Railway Villa

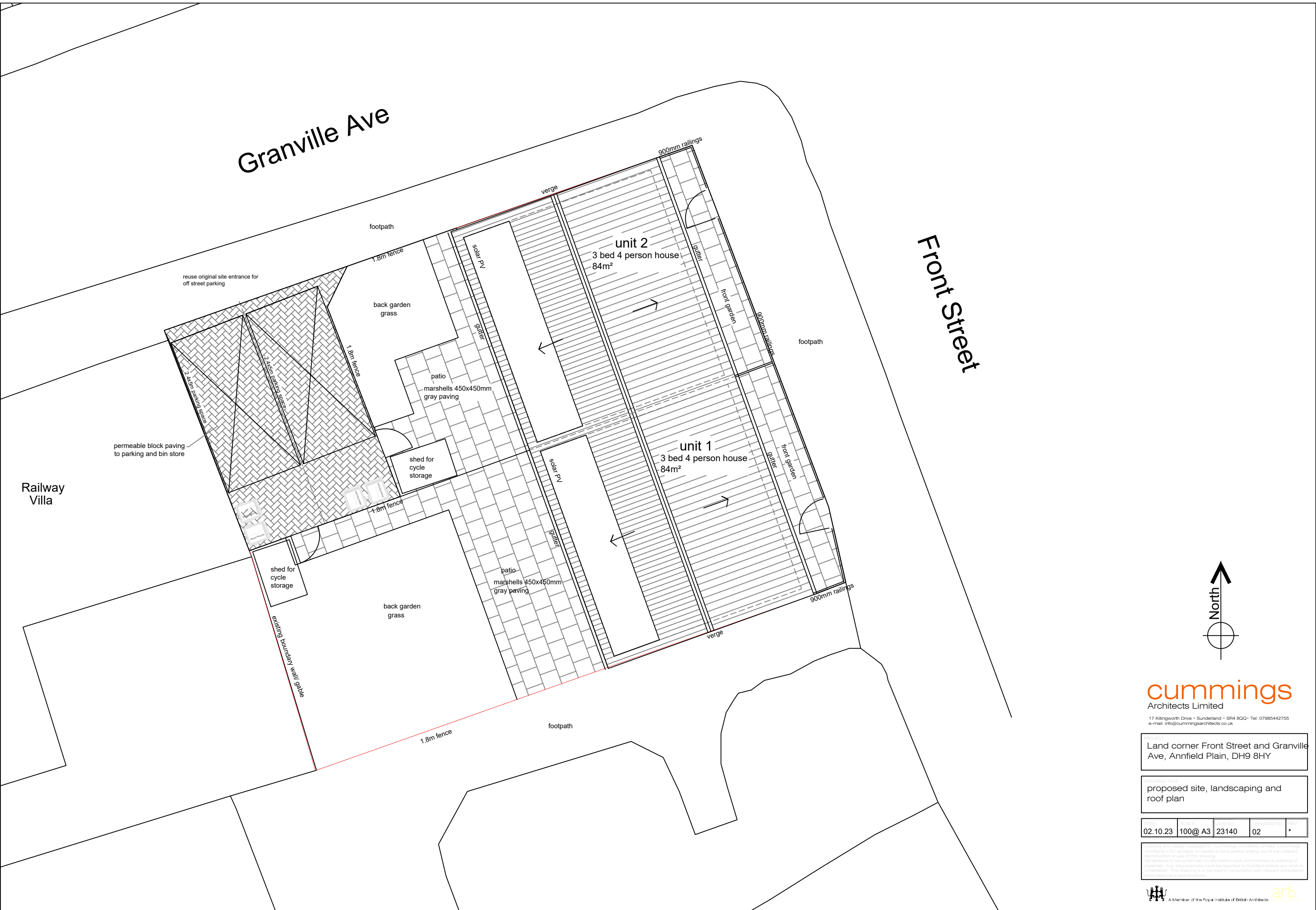

cummings
Architects Limited

17 Killingworth Drive • Sunderland • SR4 8QQ • Tel: 07985442755
e-mail: info@cummingsarchitects.co.uk

Land corner Front Street and Granville Ave, Annfield Plain, DH9 8HY

proposed site, landscaping and roof plan

DATE	SCALE	JOB NO	DISCIPLINE	REV
02.10.23	100@ A3	23140	02	*

This drawing is the property of Cummings Architects Limited. Cummings Architects Limited, accepts no liability to third parties arising out of the unlawful reproduction or use of this drawing. Dimensions to be confirmed on site before work commences & ordering of materials. Any discrepancies must be reported to Architects before any work is undertaken. This drawing is to be read in conjunction with relevant consultants information and specifications.

