

THIS DRAWING IS COPYRIGHT, AND REMAINS THE PROPERTY OF HTC ARCHITECTS. IT MUST NOT BE REPRODUCED, USED, DISCLOSED OR TRANSMITTED TO THIRD PARTIES IN ANY FORM, IN WHOLE OR IN PART, WITHOUT PRIOR WRITTEN PERMISSION.

ALL DIMENSIONS SHOULD BE CHECKED ON SITE BEFORE WORK COMMENCES

SUBJECT TO ADDITIONAL SURVEY

BASED ON LIDL 2020.2 ECO SPECIFICATION WHERE POSSIBLE

SUBJECT TO LEVEL CONFIRMATION FROM ENGINEERS

SUBJECT TO TREE SURVEY

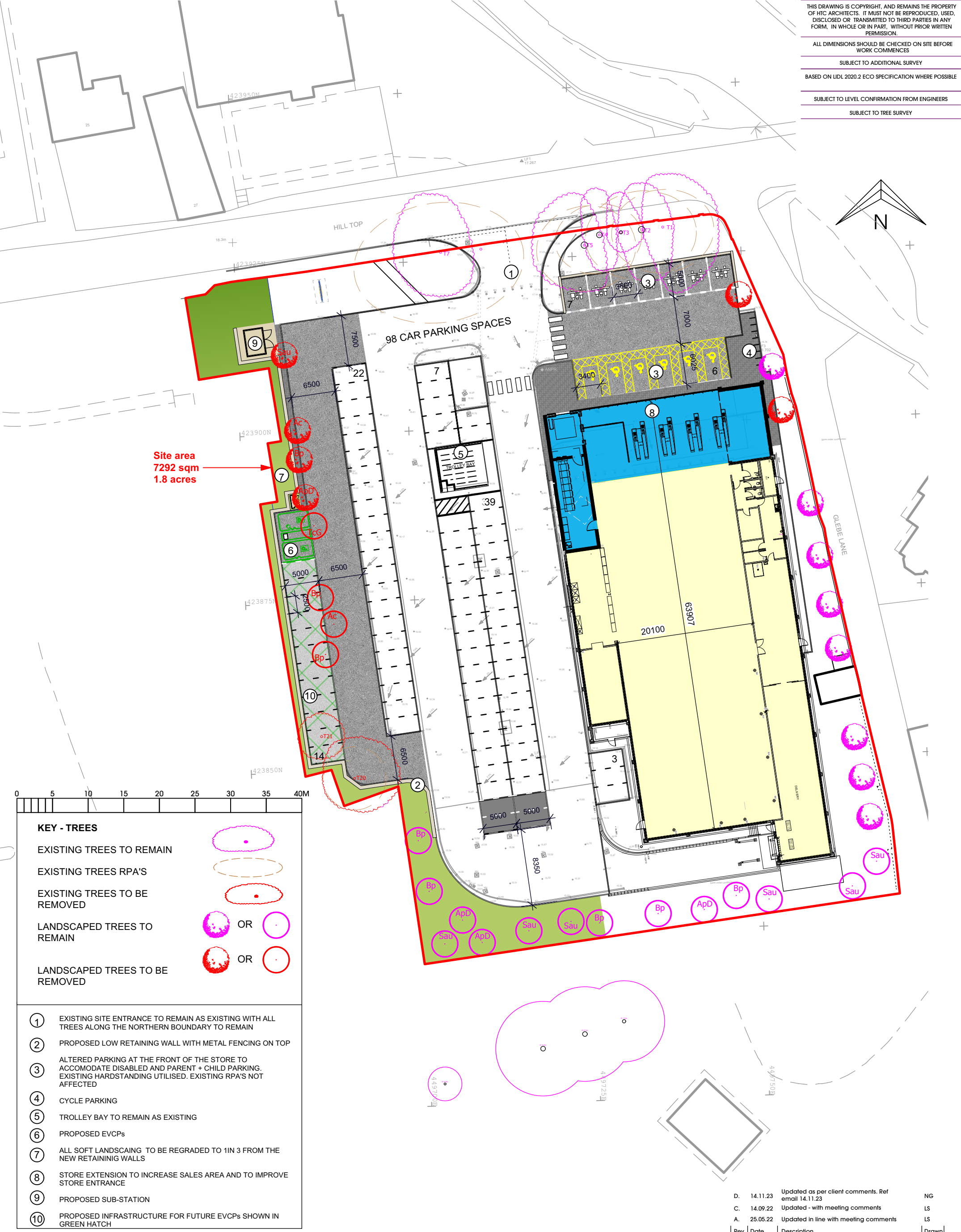

KEY - TREES

- EXISTING TREES TO REMAIN
- EXISTING TREES RPA'S
- EXISTING TREES TO BE REMOVED
- LANDSCAPED TREES TO REMAIN OR
- LANDSCAPED TREES TO BE REMOVED OR

- ① EXISTING SITE ENTRANCE TO REMAIN AS EXISTING WITH ALL TREES ALONG THE NORTHERN BOUNDARY TO REMAIN
- ② PROPOSED LOW RETAINING WALL WITH METAL FENCING ON TOP
- ③ ALTERED PARKING AT THE FRONT OF THE STORE TO ACCOMODATE DISABLED AND PARENT + CHILD PARKING. EXISTING HARDSTANDING UTILISED. EXISTING RPA'S NOT AFFECTED
- ④ CYCLE PARKING
- ⑤ TROLLEY BAY TO REMAIN AS EXISTING
- ⑥ PROPOSED EVCPs
- ⑦ ALL SOFT LANDSCAING TO BE REGRADED TO 1IN 3 FROM THE NEW RETAINING WALLS
- ⑧ STORE EXTENSION TO INCREASE SALES AREA AND TO IMPROVE STORE ENTRANCE
- ⑨ PROPOSED SUB-STATION
- ⑩ PROPOSED INFRASTRUCTURE FOR FUTURE EVCPs SHOWN IN GREEN HATCH

Rev.	Date	Description	Drawn
D.	14.11.23	Updated as per client comments. Ref email 14.11.23	NG
C.	14.09.22	Updated - with meeting comments	LS
A.	25.05.22	Updated in line with meeting comments	LS



client
 project
 Lidl Extension
 Hill Top, Knottingley
 drawing title
 GA Proposed Site Plan

date September 2021
 status Planning
 scale 1:500 @ A3
 drawn BM checked LS/PH
 job no. 2587 dwg no. P401 rev. D

htcarchitects
 York Place Studio
 8 Britannia Street
 Leeds
 LS1 2DZ
 T:(0113) 244 3457
 W: www.htcarchitects.co.uk
 E: info@htcarchitects.co.uk