

THIS DRAWING IS COPYRIGHT, AND REMAINS THE PROPERTY OF HTC ARCHITECTS. IT MUST NOT BE REPRODUCED, USED, DISCLOSED OR TRANSMITTED TO THIRD PARTIES IN ANY FORM, IN WHOLE OR IN PART, WITHOUT PRIOR WRITTEN PERMISSION.

ALL DIMENSIONS SHOULD BE CHECKED ON SITE BEFORE WORK COMMENCES

SUBJECT TO ADDITIONAL SURVEY

BASED ON LIDL 2020.2 ECO SPECIFICATION WHERE POSSIBLE

SUBJECT TO LEVEL CONFIRMATION FROM ENGINEERS

SUBJECT TO TREE SURVEY

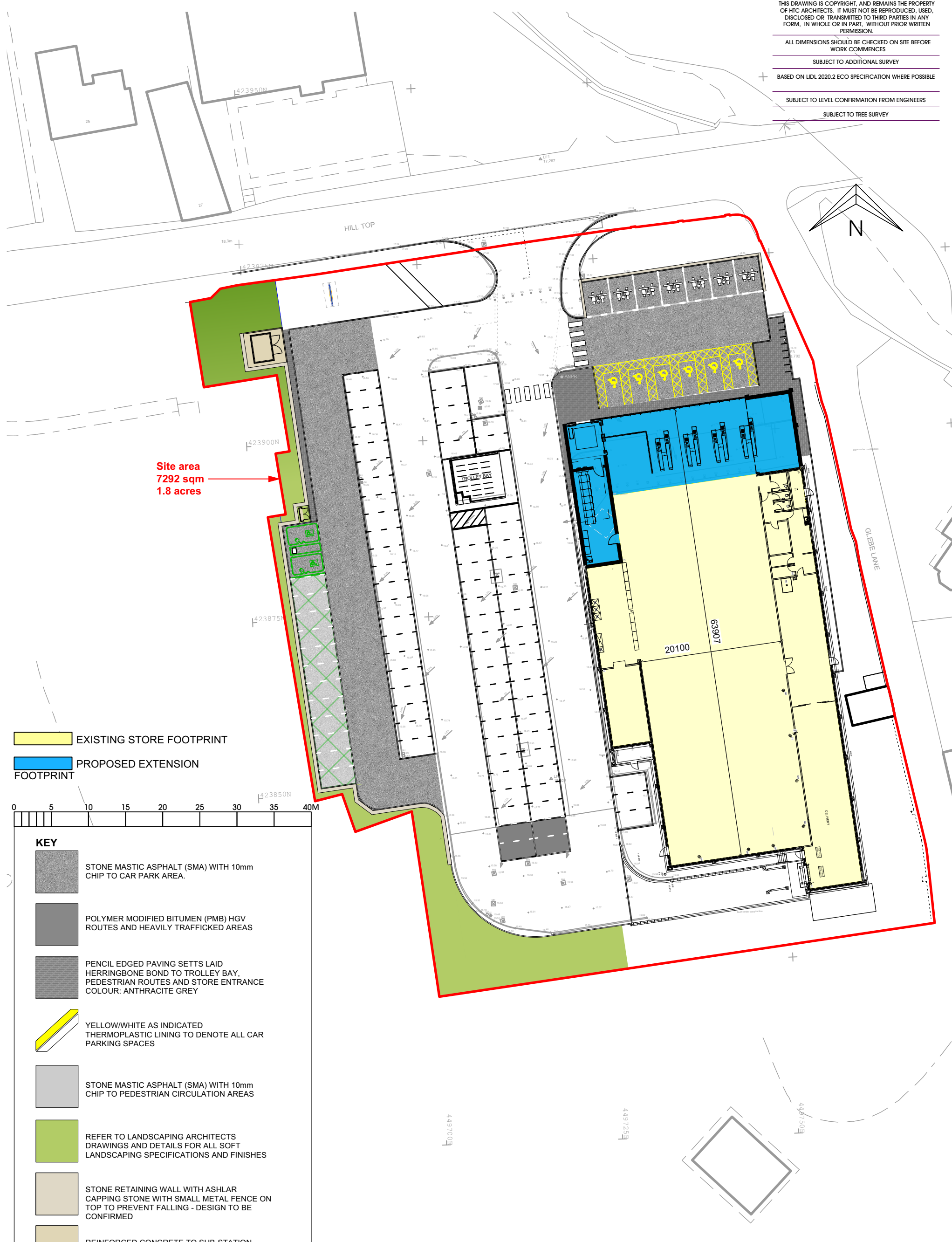







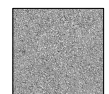

Site area
7292 sqm
1.8 acres

EXISTING STORE FOOTPRINT
PROPOSED EXTENSION FOOTPRINT

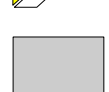
0 5 10 15 20 25 30 35 40M

KEY

-  STONE MASTIC ASPHALT (SMA) WITH 10mm CHIP TO CAR PARK AREA.
-  POLYMER MODIFIED BITUMEN (PMB) HGV ROUTES AND HEAVILY TRAFFICKED AREAS
-  PENCIL EDGED PAVING SETTS LAID HERRINGBONE BOND TO TROLLEY BAY, PEDESTRIAN ROUTES AND STORE ENTRANCE COLOUR: ANTHRACITE GREY
-  YELLOW/WHITE AS INDICATED THERMOPLASTIC LINING TO DENOTE ALL CAR PARKING SPACES
-  STONE MASTIC ASPHALT (SMA) WITH 10mm CHIP TO PEDESTRIAN CIRCULATION AREAS
-  REFER TO LANDSCAPING ARCHITECTS DRAWINGS AND DETAILS FOR ALL SOFT LANDSCAPING SPECIFICATIONS AND FINISHES
-  STONE RETAINING WALL WITH ASHLAR CAPPING STONE WITH SMALL METAL FENCE ON TOP TO PREVENT FALLING - DESIGN TO BE CONFIRMED
-  REINFORCED CONCRETE TO SUB-STATION BASE

A	14.11.23	Surface Treatment Updated	NG
Rev.	Date	Description	Drawn

client



project
Lidl Extension
Hill Top, Knottingley

drawing title
Proposed Surfacing Treatments
Site Plan

date September 2021
status Planning
scale 1:500 @ A3
drawn BM checked LS/PH
job no. 2587 dwg no. P405 rev. A

htcarchitects

York Place Studio
8 Britannia Street
Leeds
LS1 2DZ

T:(0113) 244 3457

W: www.htcarchitects.co.uk
E: info@htcarchitects.co.uk