

**HEAT PUMP SCHEDULE (OUTDOOR)**

REF	LOCATION	MANUFACTURER	MODEL	MAX CURRENT (A)	ELECTRICAL DETAILS (V/Ph/Hz)	dBA NOM / NIGHT QUIET	WEIGHT (kg)	COMMENTS
CU 01	EXTERNAL PLANT AREA	DAIKIN	RZAG140NY1	15	400/3/50	52 / 48	95	TO BE FITTED WITH ACOUSTIC ENCLOSURE TO REDUCE FIGURES STATED IN PREVIOUS COLUMN
CU 02	EXTERNAL PLANT AREA	DAIKIN	RZAG140NY1	15	400/3/50	52 / 48	95	TO BE FITTED WITH ACOUSTIC ENCLOSURE TO REDUCE FIGURES STATED IN PREVIOUS COLUMN

**GENERAL NOTES**

- THIS DRAWING SHALL BE READ IN CONJUNCTION WITH ALL ASSOCIATED SERVICES DRAWINGS, ARCHITECTS AND STRUCTURAL DRAWINGS TOGETHER WITH THE SCHEMATIC DRAWINGS AND ALL MECHANICAL, ELECTRICAL AND OTHER RELEVANT SPECIFICATIONS.
- ALL SERVICES INSTALLATIONS SHALL BE CO-ORDINATED AND FULLY INTEGRATED WITH THE MECHANICAL AND ELECTRICAL SERVICES, ARCHITECTURAL FEATURES, SPECIALIST PLANT AND STRUCTURAL ELEMENTS.
- THE SERVICES CONTRACTORS SHALL FAMILIARISE THEMSELVES WITH THE MECHANICAL AND ELECTRICAL SERVICES, ARCHITECTURAL FEATURES, SPECIALIST PLANT AND STRUCTURAL ELEMENTS.
- THE INSTALLING SUB-CONTRACTOR SHALL ISSUE FULL 'WORKING DRAWINGS' IN LINE WITH THE SPECIFICATION PROVIDED. THE 'WORKING DRAWINGS' SHALL BE ISSUED TO ALL DESIGN TEAM MEMBERS FOR THEIR COMMENT PRIOR TO INSTALLATION. THE INSTALLATION AND CO-ORDINATION OF SERVICES WITH OTHER SERVICES, THIRD PARTY SUPPLIERS AND THE BUILDING FABRIC IS THE RESPONSIBILITY OF THE INSTALLING SUB-CONTRACTOR.
- ALL PLANT INDICATED ON THIS DRAWING IS FOR PLANNING PURPOSED ONLY. THE CONTRACTOR SHALL DESIGN AND SELECT PLANT IN ACCORDANCE WITH THE ASDA DESIGN GUIDE SUITABLE FOR THIS STORE IN PARTICULAR TAKING IN TO ACCOUNT THE NOISE PROPOSALS CONTAINED WITHIN THIS DRAWING

This drawing is the property of DDA Ltd Consultant Engineers. It must not be reproduced in whole or in part, nor the design used without prior written consent. This drawing and associated documents are strictly private and confidential and should not be discussed with anyone other than members of the design team. Do not scale from this drawing.

**SAFETY, HEALTH & ENVIRONMENTAL INFORMATION**

Refer to the DDA Ltd project specific risk assessment and design criteria for the M&E services installation. The installing contractor must prepare method statements for the installation works and agree all works in advance with the main contractor.



**BEACON 4 COMPRESSOR INTERNAL PACK**  
DO NOT SCALE

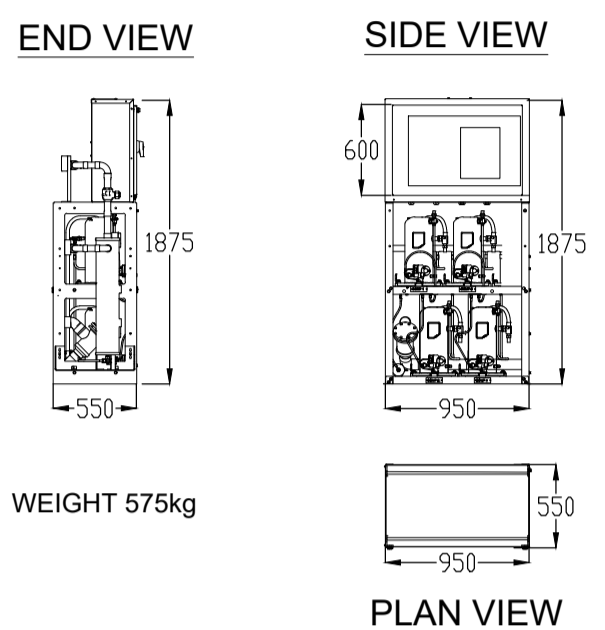

FINAL SELECTIONS TO BE CONFIRMED WITH CBES, DUAL TEMP REQUIRED TO ACCOMMODATE COLDROOMS ON PAK

**5 HVAC CONDENSERS ENCLOSURE IMAGE NTS**

**3 INTERNAL REFRIGERATION PACK DETAILS NTS**

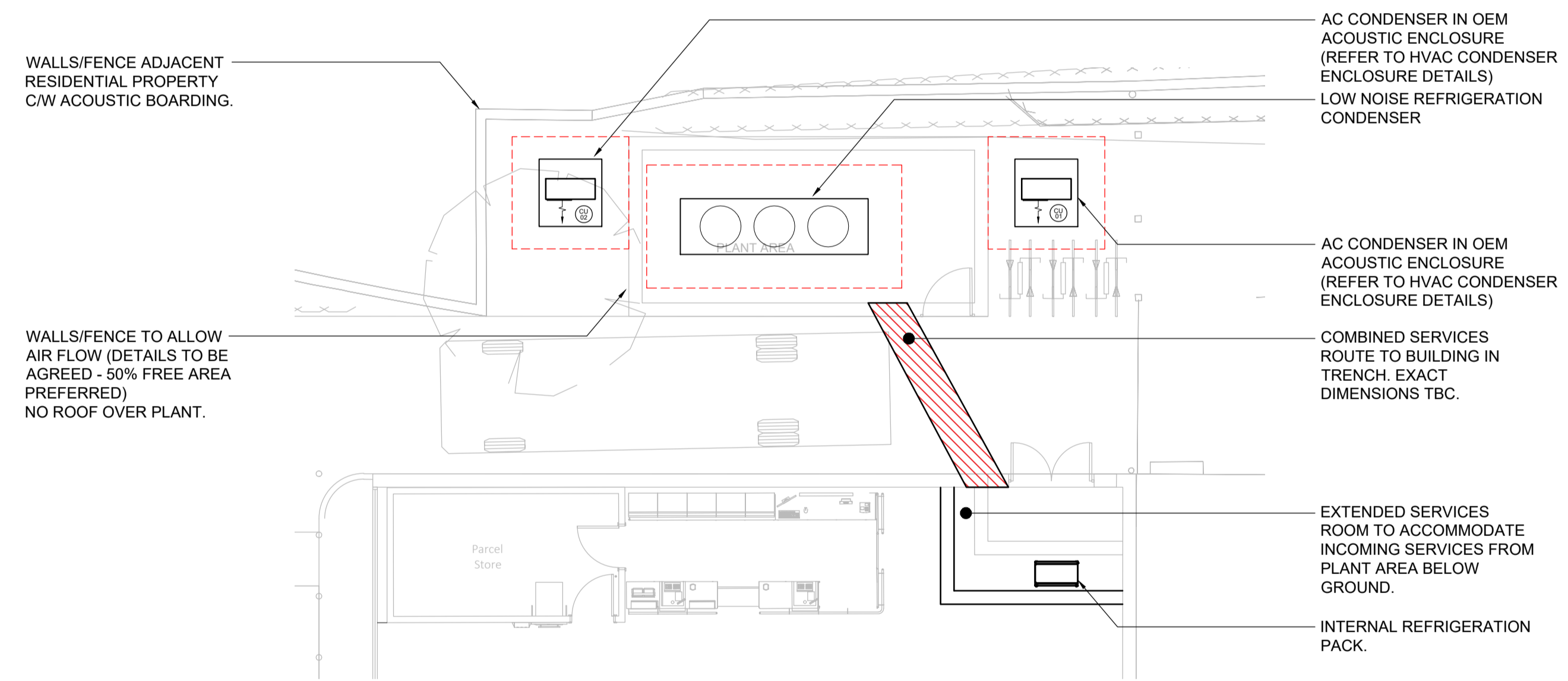
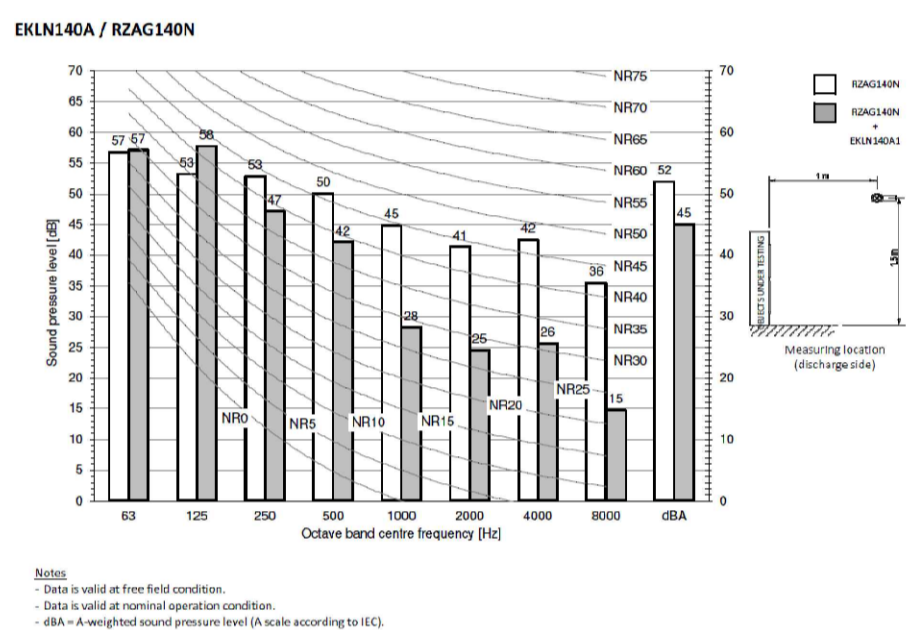

**1 PROPOSED PLANT LAYOUT - NORTH OF SITE 1:100**

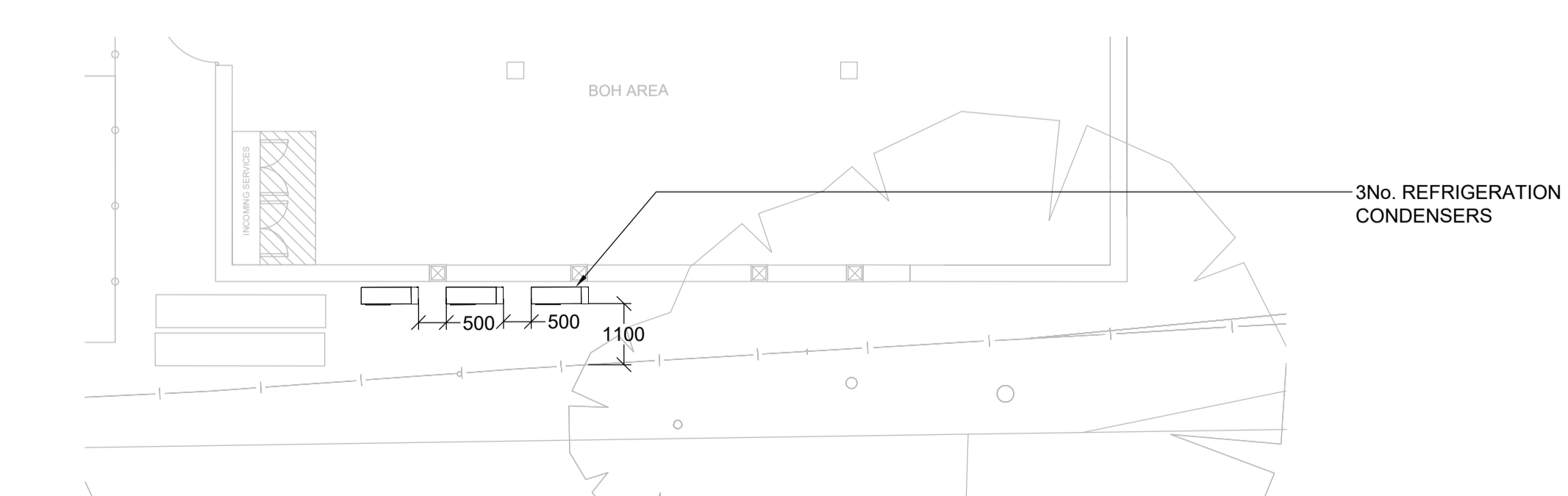

**1 PROPOSED PLANT LAYOUT - SOUTH OF SITE 1:100**

REF	DESCRIPTION	QTY	UNIT	PRICE	TOTAL
1	DAIKIN RZAG140NY1	2	UNIT	15000	30000
2	DAIKIN RZAG140NY1	2	UNIT	15000	30000
3	DAIKIN RZAG140NY1	2	UNIT	15000	30000
4	DAIKIN RZAG140NY1	2	UNIT	15000	30000
5	DAIKIN RZAG140NY1	2	UNIT	15000	30000
6	DAIKIN RZAG140NY1	2	UNIT	15000	30000
7	DAIKIN RZAG140NY1	2	UNIT	15000	30000
8	DAIKIN RZAG140NY1	2	UNIT	15000	30000
9	DAIKIN RZAG140NY1	2	UNIT	15000	30000
10	DAIKIN RZAG140NY1	2	UNIT	15000	30000
11	DAIKIN RZAG140NY1	2	UNIT	15000	30000
12	DAIKIN RZAG140NY1	2	UNIT	15000	30000
13	DAIKIN RZAG140NY1	2	UNIT	15000	30000
14	DAIKIN RZAG140NY1	2	UNIT	15000	30000
15	DAIKIN RZAG140NY1	2	UNIT	15000	30000
16	DAIKIN RZAG140NY1	2	UNIT	15000	30000
17	DAIKIN RZAG140NY1	2	UNIT	15000	30000
18	DAIKIN RZAG140NY1	2	UNIT	15000	30000
19	DAIKIN RZAG140NY1	2	UNIT	15000	30000
20	DAIKIN RZAG140NY1	2	UNIT	15000	30000

REF	DESCRIPTION	QTY	UNIT	PRICE	TOTAL
1	DAIKIN RZAG140NY1	2	UNIT	15000	30000
2	DAIKIN RZAG140NY1	2	UNIT	15000	30000
3	DAIKIN RZAG140NY1	2	UNIT	15000	30000
4	DAIKIN RZAG140NY1	2	UNIT	15000	30000
5	DAIKIN RZAG140NY1	2	UNIT	15000	30000
6	DAIKIN RZAG140NY1	2	UNIT	15000	30000
7	DAIKIN RZAG140NY1	2	UNIT	15000	30000
8	DAIKIN RZAG140NY1	2	UNIT	15000	30000
9	DAIKIN RZAG140NY1	2	UNIT	15000	30000
10	DAIKIN RZAG140NY1	2	UNIT	15000	30000
11	DAIKIN RZAG140NY1	2	UNIT	15000	30000
12	DAIKIN RZAG140NY1	2	UNIT	15000	30000
13	DAIKIN RZAG140NY1	2	UNIT	15000	30000
14	DAIKIN RZAG140NY1	2	UNIT	15000	30000
15	DAIKIN RZAG140NY1	2	UNIT	15000	30000
16	DAIKIN RZAG140NY1	2	UNIT	15000	30000
17	DAIKIN RZAG140NY1	2	UNIT	15000	30000
18	DAIKIN RZAG140NY1	2	UNIT	15000	30000
19	DAIKIN RZAG140NY1	2	UNIT	15000	30000
20	DAIKIN RZAG140NY1	2	UNIT	15000	30000

**2 REFRIGERATION CONDENSER DETAILS NTS**

**4 HVAC CONDENSER ENCLOSURE DETAILS NTS**

**KELVION CONDENSER RV-MF103L2X-091L227**

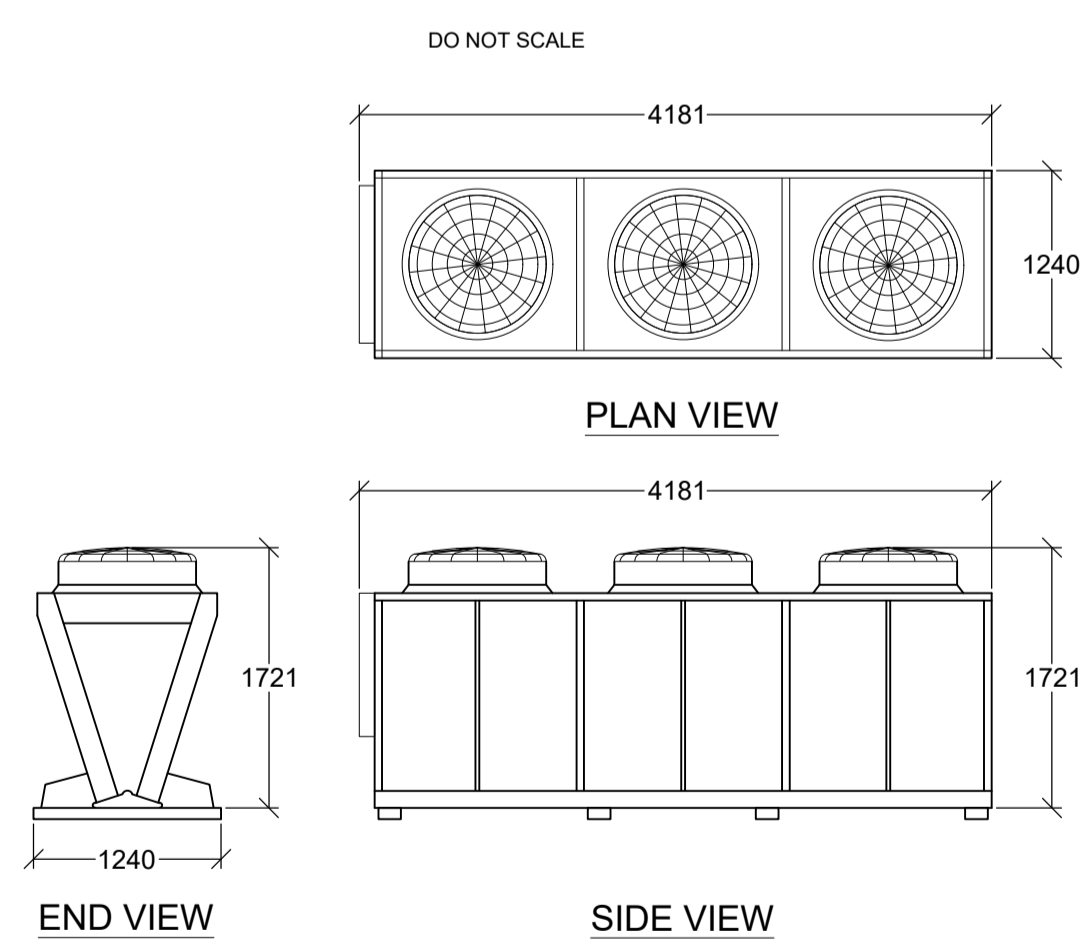

MODEL	MANUFACTURER	WIDTH (mm)	HEIGHT (mm)	LENGTH (mm)	WEIGHT (kg)	SOUND POWER (dBA)	SOUND PRESSURE (dBA)
RV-MF103L2X-091L227	KELVION	1240	1721	4181	714	52	20 @ 10m

**2 REFRIGERATION CONDENSER DETAILS NTS**

Rev	Date	Description	Eng
A	05/09/23	SALES FLOOR REFRIGERATION PACK MOVED INSIDE. LOW NOISE REFRIGERATION CONDENSER ADDED TO PLANT AREA.	J.B.
-	14/03/23	INITIAL ISSUE	J.B.

**DDA**  
Building Services | Consultant Engineers

Dave Dickinson & Associates Ltd.  
RCM Business Centre,  
Sandbush Trading Estate,  
Dewsbury Road, Coslett,  
West Yorkshire WF5 9ND

01924 265757  
01924 273117  
info@ddaltd.co.uk  
www.ddaltd.co.uk

**ASDA**  
Save money. Live better.

Client  
**ASDA**

Project  
**PUCKERIDGE, CAMBRIDGE ROAD, EXPRESS STORE**

Drawing Title  
**PROPOSED EXTERNAL PLANT LAYOUT**

Scale at A1	Date
AS NOTED	14/03/2023
Drawn	Engineer
A. GREENWOOD	N. PHILLIPS
Status	Checked
PLANNING	N. PHILLIPS
Drawing No.	Rev
23/4211/M50-0001	A