

Floor Plan
1:20

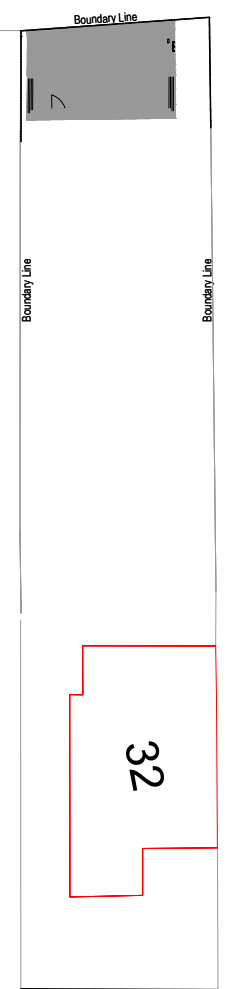

Site Plan- 1:20

- GENERAL NOTES:
1. All Dimensions are in millimetres unless otherwise stated.
 2. All work to be carried out in accordance with current building regulations, and all relevant British standards/codes of practice.
 3. The Contractor is responsible for the correct setting out of the works on site, all dimensions to be checked prior to fabrication of materials and commencement of works.
 4. This Drawing is to be read in conjunction with all relevant drawings and Specifications.
 5. Exact SVP and Boiler position to be determined onsite by contractor
 6. A "macerator toilet" would be required for a certain designs if the toilet location is away from existing SVP.
 7. Steels imbedded into ceiling may be charged additionally by your contractor
 8. All proposed materials are to be similar in appearance to that of the existing house, unless otherwise
 9. Glazing which exceeds 25% of the added floor area will result in extra charges for S.A.P Calculations
 10. Windows on a side elevation at first floor level or above must be obscured glazing and openable below 1.7m

CLIENT			
Mr & Mrs Redding			
PROJECT			
Summer House			
DRAWING TITLE			
Planning Application Summer House General Arrangement Plan			
DRAWN BY	CHECKED BY	DATE	SCALE
WS	CHECKER	27/03/2023	
PROJECT No.	DRAWING No.	REV	
-	Redding- 002		0