

THIS DRAWING IS INDICATIVE ONLY AND MUST NOT BE RELIED UPON FOR CONSTRUCTION - UNLESS THE DRAWING IS NAMED AS 'CONSTRUCTION'.





ALL DIMENSIONS TO BE CHECKED AND VERIFIED WITH ANY DISCREPANCIES REPORTED TO PHILIPS SURVEYORS LLP.

THIS DRAWING REMAINS THE PROPERTY OF PHILIPS SURVEYORS AND MUST NOT BE COPIED OR REPRODUCED WITHOUT PRIOR WRITTEN PERMISSION.

THE CLIENT MUST FAMILIARISE THEMSELVES WITH:  
 - THEIR DUTIES CONCERNING HEALTH & SAFETY UNDER CDM2015 REGULATIONS AND  
 - THE APPOINTMENT OF PRINCIPAL DESIGNER AND PRINCIPAL CONTRACTOR.

IF YOU NEED ANY FURTHER INFORMATION OR INDEPENDENT ADVICE ON UNDERTAKING YOUR CDM REGULATIONS DUTIES, PLEASE CONTACT THE ASSOCIATION FOR PROJECT SAFETY, 5 NEW MART PLACE, EDINBURGH EH4 4RW TEL: 08456 121 290 EMAIL: INFO@APS.ORG.UK YOU CAN VISIT THE HSE AND APS WEBSITES FOR MUCH MORE INFORMATION AT: [WWW.HSE.GOV.UK](http://WWW.HSE.GOV.UK) AND [WWW.APS.ORG.UK](http://WWW.APS.ORG.UK) RESPECTIVELY.

**SAFETY HEALTH AND ENVIRONMENTAL INFORMATION**  
 IN ADDITION TO THE HAZARDS AND RISKS NORMALLY ASSOCIATED WITH THE TYPE OF CONSTRUCTION WORK DETAILED ON THIS DRAWING, PLEASE NOTE THE FOLLOWING SIGNIFICANT RISKS AND INFORMATION:

-  INDICATES - WARNING
-  INDICATES - COMPULSORY INSTRUCTION
-  INDICATES - FOR INFORMATION
-  INDICATES - PROHIBITIVE INSTRUCTION

FOR INFORMATION RELATING TO END USE, MAINTENANCE, DEMOLITION ETC. - PLEASE REFER TO THE HEALTH & SAFETY FILE.  
 IT SHOULD BE ASSUMED THAT ALL WORKS ARE TO BE CARRIED OUT BY A COMPETENT CONTRACTOR AND, WHERE APPLICABLE, TO AN APPROVED METHOD STATEMENT.

**TO BE READ IN CONJUNCTION WITH MATERIALS SCHEDULE; B-CD1.**

A	UPDATE TO NOTES	04.12.23	MAB
Rev.	Amendments	Date	Drw.

**PS PHILIPS SURVEYORS**  
 BUILDING SURVEYORS, DESIGNERS & CONSULTANTS

PHILIPS SURVEYORS LLP, THE OLD COACH HOUSE, 78 LOWER STREET, PULBOROUGH, WEST SUSSEX, RH20 2AA  
 TEL: 01798 873222 FAX: 01798 873444  
 EMAIL: [INFO@PHILIPS-SURVEYORS.CO.UK](mailto:INFO@PHILIPS-SURVEYORS.CO.UK)  
[WWW.PHILIPSCHARTEREDSURVEYORS.CO.UK](http://WWW.PHILIPSCHARTEREDSURVEYORS.CO.UK)

CLIENT:  
 MR A MORE-MOLYNEUX  
 LOSELEY HOUSE, LOSELEY PARK,  
 GUILDFORD, SURREY, GU3 1HS

PROJECT:  
**REPLACEMENT OF FIRE DAMAGED BARN**  
 MELLERSH FARM, NEW POND ROAD,  
 GUILDFORD, SURREY, GU3 1HZ

DRAWING TITLE:  
**PLANNING CONDITIONS**  
 PROPOSED WINDOW & DOOR DETAILS

DRAWN: THR	JOB NO: 2503/22	SCALE @ A1: As Shown
CHECKED: PGA	DRAWING NO: B-CD4	REV: A
DATE: OCT 2023		

© PHILIPS SURVEYORS LLP.

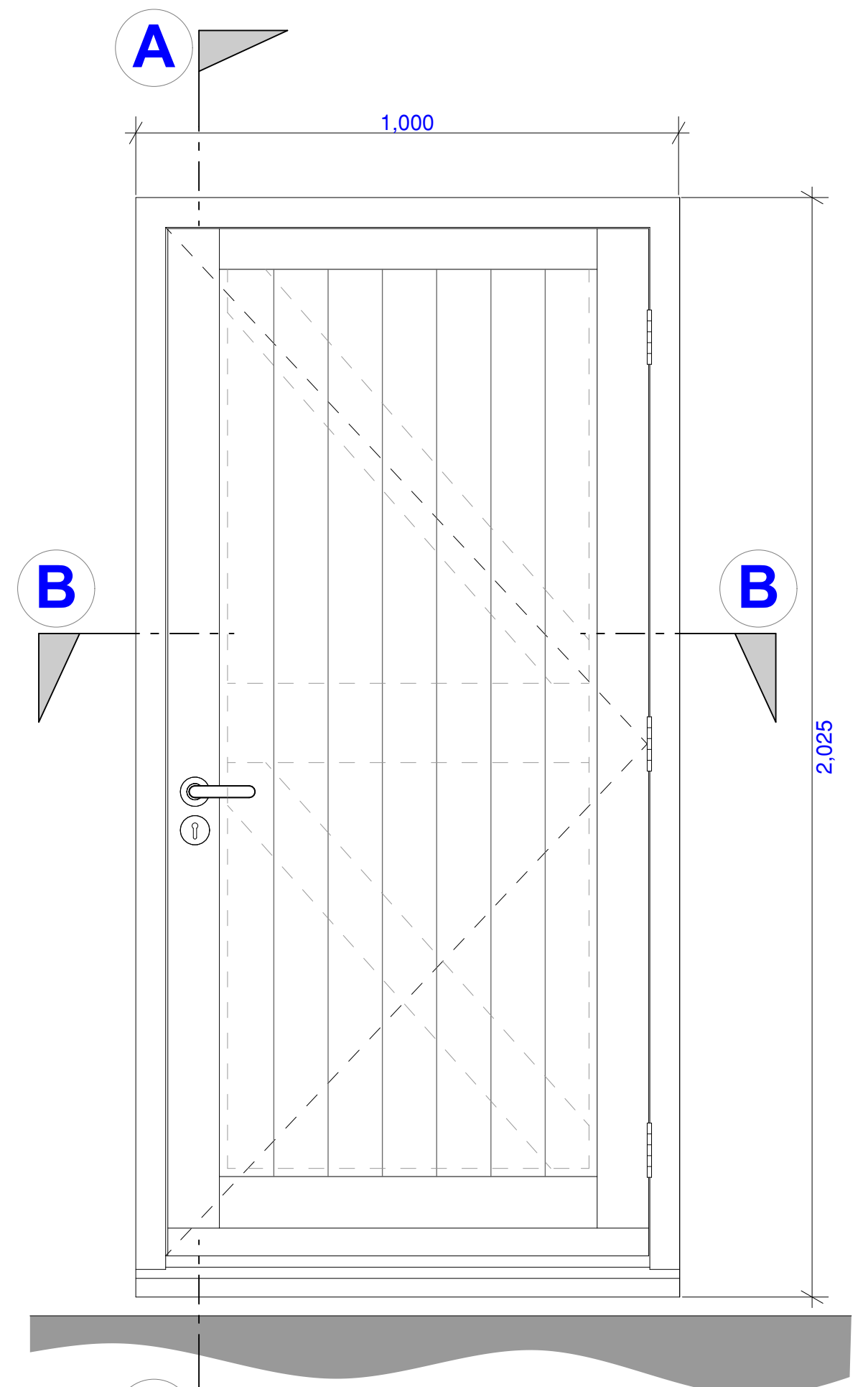
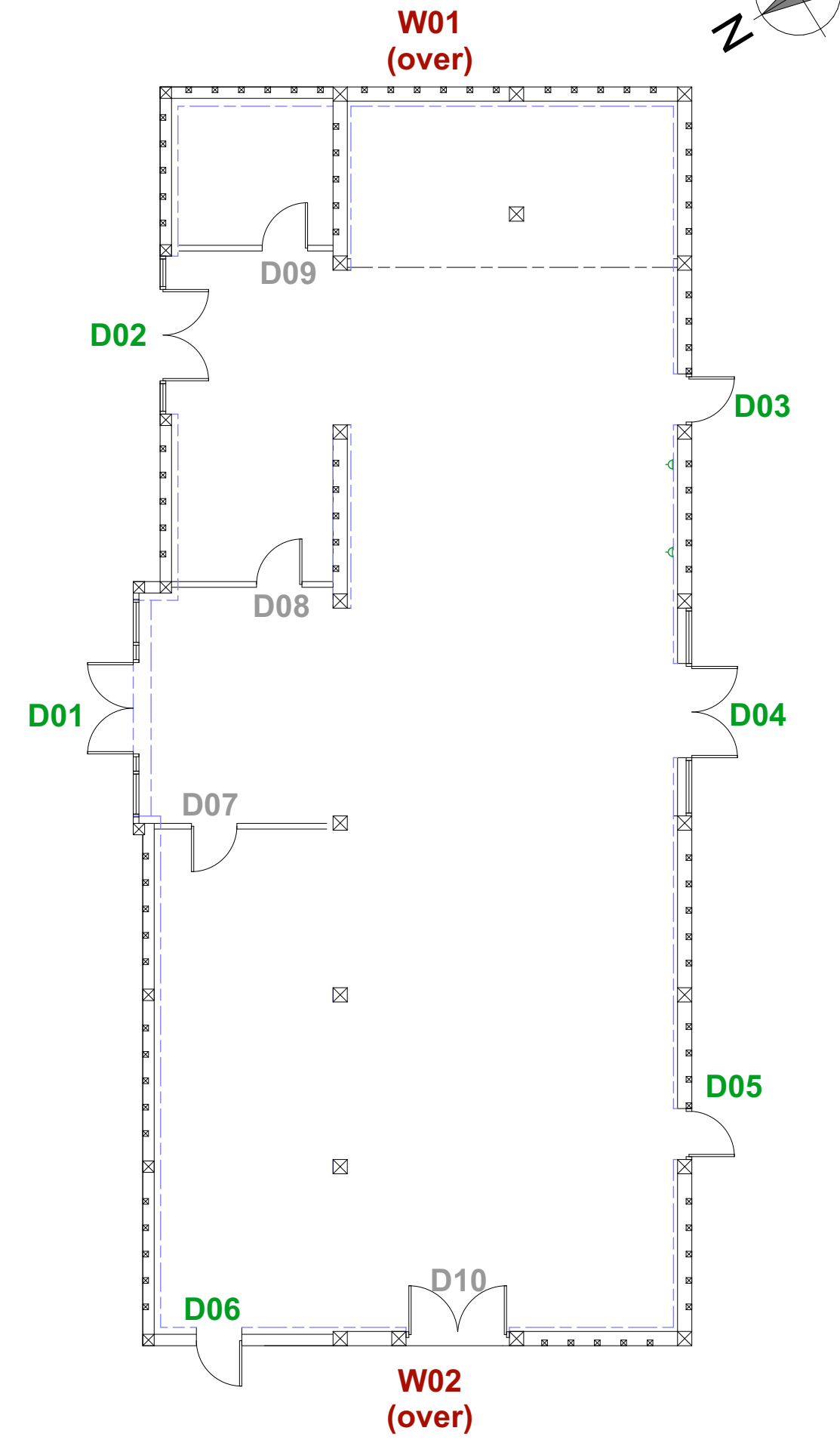

Door D03 / (D05 & 06 similar)

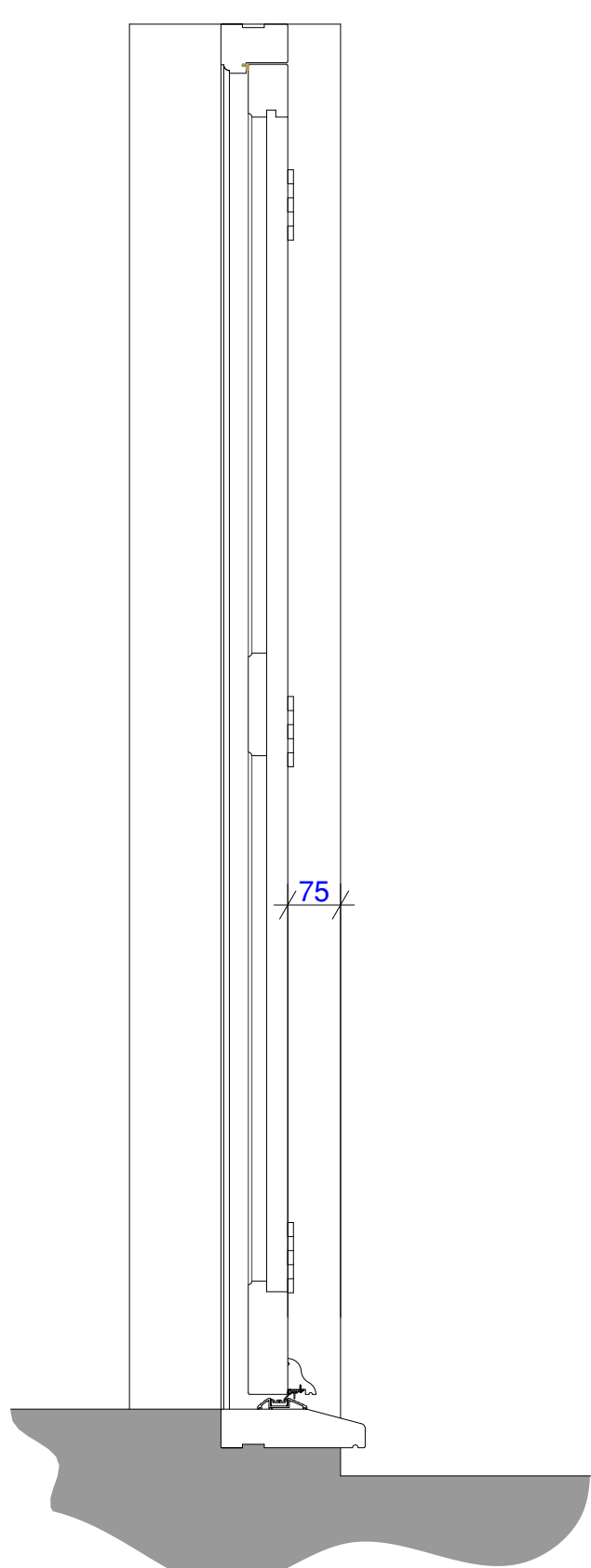

A-A

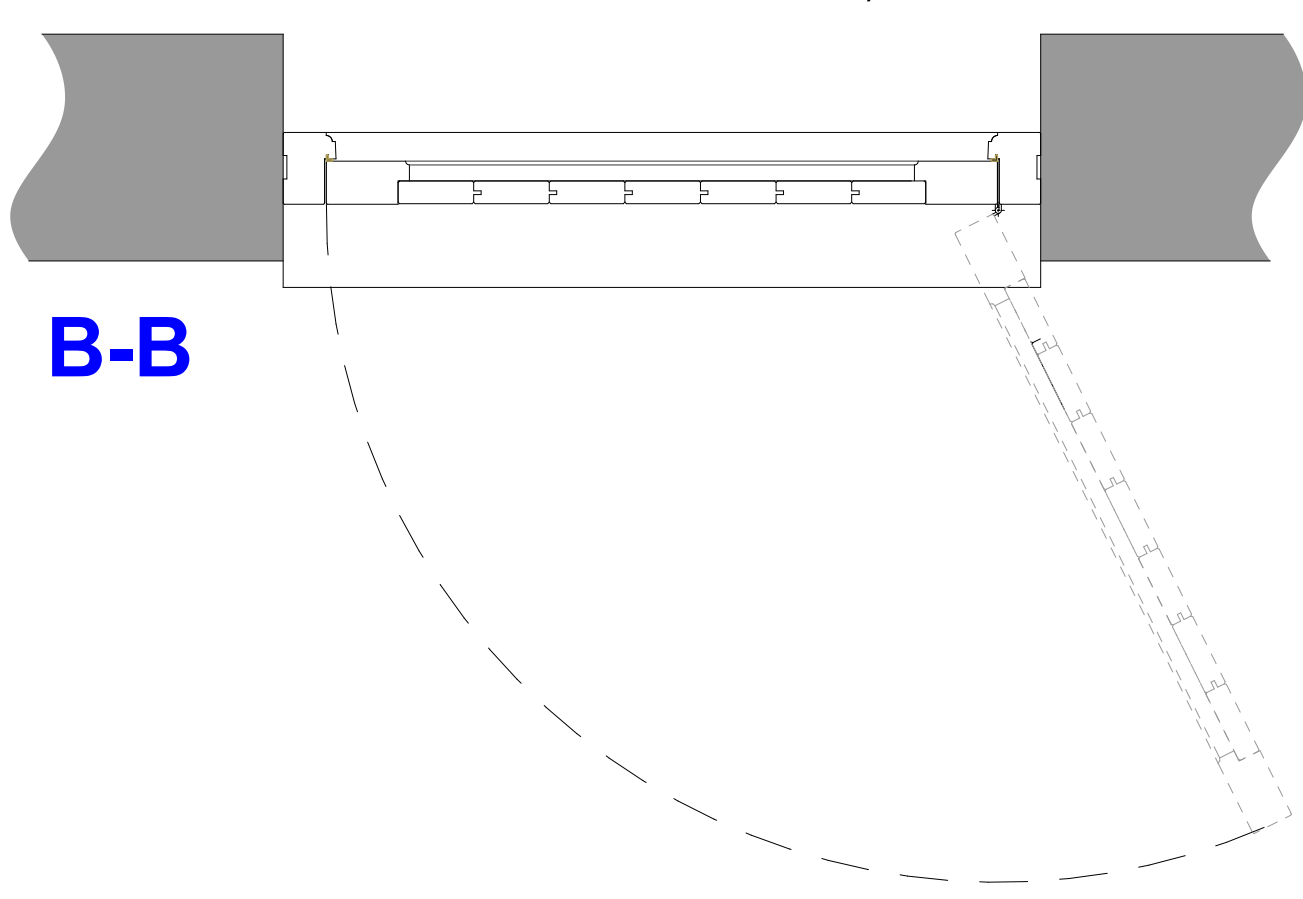

B-B

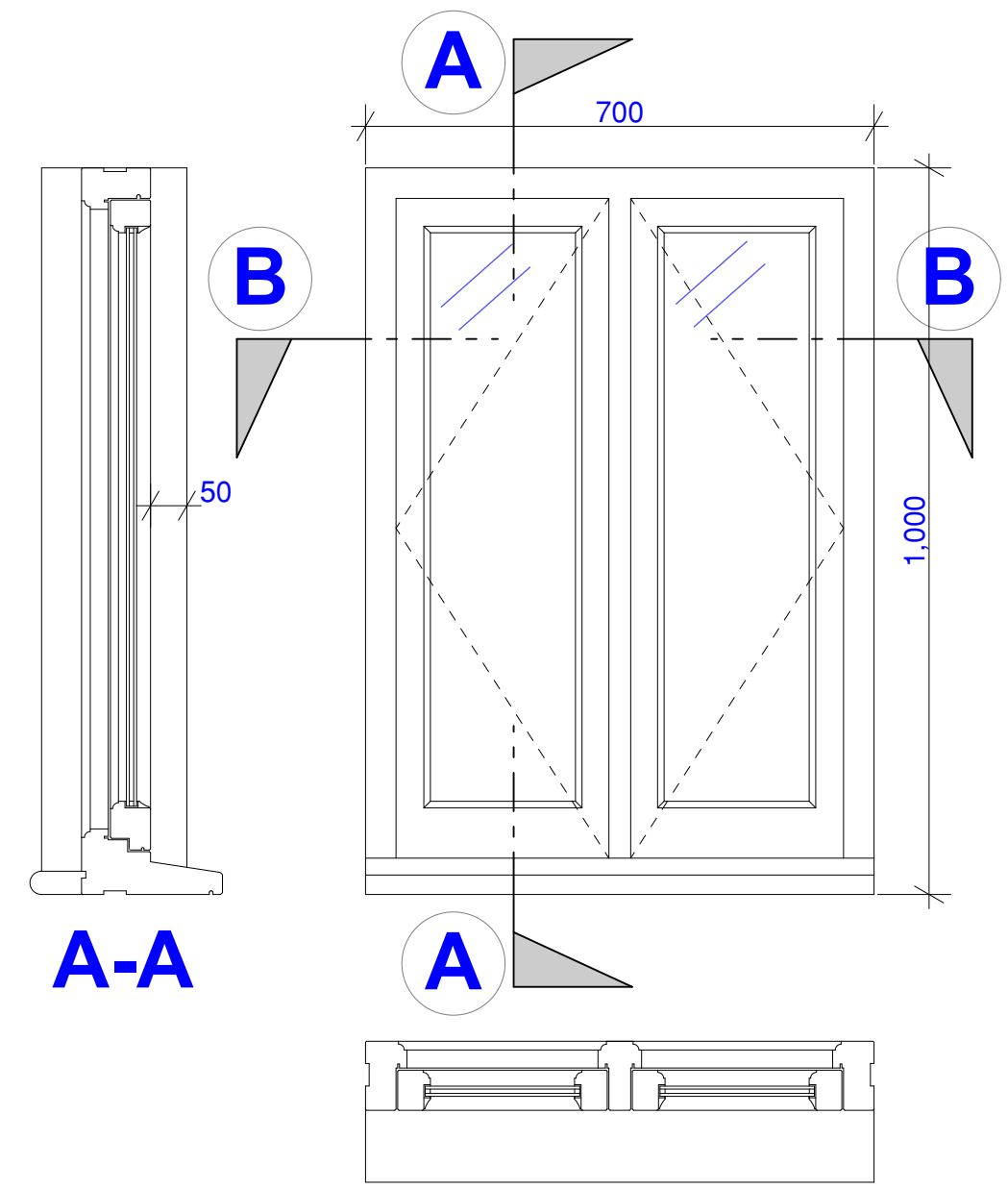

Window W01 & 02

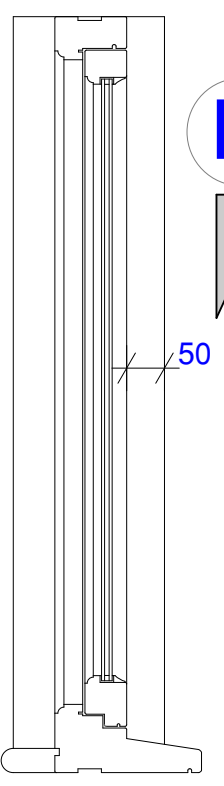

A-A

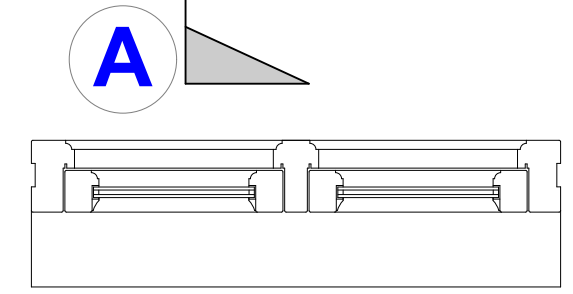

B-B

**EXTERNAL DOORS & WINDOWS**  
 1) EXISTING DOORS ARE FORMED OF; HARDWOOD TIMBER FRAMED SIDE HUNG PANELS/CASEMENTS, STAINED MATT BLACK WITH SINGLE GLAZED UNITS. TRADITIONAL METAL HINGES / LATCHES. TIMBER SILL AND PAINTED TIMBER WINDOW BOARDS WITH BULLNOSE PROFILE, STAINED MATT BLACK.  
 2) ALL NEW DOORS & WINDOWS ARE TO VISUALLY MATCH THE EXISTING DESTROYED AS FAR AS PRACTICALLY POSSIBLE I.E. OVERALL STYLE / APPEARANCE, MATERIAL, COLOUR, ETC. NEW DOUBLED GLAZED UNITS ARE TO BE 24MM DOUBLE GLAZED UNITS (OR SIMILAR APPROVED). ALL GLAZING TO NEW DOORS FROM GL UP TO 1.5m & WINDOWS BELOW 800mm TO RECEIVE SAFETY GLAZING. ALL GLAZING TO CRITICAL AREAS OF DOORS TO COMPLY WITH CLASS 2 OF BS EN 12600 OR CLASS B OF BS 6206. SPECIALIST CONTRACTOR DESIGN ITEM.

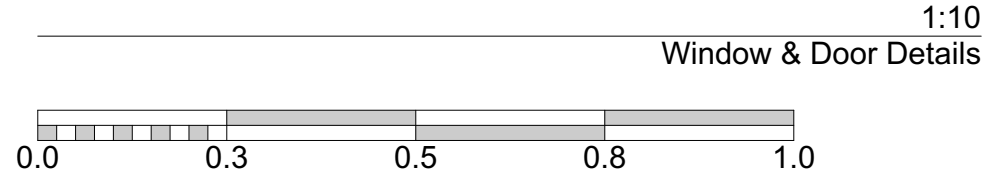

1:10  
 Window & Door Details