

DRAWING SCALE: 1:50

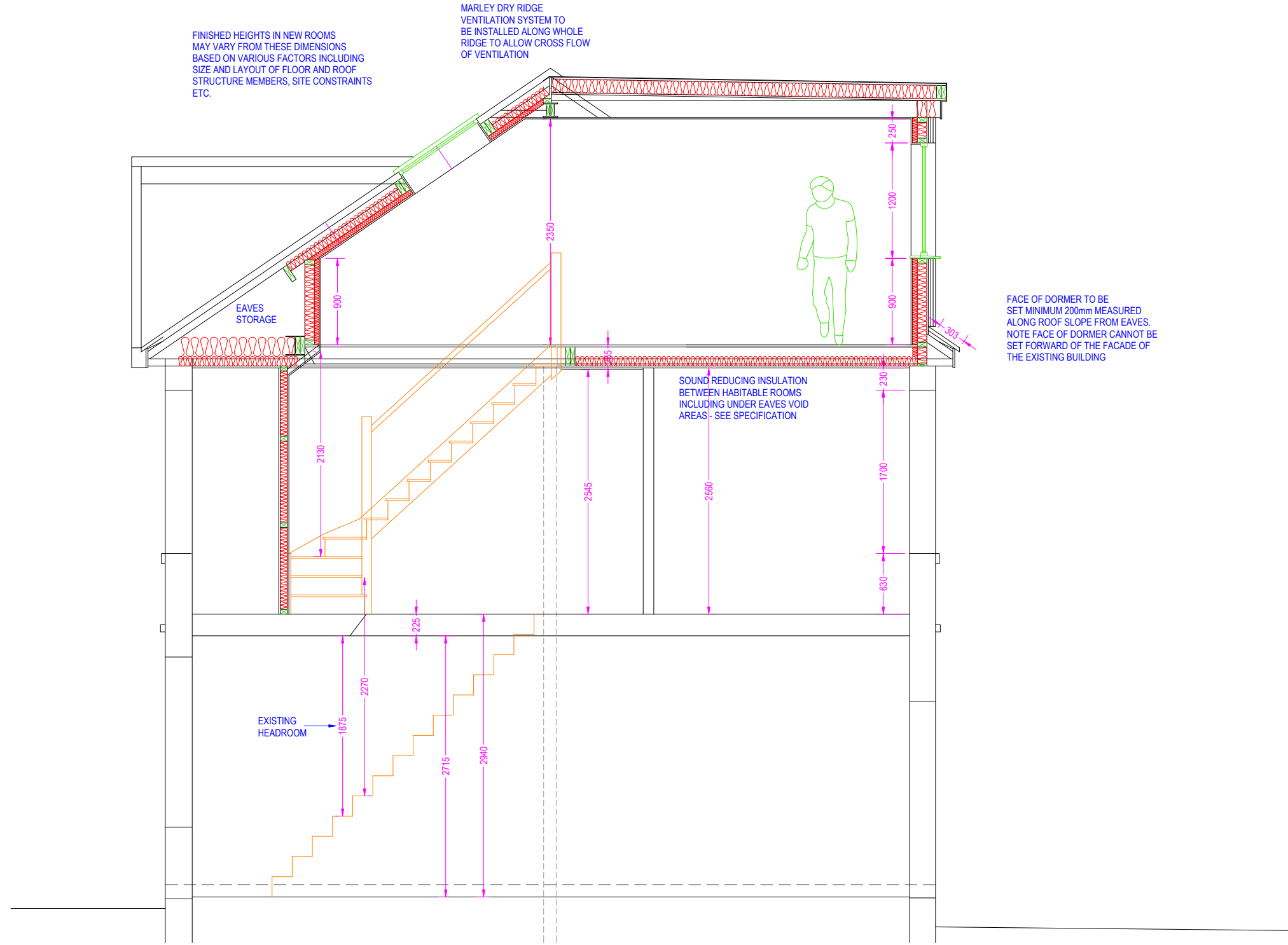

FINISHED HEIGHTS IN NEW ROOMS MAY VARY FROM THESE DIMENSIONS BASED ON VARIOUS FACTORS INCLUDING SIZE AND LAYOUT OF FLOOR AND ROOF STRUCTURE MEMBERS, SITE CONSTRAINTS ETC.

MARLEY DRY RIDGE VENTILATION SYSTEM TO BE INSTALLED ALONG WHOLE RIDGE TO ALLOW CROSS FLOW OF VENTILATION

SOUND REDUCING INSULATION BETWEEN HABITABLE ROOMS INCLUDING UNDER EAVES VOID AREAS - SEE SPECIFICATION

FACE OF DORMER TO BE SET MINIMUM 200mm MEASURED ALONG ROOF SLOPE FROM EAVES. NOTE FACE OF DORMER CANNOT BE SET FORWARD OF THE FACADE OF THE EXISTING BUILDING

EXISTING HEADROOM

PROPOSED SECTION 1:50 @ A3

IF IN DOUBT - ASK

COPYRIGHT CITYSCAPE ARCHITECTURE LTD

ALL DIMENSIONS, LEVELS AND ANGLES TO BE CHECKED ON SITE BY CONTRACTOR

ALL BOUNDARIES ARE ASSUMED AND WE ACCEPT NO LIABILITY FOR BOUNDARY INACCURACY

YOU ARE REMINDED OF YOUR RESPONSIBILITIES UNDER THE 'PARTY WALL ETC. ACT. 1996 WHERE APPLICABLE

RESPONSIBILITY IS NOT ACCEPTED FOR ERRORS MADE BY OTHERS IN SCALING FROM THIS DRAWING

ALL DRAIN RUNS EXISTING AND PROPOSED ARE TO BE VERIFIED ON SITE DUE TO RESTRICTED ACCESS - ENSURE ALL CONNECTIONS MADE TO CORRECT SYSTEMS

T: 0117 900 0124

W: www.aboplans.co.uk

E: mail@aboplans.co.uk

CLIENT: KABASHI

SITE:

116 MOUNT HILL ROAD, BRISTOL, BS15 8QR

SCHEME:

LOFT CONVERSION

TO BE READ IN CONJUNCTION WITH: Z-805-S001&2

DRAWING NUMBER: Z-805-D111

REVISION:



DATE: 30TH NOVEMBER 2023

CITYSCAPE
ARCHITECTURE