

Note 1
 Internal Seal: 1.6mm security tape
 Perimeter Seal: Silfix U9 perimeter seal
 External Seal: Hodgsons Multi-Purpose Putty

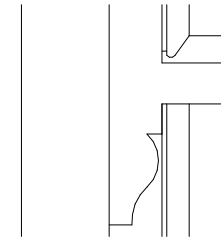

Standard Horn Profile

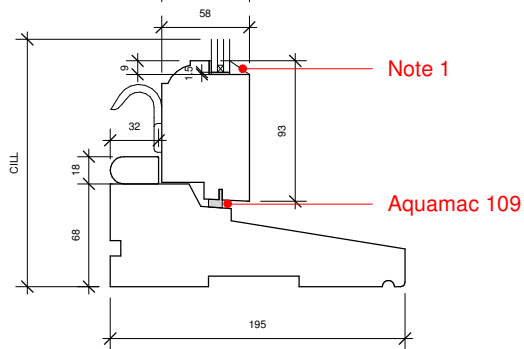
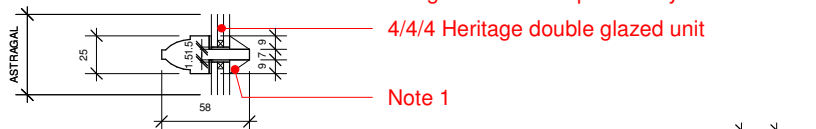
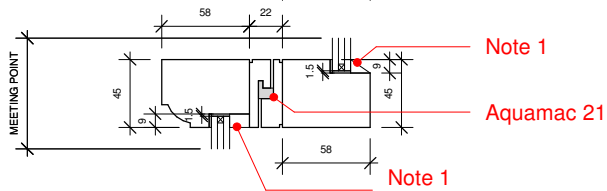
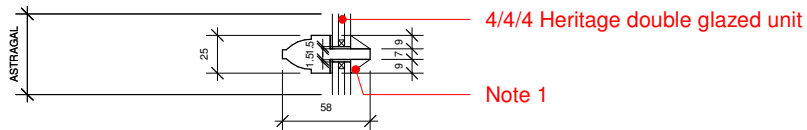

Sectional Detail
 1:5

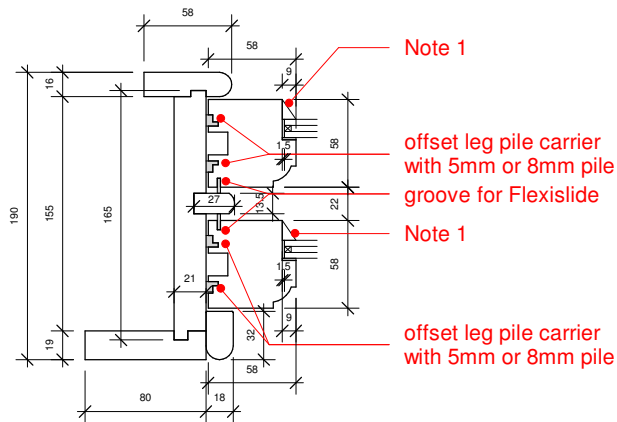

Plan Detail
 1:5

| G | Note corrected. | RMcl | 03/03/21 |
|----------|-----------------------------------|------|----------|
| F | Note 1 amended to 1.6mm. | RMcl | 02/03/21 |
| E | Glazing tape notes amended. | RMcl | 27/11/20 |
| D | Stile detail amended. | RMcl | 09/11/20 |
| C | Glass clearance dimensions added. | RMcl | 04/11/20 |
| Rev | Description | Auth | Date |
| REVISION | | | |

DRAWING TITLE
**Sash & Case
 Heritage Style
 Ogee Profile**

PROJECT
Standard Details

| | | |
|--------------|----------|------------|
| DATE CREATED | DESIGNER | SCALE @ A4 |
| 27/10/20 | RMcl | 1 : 5 |

| | |
|----------------|----------|
| DRAWING NUMBER | REVISION |
| S&C_H_OG | G |

