

PROPOSED FIRST FLOOR PLAN

-  New Timber Stud Wall
-  New Solid Masonry Wall

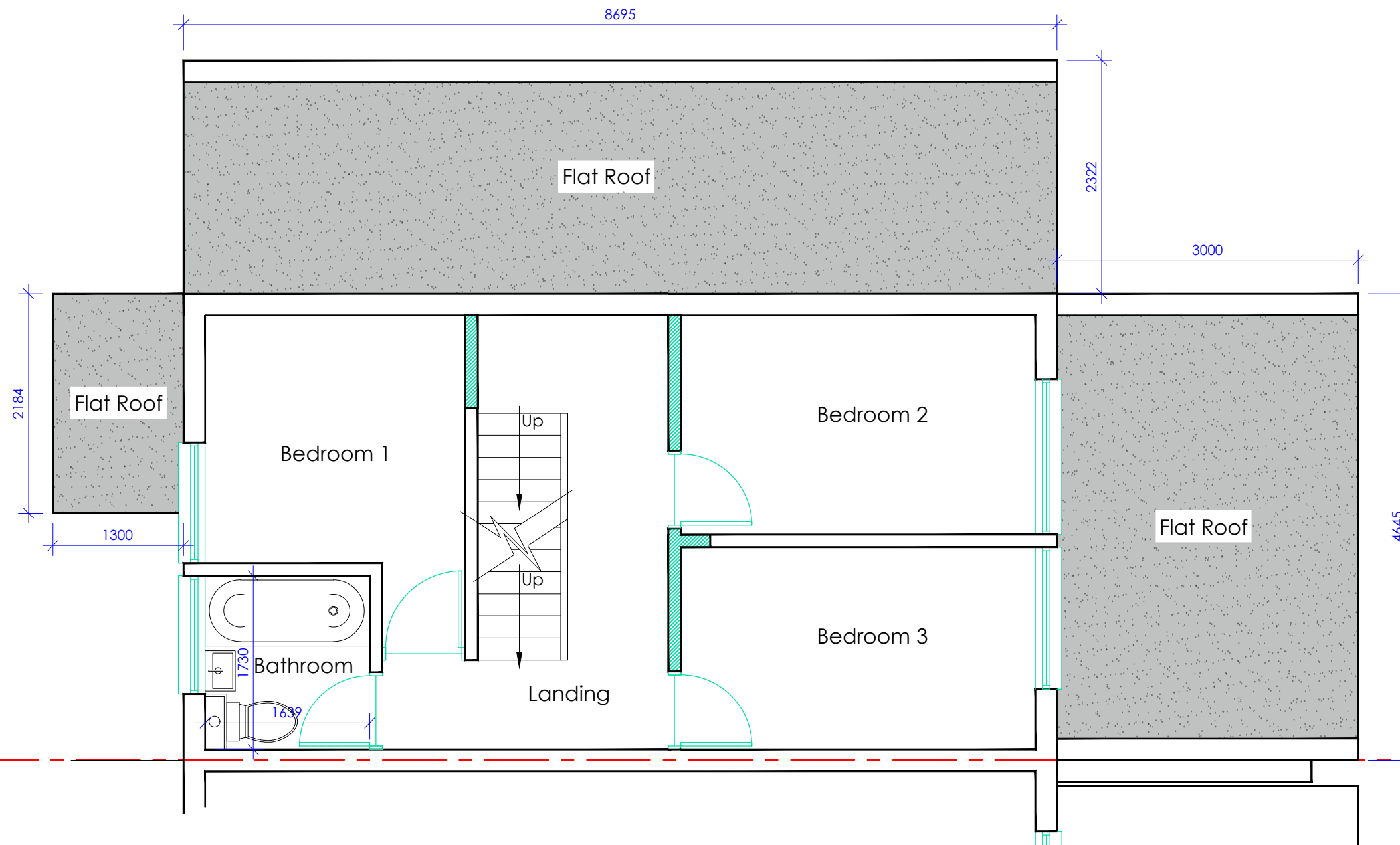

Dwg. No:	RA518/09PLD	Title:	Proposed First Floor Plan	Drawn by:	SK
Scale:	1:50(A3)	Address:	37 Dorel Close Luton LU2 7JH	Date:	July 2023
Revision:		Client:	Mr. A. Kumar		
Project:	Extension & Refurbishment Project				