

Notes:

1. Do not scale off this drawing.
2. If in doubt about dimensions contact designer.
3. All dimensions shown on any drawing to be checked and verified on site by the contractor before any work commences. Contractor to ensure that all elements of the proposals marry through with any existing levels where required.
4. All works to be carried out to The Building (Scotland) Regulations 2004 (as amended) and all relevant British Standards and Codes of Practice contained therein.
5. All drainage works to comply with The Building (Scotland) Regulations 2004 (as amended) and BS EN 12056 and to the satisfaction of the Local Authority Building Standards Officers/Inspectors.
6. This drawing is to be read in conjunction with all relevant structural/civil engineers and manufacturers drawings and specifications.

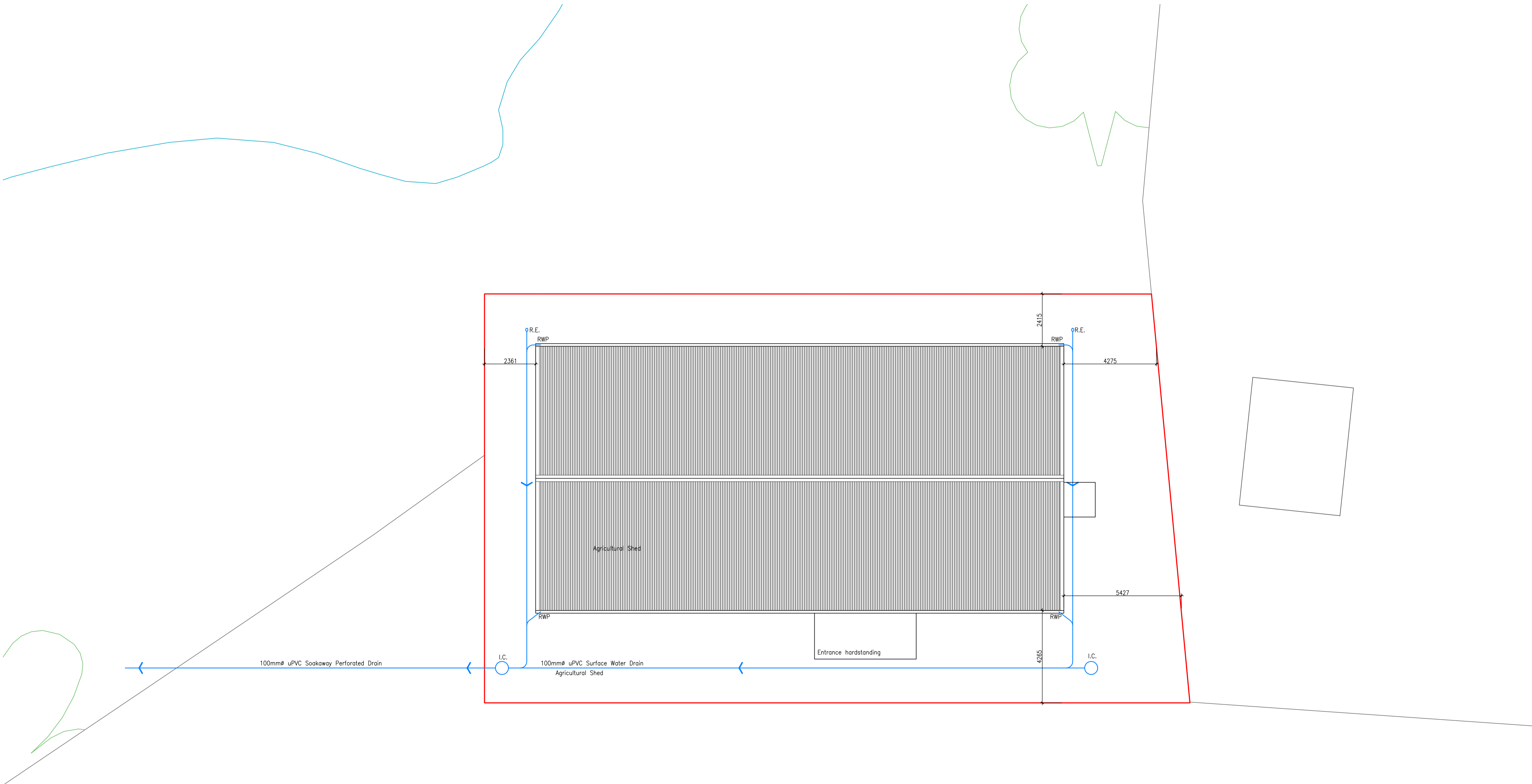

**01** Site Plan as Proposed  
Scale 1:100 @ A1

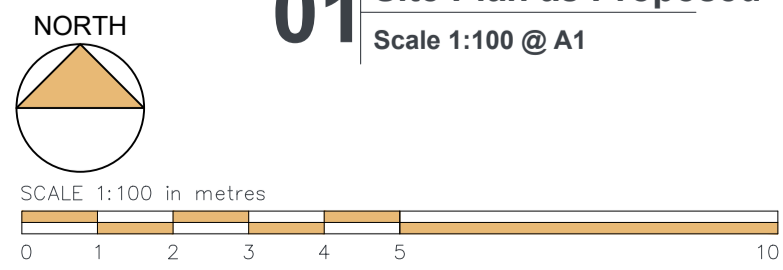

REV	DESCRIPTION	BY	DATE
REVISIONS			

**TmC** Planning & Property Development Ltd  
48 West George Street  
Glasgow, G2 1DP  
Tel: 0141 266 6666  
www.tmcplanning.co.uk

CLIENT: Mr Neil Christie  
DESIGNER: TmC Planning & Property Development Ltd

SITE: Dalarn, Fintry Road, Balfon, Glasgow, G63 0QD

PROPOSED: Agricultural Shed

TITLE: Detailed Site Plan as Proposed

**PLANNING**

SCALE:	DATE:	DRAWN BY:	CHECKED:
1:100 @ A1	08/12/2023	AKN	-
PROJECT REFERENCE:	DRAWING NUMBER:	REVISION:	-
23-125	PL-LAY-02	-	-