

See LSD/060122 rev I

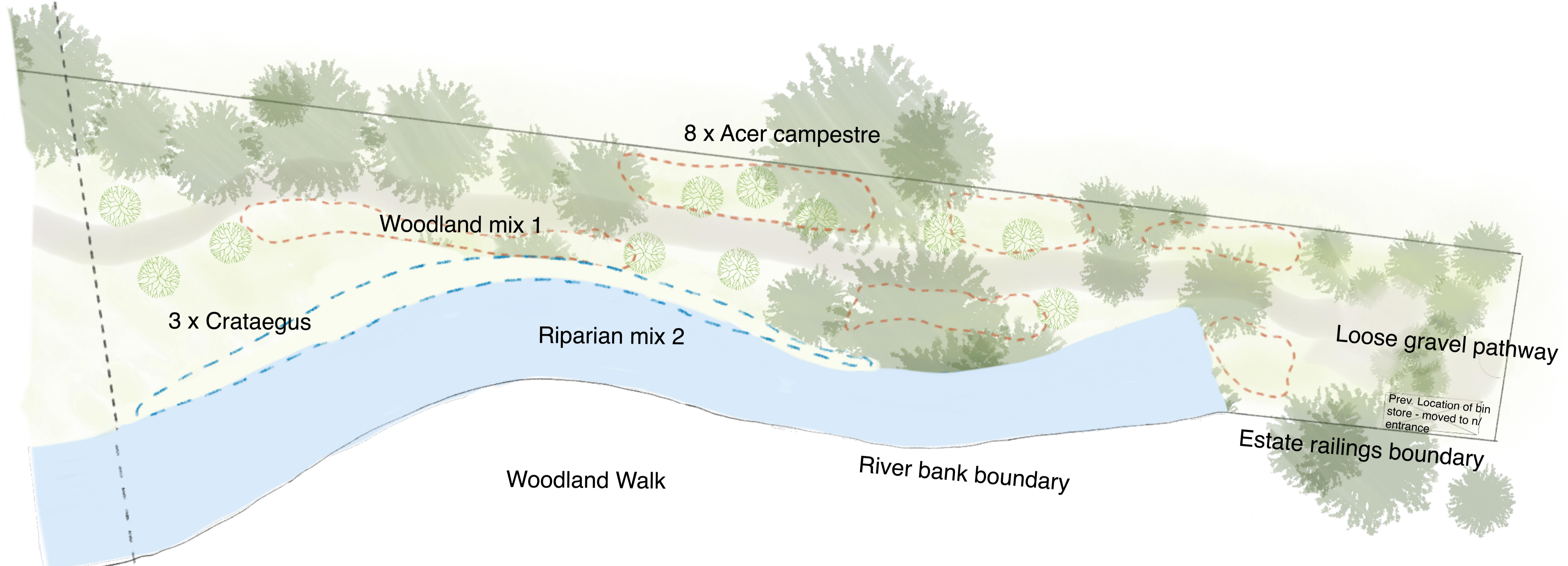

PLANT SPECIFICATION

| Quantity | Scientific name | Common name | Variety | Height | Container | Density | Specification | Native to UK | RHS Perfect for | Population Composition/Breakdown (est.) |
|----------|---------------------------|-------------|---------|--------|-----------|--------------|-------------------|--------------|-----------------|---|
| 8 | <i>Acer campestre</i> | Field Maple | | 2-2.5m | Container | As indicated | Standard, 10-12cm | Y | | Sapindaceae |
| 3 | <i>Crataegus monogyna</i> | Hawthorn | | 2-2.5m | Container | As indicated | Standard, 10-12cm | Y | | Rosaceae |

| Quantity | Scientific name | Common name | Variety | Height | Container | Density | Specification | Native to UK | RHS Perfect for | Specific Benefits to Wildlife |
|----------|--------------------------------|--------------------|-------------------|---------|-----------|-------------------------|---------------------|--------------|-----------------|---|
| 10 | <i>Anemone x hybrida</i> | Japanese anemone | Koragin Charlotte | 60-80cm | 2tr | 3 plants/m ² | Full pot C | Y | Y | |
| 25 | <i>Asarum europaeum</i> | | | 60-80cm | 2tr | 3 plants/m ² | Full pot C | Y | Y | |
| 25 | <i>Asperulum scolopendrium</i> | | | 60-80cm | 2tr | 3 plants/m ² | Full pot C | Y | Y | |
| 25 | <i>Astilbe major</i> | | | 60-80cm | 2tr | 3 plants/m ² | Full pot C | Y | Y | |
| 15 | <i>Centaurea ruber</i> | Valerian | Hadspen Blood | 60-80cm | 2tr | 3 plants/m ² | Full pot C | Y | Naturalised | |
| 15 | <i>Digitalis purpurea</i> | Forgoive | Serendipity | 60-80cm | 2tr | 3 plants/m ² | Full pot C | Y | Y | Larval food: Heath Fritillary |
| 20 | <i>Dryas octopetala</i> | Blue Fern | | 60-80cm | 2tr | 3 plants/m ² | Full pot C | Y | Y | |
| 20 | <i>Erythronium rubrum</i> | | | 60-80cm | 2tr | 3 plants/m ² | Full pot C | Y | Y | |
| 20 | <i>Erythronium europaeum</i> | Spindle | | 1-1.2m | 5tr | 1 plants/m ² | Branched, 5 brks, C | Y | Y | Larval food & fruiting plant: Holly Blue |
| 20 | <i>Galium odoratum</i> | | | 60-80cm | 2tr | 3 plants/m ² | Full pot C | Y | Y | |
| 10 | <i>Geranium pratense</i> | | Lily Lovel | 60-80cm | 2tr | 3 plants/m ² | Full pot C | Y | Y | |
| 10 | <i>Geranium sanguineum</i> | | | 60-80cm | 2tr | 3 plants/m ² | Full pot C | Y | Y | |
| 10 | <i>Geum urbanum</i> | Wood Avenas | | 60-80cm | 2tr | 3 plants/m ² | Full pot C | Y | Y | Larval food: Grizzled Skipper |
| 20 | <i>Hebeclonia bellidifolia</i> | | | 60-80cm | 2tr | 3 plants/m ² | Full pot C | Y | Y | |
| 12 | <i>Helleborus viridis</i> | Stinking Hellebore | | 1-1.2m | 5tr | 1 plants/m ² | Branched, 5 brks | Y | Y | Larval food: Common Peacock, Red Admiral |
| 5 | <i>Ilex aquifolium</i> | Holly | | 1-1.2m | 5tr | 1 plants/m ² | Branched, 5 brks, C | Y | Y | Larval food & fruiting plant: Holly Blue |
| 12 | <i>Lonicera periclymenum</i> | Honey-suckle | | 1-1.2m | 5tr | 1 plants/m ² | Branched, 5 brks, C | Y | Y | |
| 20 | <i>Polimonium caeruleum</i> | Jacob's Ladder | | 60-80cm | 2tr | 3 plants/m ² | Full pot C | Y | Y | |
| 20 | <i>Polypodium vulgare</i> | | | 60-80cm | 2tr | 3 plants/m ² | Full pot C | Y | Y | |
| 6 | <i>Prunus spinosa</i> | Blackthorn | | 1-1.2m | 5tr | 1 plants/m ² | Branched, 5 brks | Y | Y | Larval food: Black-veined White Brown Hair Stream, Black Hairstreak |
| 20 | <i>Saxifraga aizoides</i> | | | 60-80cm | 2tr | 3 plants/m ² | Branched, 5 brks | Y | Y | |
| 8 | <i>Viburnum dentatum</i> | Wayfaring tree | | 1-1.2m | 5tr | 1 plants/m ² | Branched, 5 brks | Y | Y | |
| 10 | <i>Viburnum opulus</i> | Guelder Rose | | 1-1.2m | 5tr | 1 plants/m ² | Branched, 5 brks, C | Y | Y | |

| Quantity | Scientific name | Common name | Variety | Height | Container | Density | Specification | Native to UK | RHS Perfect for | Specific Benefits to Wildlife |
|----------|------------------------------|---------------------|---------|---------|-----------|-------------------------|---------------|--------------|-----------------|-------------------------------|
| 5 | <i>Butomus umbellatus</i> | Flowering rush | | 60-80cm | 2tr | 3 plants/m ² | Full pot C | Y | Y | |
| 5 | <i>Carex panicea</i> | Hard-tail sedge | | 60-80cm | 2tr | 3 plants/m ² | Full pot C | Y | Y | |
| 4 | <i>Dianthus barbatus</i> | Angels' fishing rod | | 60-80cm | 2tr | 3 plants/m ² | Full pot C | Y | Y | |
| 6 | <i>Iris pseudacorus</i> | Flag iris | | 60-80cm | 2tr | 3 plants/m ² | Full pot C | Y | Y | |
| 4 | <i>Lupinus sativus</i> | Purple lupine | | 60-80cm | 2tr | 3 plants/m ² | Full pot C | Y | Y | |
| 4 | <i>Mercurialis perennis</i> | Water mint | | 60-80cm | 2tr | 3 plants/m ² | Full pot C | Y | Y | |
| 4 | <i>Menyanthes trifoliata</i> | Poppy | | 60-80cm | 2tr | 3 plants/m ² | Full pot C | Y | Y | |
| 4 | <i>Myosotis scorpioides</i> | Water forget me not | | 60-80cm | 2tr | 3 plants/m ² | Full pot C | Y | Y | |
| 4 | <i>Nasturtium officinale</i> | Watercress | | 60-80cm | 2tr | 3 plants/m ² | Full pot C | Y | Y | |
| 4 | <i>Polypodium vulgare</i> | | | 60-80cm | 2tr | 3 plants/m ² | Full pot C | Y | Y | |
| 4 | <i>Ranunculus flammula</i> | Lesser spearwort | | 60-80cm | 2tr | 3 plants/m ² | Full pot C | Y | Y | |

| COMMON NAME | BOTANICAL NAME | BENEFITS TO WILDLIFE |
|----------------------------|-------------------------------------|--|
| Yarrow | <i>Achillea millefolium</i> | |
| Common bent | <i>Agrostis capillaris</i> | |
| Kidney vetch | <i>Anthyllus vulneraria</i> | Larval Food: Small Blue |
| Daisy | <i>Bellis perennis</i> | |
| Maiden pink | <i>Dianthus deltoides</i> | |
| Hard fescue | <i>Festuca brevipila</i> | Larval Food: Gatekeeper, Meadow Brown, Small Heath |
| Chewings fescue | <i>Festuca rubra ssp. commutata</i> | Larval Food: Gatekeeper, Meadow Brown, Small Heath |
| Wild strawberry | <i>Fragaria vesca</i> | Larval Food: Grizzled Skipper |
| Ladies' bedstraw | <i>Galium verum</i> | |
| Rock rose | <i>Helianthemum nummularium</i> | Larval Food: Common Peacock, Green Hairstreak, Northern Brown Argus, Silver Studded Blue |
| Cat's ear | <i>Hypochaeris radicata</i> | |
| Wild marjoram | <i>Origanum vulgare</i> | Larval Food: Large Blue |
| Burnet Sawfly | <i>Pimpinella saxifraga</i> | |
| Smooth stalked meadowgrass | <i>Poa pratensis</i> | Larval Food: Gatekeeper, Meadow Brown, Small Heath, Ringlet |
| Cowslip | <i>Primula veris</i> | Larval Food: Duke of Burgundy |
| Primrose | <i>Primula vulgaris</i> | Larval Food: Duke of Burgundy |
| Selfheal | <i>Prunella vulgaris</i> | Larval Food: Duke of Burgundy |
| Meadow buttercup | <i>Ranunculus acris</i> | |
| Sheeps sorrel | <i>Rumex acetosella</i> | Larval Food: Small Copper |
| Autumn hawkbit | <i>Scorzoneroides autumnalis</i> | |
| Bladder campion | <i>Silene vulgaris</i> | |
| Devils Bit Scabious | <i>Succisa pratensis</i> | Larval Food: Marsh Fritillary |
| Wild thyme | <i>Thymus polytrichus</i> | Larval Food: Large Blue |
| Wild clover | <i>Trifolium repens</i> | Larval Food: Clouded Yellow, Pale Clouded yellow |
| German shepherd speedwell | <i>Veronica chamaedrys</i> | Larval Food: Heath Fritillary |
| Common speedwell | <i>Veronica officinalis</i> | |
| Common dog violet | <i>Viola riviniana</i> | Larval Food: Dark Green Fritillary, High Brown Fritillary |

DESIGN RATIONALE

The woodland walk connects the formal spaces outside the building to the river and woodland beyond. The design is unchanged from the original approved, with the exception of the bin store moved to the north entrance and a change in replacement tree species. Perennial and shrub planting is as approved, with the exception of invasive species originally listed being replaced with native climbing plants. Riparian marginal planting has also been improved with native species excluded in favour of native plants. The flowering lawn continues the wildlife improvements and marks the change in seasons.

In terms of hard landscaping, trodden gravel will sweep through the site to the road entrance. Using trodden gravel over existing ground level will exclude the need for disruptive excavations in the root zone of retained trees. The gravel will connect with the more formal hoggins of the terrace and bridge pathways with a careful and gradual blending of materials. Boundary treatments remain as existing.

Please check all dimensions on site. Do not rely on photocopies. This drawing is the property of Wright Landscape and Arboriculture Ltd. and is issued for the use of the client. This drawing may be changed without the written consent of Wright Landscape and Arboriculture Ltd.

Title: Landscaping Plan (Woodland)

Site: 41 College Rd, Dulwich

Client: Mr. D. Thompson

Client Ref: NMA to 23/AP/0353

Date: 07/12/23

Scale: NTS @ A1

Drawn by: MW

DWG Ref: LSD/060123 Rev: B

Checked by: PW

WRIGHT
Landscape and Arboriculture Ltd
Alpine Road, Redhill
Surrey RH1 2RH
01737 516004
office@wrightlandscape.co.uk
www.wrightlandscape.co.uk