

REV.	REVISION NOTE	DATE	BY
A	Issued For Coordination	03/12/21	MM
B	Stage 3_Issued for Cost Plan	04/08/23	JK
C	PLANNING ISSUE	14/12/23	JK

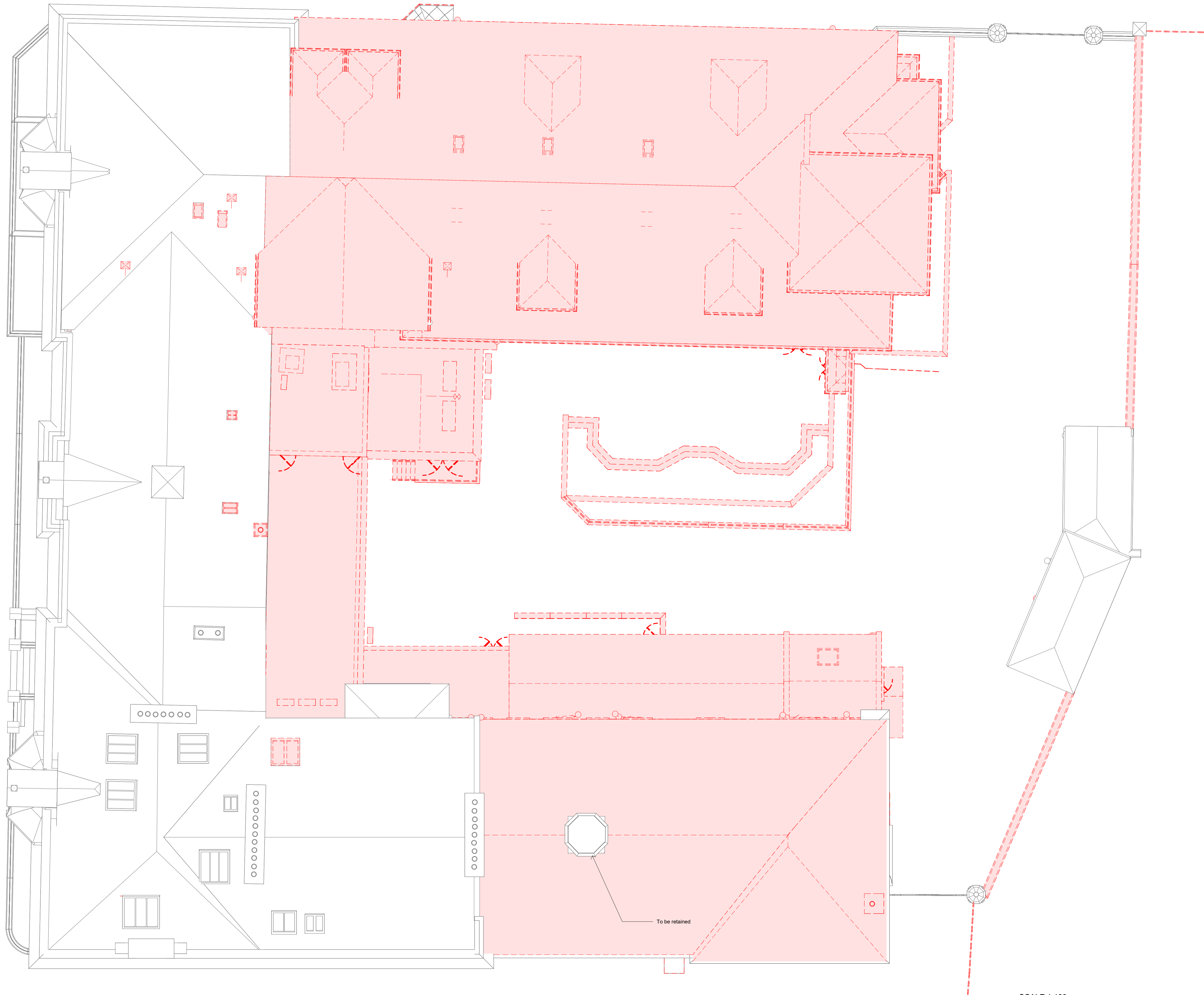

General Notes:
Refer to Structural engineer for Risk Assessment, Suggested Method Statement and confirmation of areas to be removed. Contractor to agree Method Statements with Str Eng and submit to Client, Design Team and CDM Co-ordinator prior to starting work to relevant areas.

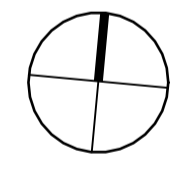

NOTES:
DO NOT SCALE FROM DRAWING
ALL DIMENSIONS TO BE CHECKED ON SITE PRIOR TO THE START OF ANY WORK AND ANY DISCREPANCIES NOTIFIED IN WRITING.
REFER TO ENGINEERS' DRAWINGS FOR ALL STRUCTURAL, HEATING, LIGHTING, POWER, EXTERNAL AND UNDERGROUND DRAINAGE AND VENTILATION INFORMATION
ALL BUILDING WORKS TO COMPLY IN ALL RESPECTS TO CURRENT BUILDING STANDARDS FOR COUNTRY IN WHICH SITE IS LOCATED.

PLANNING

CLIENT:
Collective Architecture

PROJECT:
Kildonan Street

DRAWING:
Demolition Roof Plan

DATE	BY	SCALE	
DEC 2021	MM	1 : 100 @ A1	
JOB NO	CHKD	DRWG NO	REV
20240	-	DM_06	C

COLLECTIVE ARCHITECTURE

MERCAT BUILDING, 26 GALLOWGATE, GLASGOW, G1 5AB
TELEPHONE +44(0)141 552 3001 FAX +44(0)141 552 3888

24 AINSLIE PLACE, EDINBURGH, EH3 6AJ
TELEPHONE +44 (0)131 516 2270

EMAIL INFO@COLLECTIVEARCHITECTURE.CO.UK
WWW.COLLECTIVEARCHITECTURE.CO.UK

DM_05_Roof Plan
1 : 100

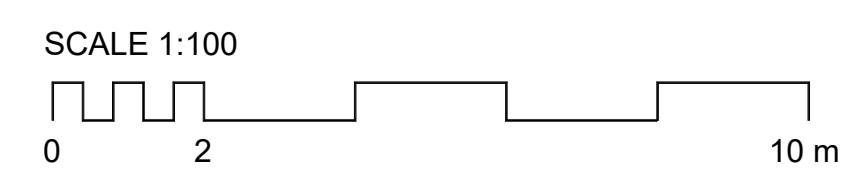

C:\Users\lunila\karablikova\Documents\20240 - Kildonan Street_Building-Central_karablikova.rvt