

# 610, Main Road, Harwich Mosque-Community Centre ARCHITECTURAL PROJECT

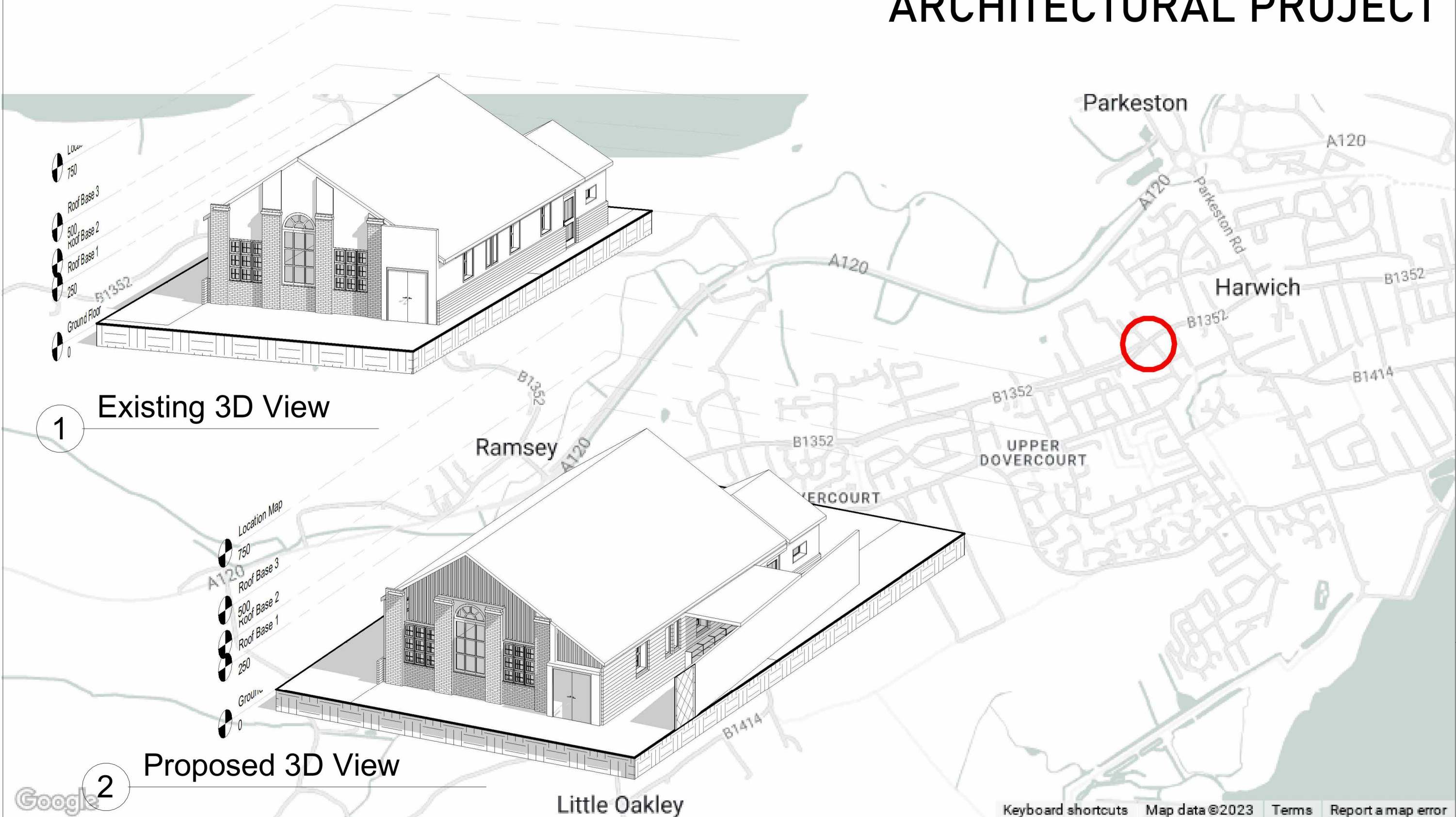

1

Existing 3D View

2

Proposed 3D View

Google

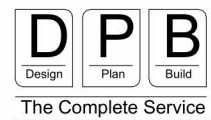

DPB LTD  
4 The Triangle  
Tanner Street  
Barking, IG11 8QA  
tel: [REDACTED]  
www.dpb ltd.co.uk



Client: Mr Mutaher Hamid Hussain  
Project: Pas De Deux, 610, Main Road, Harwich, CO12 4LW

Scale: -  
Date: 07/12/2023  
Drawn by: BD  
Checked by: AA

Project no :  
DPB/BD/P/000

Drawing:  
COVER

Declaration :This drawing was prepared for the purposes indicated above and is to be read as preliminary unless otherwise stated. DPB / Planning Bee Ltd has issued on the terms that it will not be reproduced or copied in whole or any part nor will any information be furnished from it without their consent. DPB/ Planning Bee Ltd accepts no liability for the unauthorized use of drawings .Building Notice Should Be Served To The Building Control Before The Commencement Of Any Building Works.Please Note That Before Building Works Commences It Is the Responsibility of Builder Or Owner To Serve Party Wall Notices To All Neighbours. All Dimensions are in mm .Follow the written dimensions only and do not scale from the drawings . No work to be carried out prior to the approval of the drawings under the Town & Country Planning acts and Building regulation

Signed of on:

Signature

Signed of by: