

SITED IN PAVED AREAS

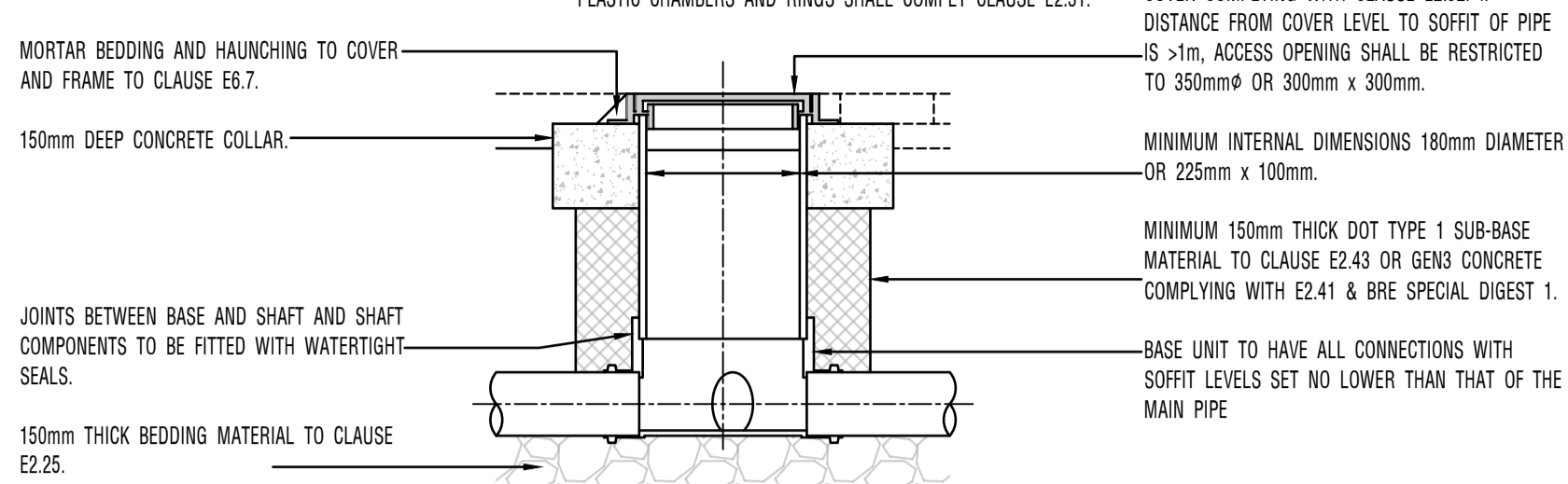

SITED IN SOFT LANDSCAPED AREAS

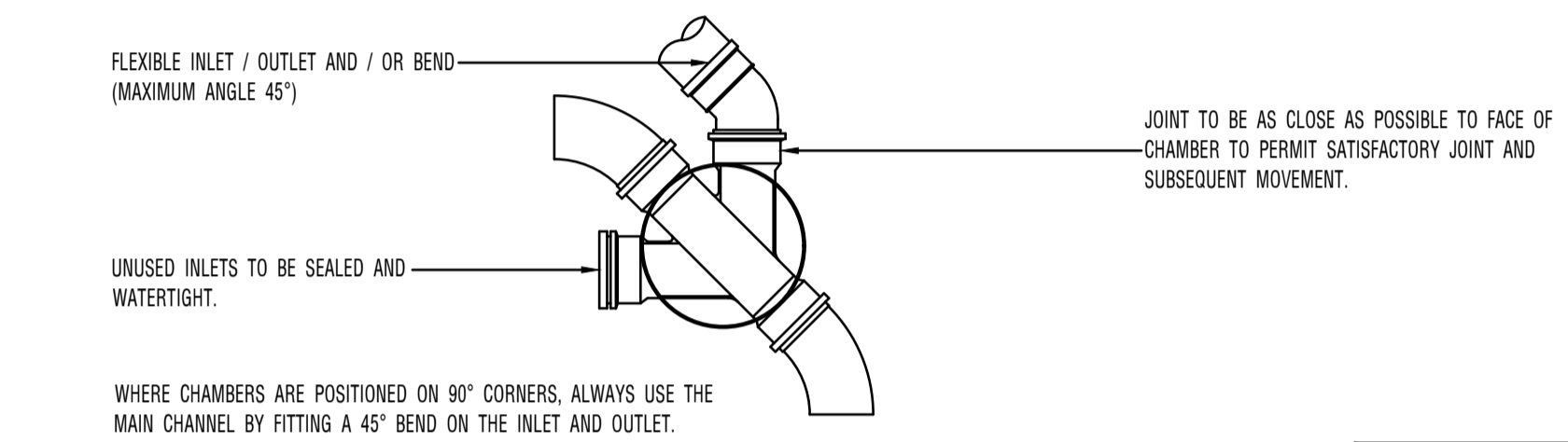
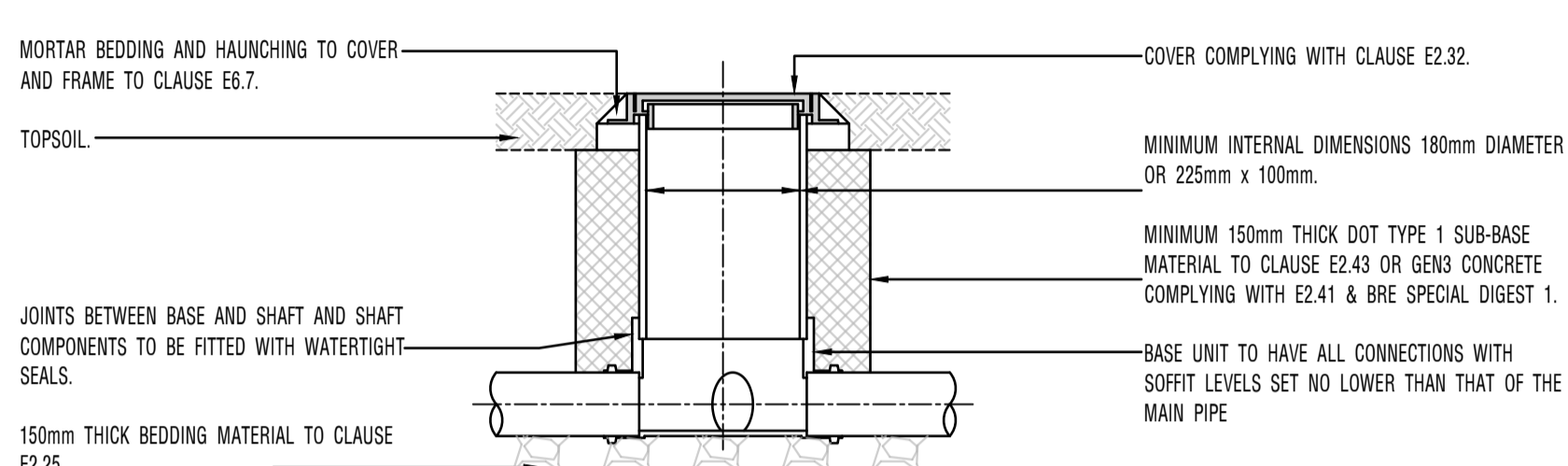

TYPICAL INSPECTION CHAMBER DETAIL - TYPE E (FLEXIBLE MATERIAL DETAIL)

MAXIMUM DEPTH FROM COVER LEVEL TO SOFFIT OF PIPE 2m, NON-ENTRY.

MANHOLE DETAILS ARE FROM THE DESIGN & CONSTRUCTION GUIDANCE

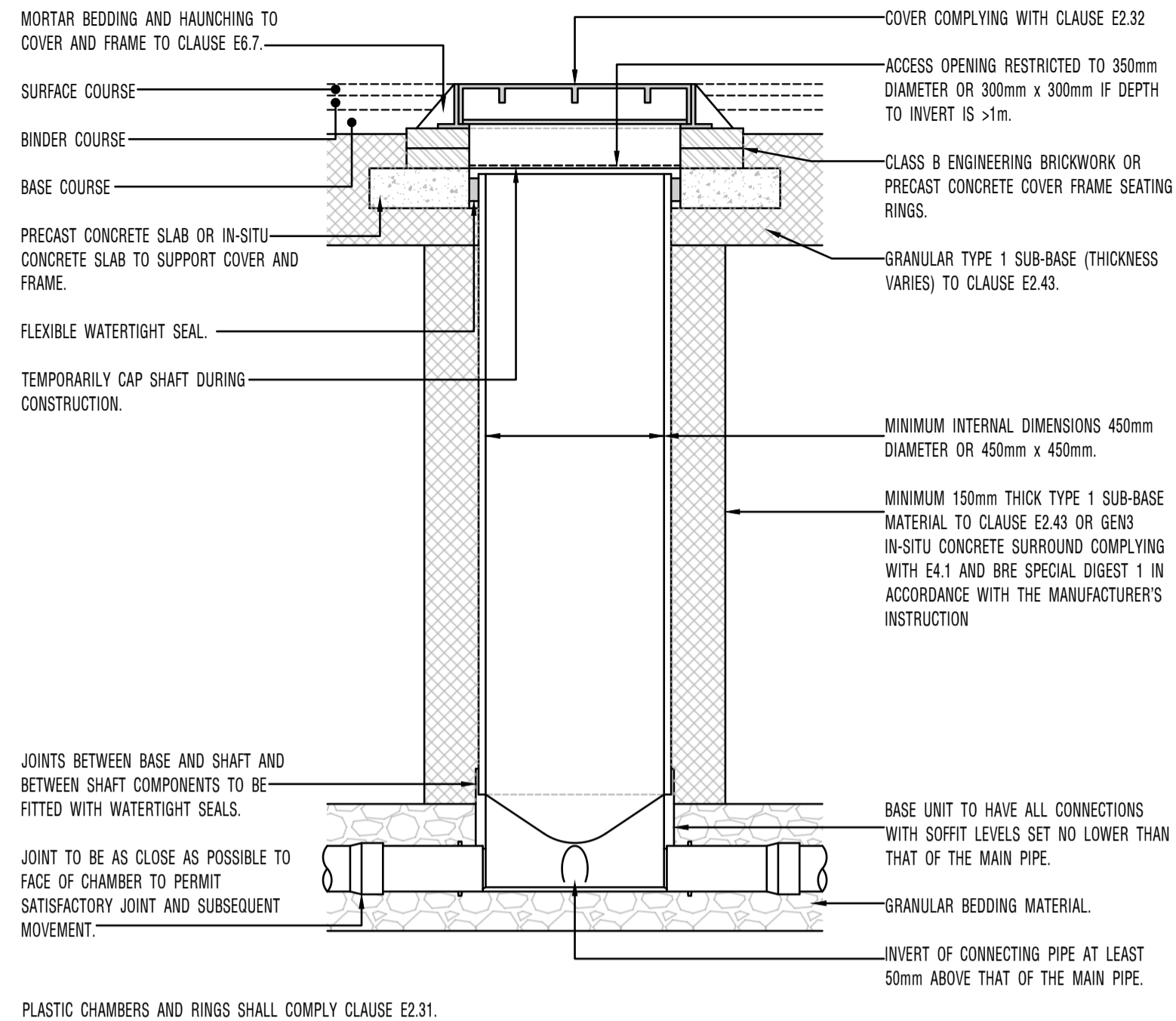

TYPICAL INSPECTION CHAMBER DETAIL - TYPE D (FLEXIBLE MATERIAL DETAIL)

MAXIMUM DEPTH FROM COVER LEVEL TO SOFFIT OF PIPE IN AREAS SUBJECT TO VEHICLE LOADING 3m, NON-ENTRY.

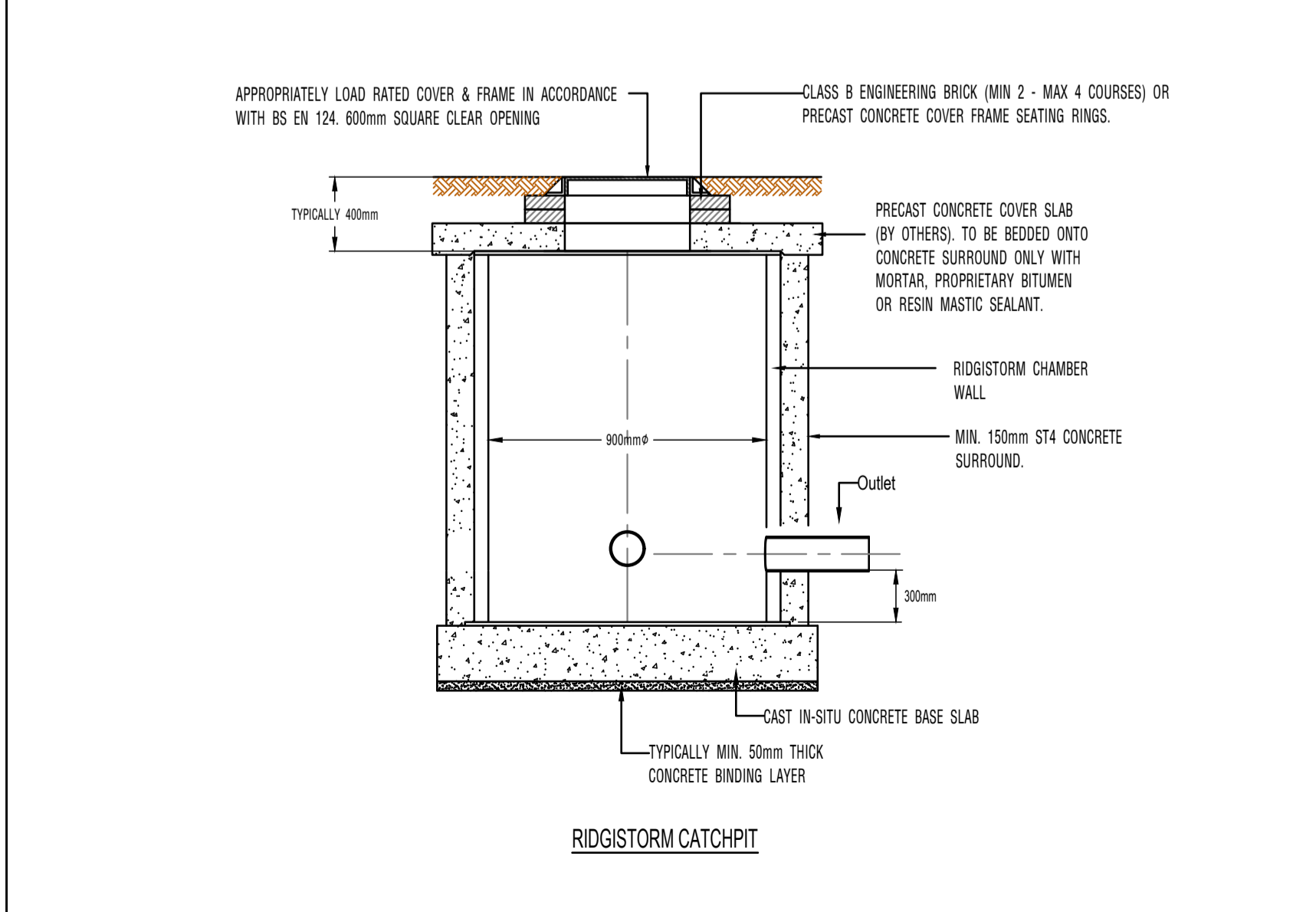
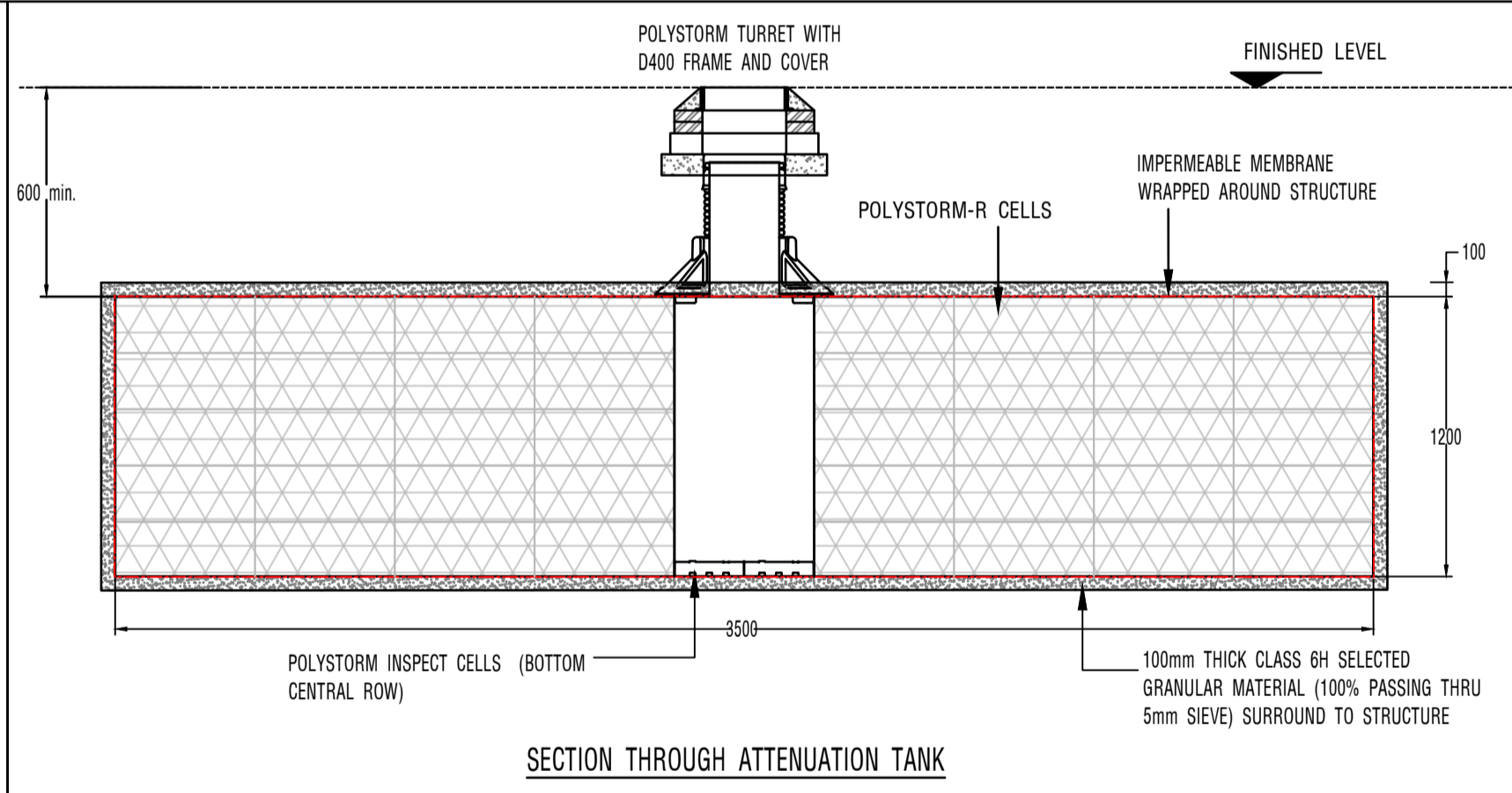
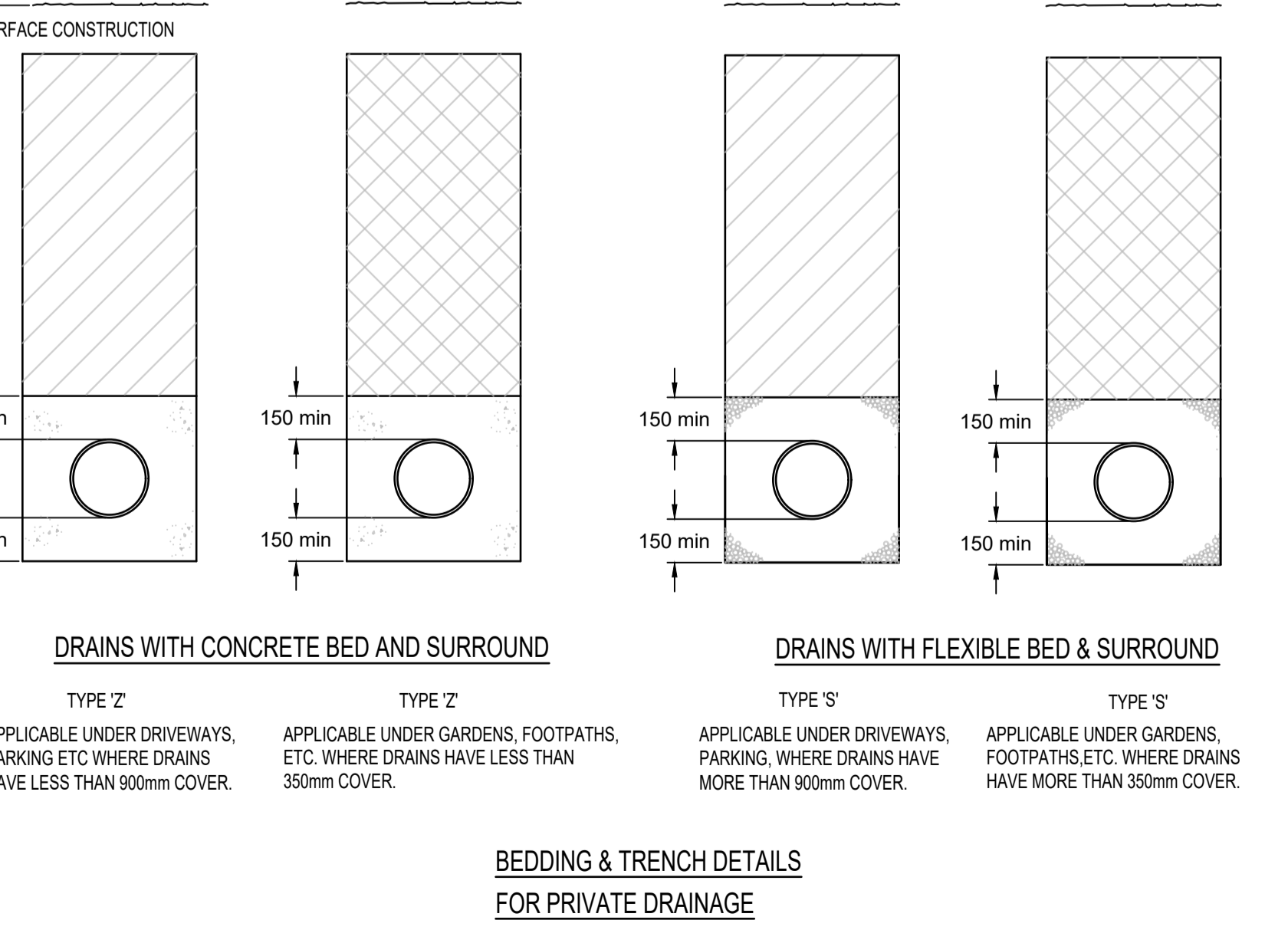
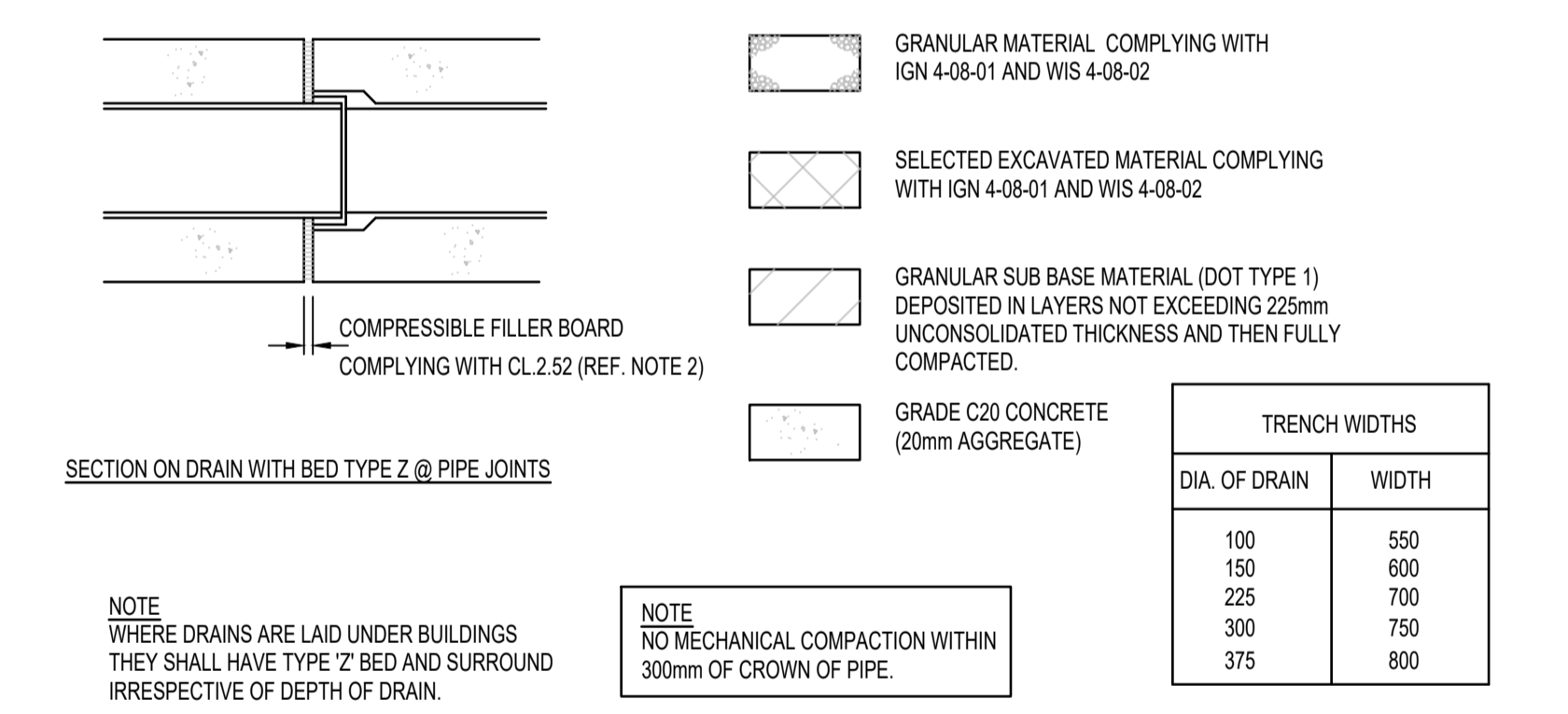
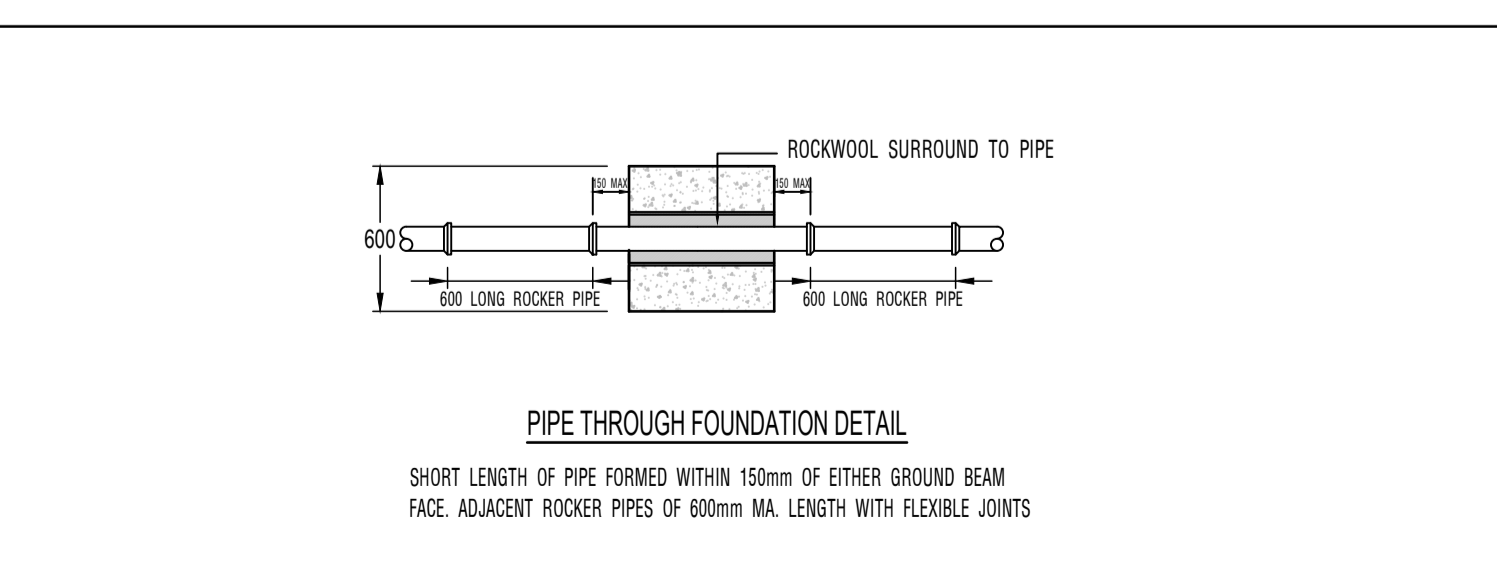
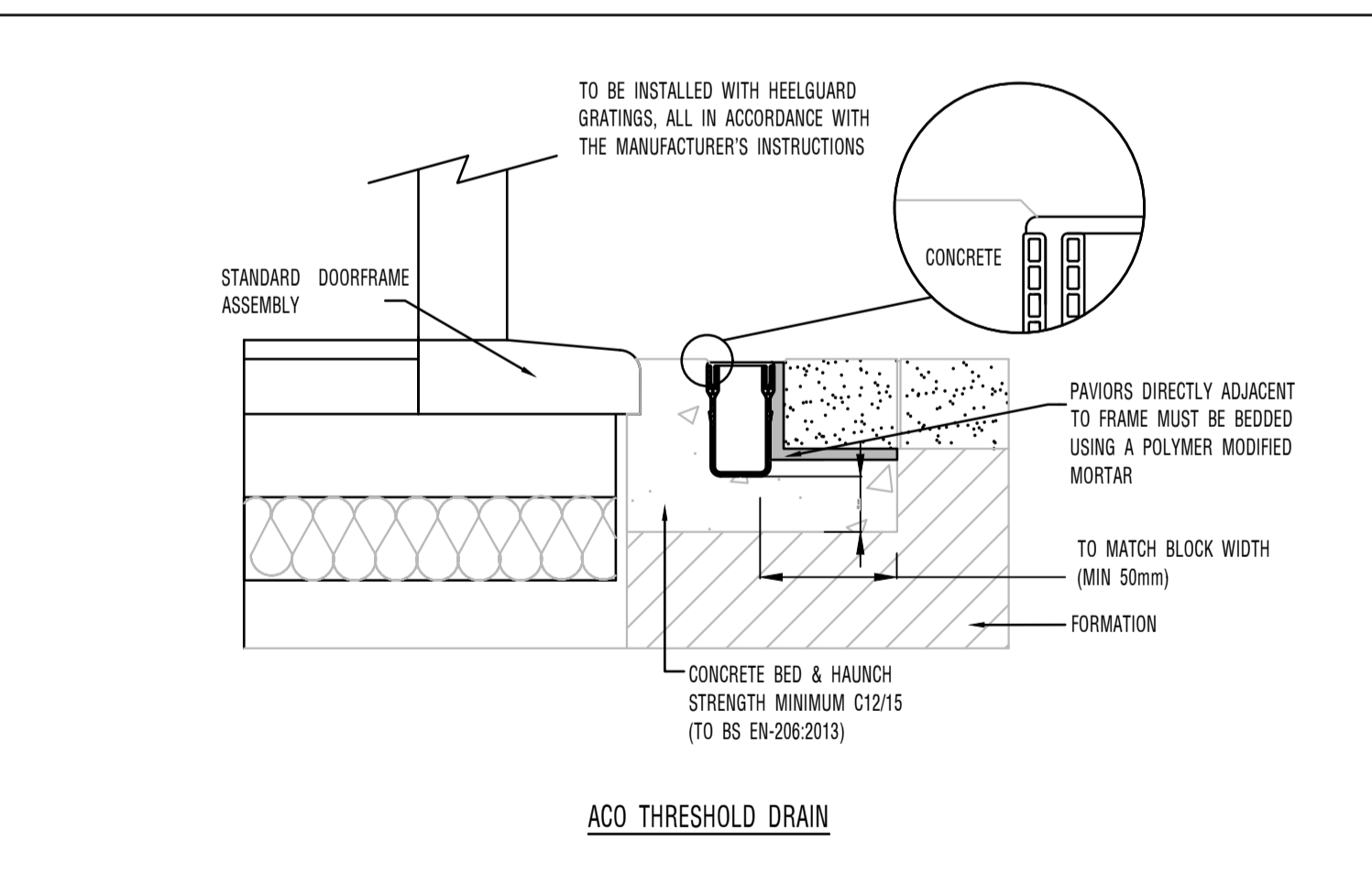
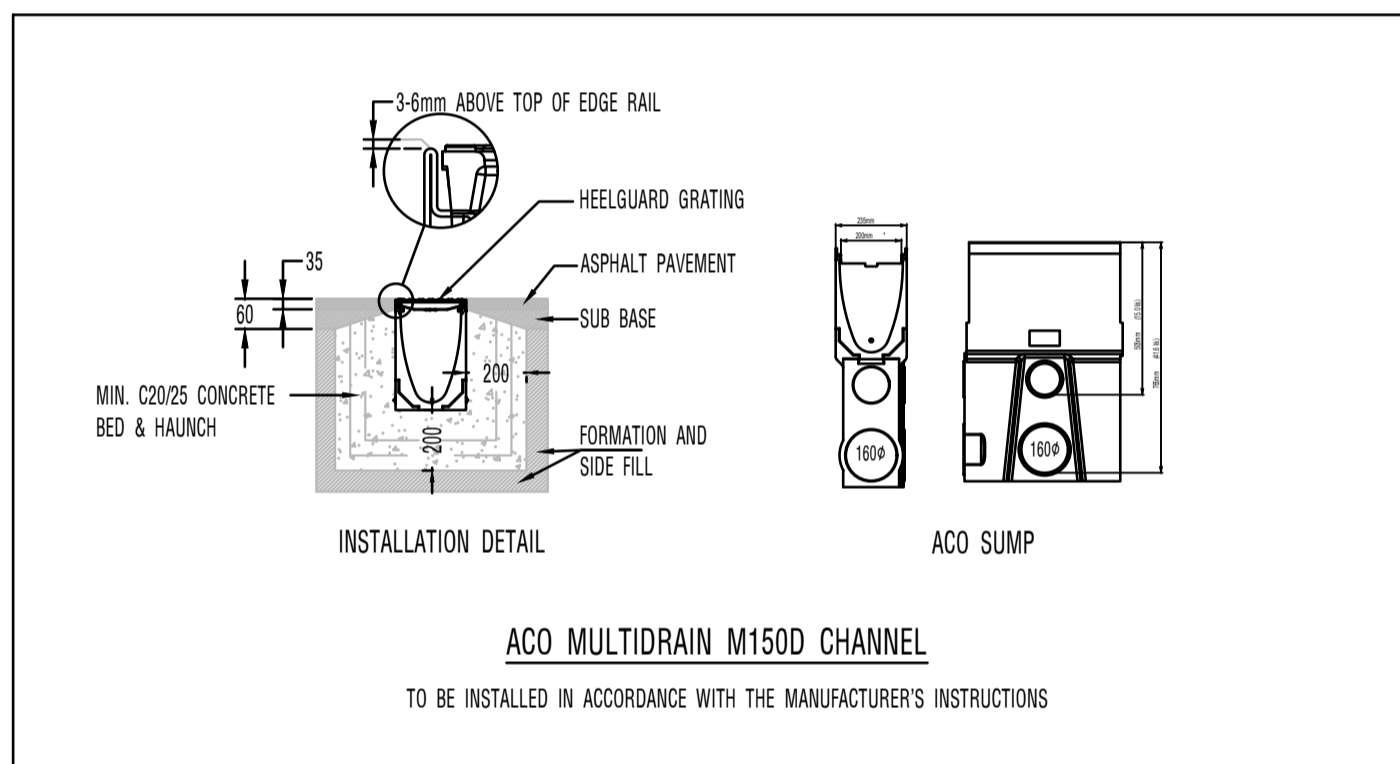
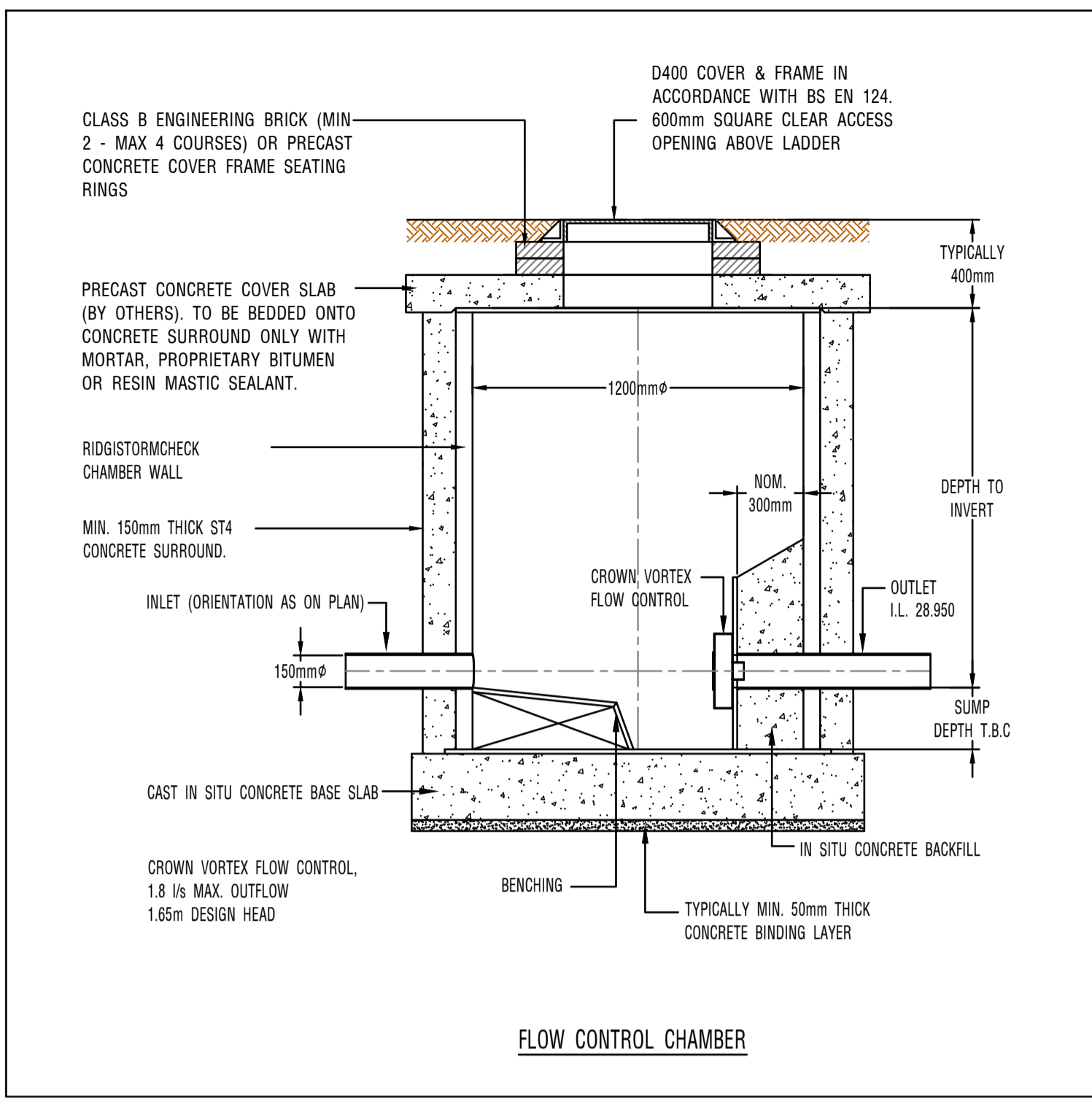

COPYRIGHT © THE CONTENTS OF THIS DRAWING MAY NOT BE REPRODUCED IN WHOLE OR IN PART WITHOUT THE WRITTEN PERMISSION OF WARDCOLE LTD.

rev.	date	description	Drawn	Chk.
A	07.12.2023	Issued for Tender.	DM	DN
	30.11.2023	Preliminary issue.		

WARD COLE
consulting engineers
LINCOLN LONDON NOTTINGHAM

Fosse House
Roman Wharf
Lincoln
LN1 1SR
tel 01522 513032 fax 01522 513559
e-mail structures@wardcole-lincoln.co.uk

client:
YMCA Lincolnshire

project:
**12 Sheridan Close
Lincoln**

drawing title:
Drainage Construction Details

scale: status:
N.T.S. (A1) Tender

job number: drawing number: revision:
10-5898 501 A