

3.0M WIDE VEHICULAR REAR ACCESS TO SHOPS
NO ADVERSE IMPACT ALONG HERE

9.95M



NO CHANGES TO FRONT OF HOUSE

NEIGHBOURS EXTENSION 3.0M HT
NO ADVERSE IMPACT ALONG HERE

PLANNING STATEMENT : THIS APPLICATION IS FOR UPGRADING A EXISTING SINGLE STOREY REAR EXTENSION. PROPOSED NEW ROOF WITH NEW INSULATIONS AND PROPOSED CAVITY WALL CONSTRUCTION WILL REPLACE EXISTING SOLID WALL AT THE SAME SPOT TO ENHANCE THE HEAT RETENTION OF THE PROPERTY. NEW ROOF WILL REPLACE EXISTING ROOF AS OLD ROOF IS LEAKING.

3.0M WIDE VEHICULAR REAR ACCESS TO SHOPS
NO ADVERSE IMPACT ALONG HERE

9.95M

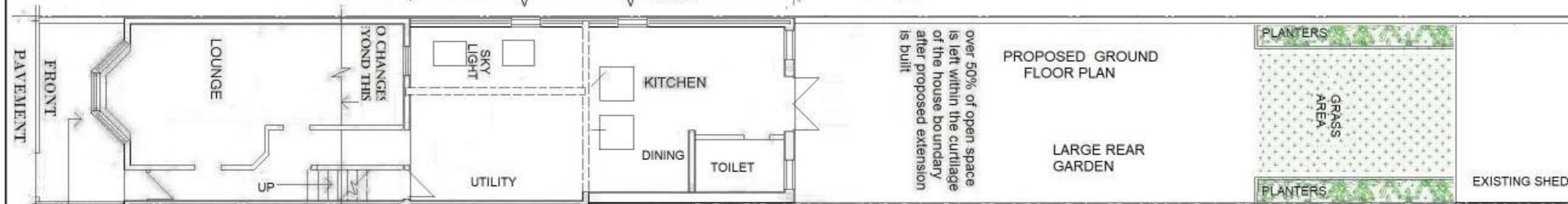

NO CHANGES TO FRONT OF HOUSE

NEIGHBOURS EXTENSION 3.0M HT
NO ADVERSE IMPACT ALONG HERE

over 50% of open space is left within the curtilage of the house boundary after proposed extension is built

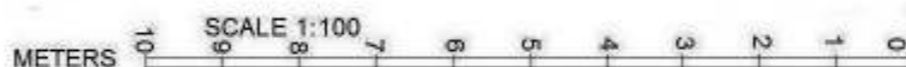
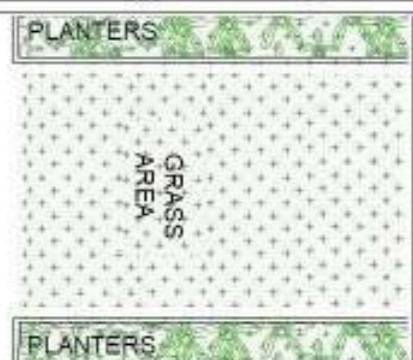

SITE PLAN SCALE 1:1250

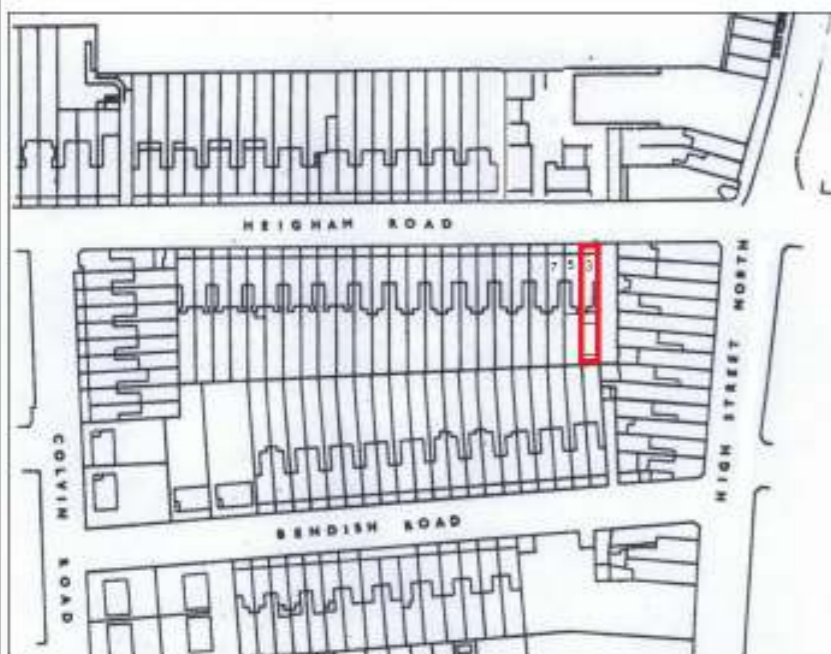

NEW EXTENSION TO HAVE WALLS WITH MATCHING FINISH

NEW WINDOWS AND DOORS TO BE WHITE UPVC FENSA REGISTERED TO MATCH EXISTING

FLAT ROOF TO BE MADE OF 3 LAYERS OF BITUMINOUS FELT TO MATCH EXISTING OR GREY FIBRE GLASS

PROPOSED ALTERATIONS TO EXISTING ROOF AND WALLS OF EXISTING SINGLE STOREY REAR EXTENSION AT
3 HEIGHAM ROAD
EASTHAM LONDON E6 2JL

SCALE 1:100
DRAWING No 455/01

