

- Key:**
- Existing tree to be retained
 - New tree planting
 - Existing tree to be removed
 - Site Boundary
 - Electric Hub

- Building Areas:**
- Cafe / Restaurant Unit 1: 2400sq. ft. 222m2
 - Cafe / Restaurant Unit 2: 2400sq. ft. 222m2
 - Starter Unit A: 1033sq. ft. 96m2
 - Starter Unit B: 1033sq. ft. 96m2
 - Starter Unit C: 1033sq. ft. 96m2
 - Starter Unit D: 1033sq. ft. 96m2

Car Parking Requirement (outer city):
 Cafe / Restaurant Units:
 1 space per 10m2
 Total area = 444m2
 444 / 10 = 45no. spaces

Starter Units:
 1 space per 50m2
 Total area = 400m2
 400 / 50 = 8no. spaces

Total car parking spaces required = 53no.

Total car parking spaces proposed:
 53no. car parking spaces
 including-
 3no. disabled parking spaces (4%)

+ 3no. motorcycle parking spaces

+ EV Charging Hub:
 22no. EV Charging Spaces

Rev	Description	Date
H	Drawing amended.	26.10.23
G	Drawing amended.	10.10.23
F	Drawing amended.	27.09.23
E	Drawing amended.	26.09.23
D	Drawing amended.	22.09.23
C	Drawing amended.	27.08.23
B	Drawing amended.	21.07.23
A	Drawing amended.	21.07.23



Client: CoCity
Project: Stoneywood Gate
 Stoneywood Park, Dyce,
 Aberdeen

Title: Proposed Site Plan

DWG no: 4221 - PL(00)005 H **Date:** 20/07/23

Drawn by: SM **Checked by:** SM **Scale:** As Noted @A1

tinto.co.uk
 Mill House
 Grandholm Crescent
 Bridge of Don
 Aberdeen, AB22 8BB

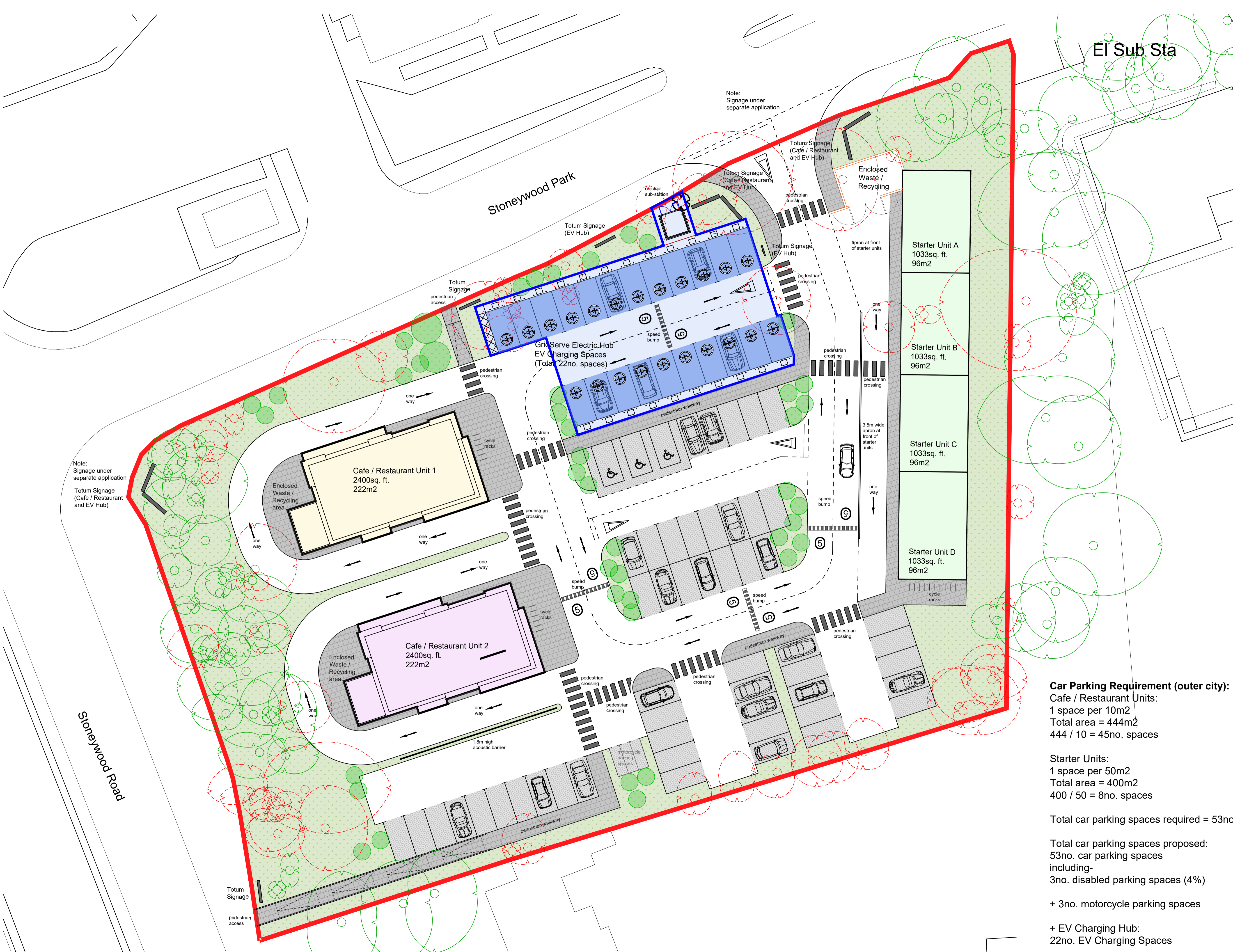

Proposed Site Plan
 Scale 1:200 on A1