

Maintenance Schedule

ESTABLISHMENT MAINTENANCE	J	F	M	A	M	J	J	A	S	O	N	D	No. per year
General actions													
Weeding-all hard and soft landscaped areas including mowing margins to be monitored and kept weed free. Monthly inspections during the growing season. Apply removal herbicide, add an application of organic well rotted manure or spent mushroom compost if required. Hand weeding where appropriate. Brush surfaces as necessary				x	x	x	x	x	x	x			7
Organic composted mulch top ups - all planted areas to be topped up to 75mm depth prior to final handover			x										1
Checking and replacement for any missing, dead, diseased or plants failing to thrive. Replacements to be undertaken within the next planting season to match specified planting size and density.			x							x			2
Litter collection - Ensure any litter caught within trees or shrubs is removed. Monthly litter picking throughout the year to all areas	x	x	x	x	x	x	x	x	x	x	x	x	12
Leaf removal - remove all fallen leaves from hard surfaces and drainage features										x	x	x	3
Arisings - remove all arising from maintenance actions off site and recycle	x	x	x	x	x	x	x	x	x	x	x	x	As required
Watering - all plants as necessary to facilitate healthy establishment. Where possible use recycled grey water.				x	x	x	x	x	x	x			As required
Tree actions													
Weeding - keep base of new tree planting areas minimum 90% weed free at all times with fortnightly checking and hand removal as necessary during the growing season.				x	x	x	x	x	x	x			7
Guying and stakes- check all trees are firm, vertical and secure at each maintenance visit, paying particular attention after high winds. Adjust as required in Spring and Autumn. Remove any ties or supports that are restricting growth.													Once if necessary
Fertiliser application- apply certified organic fertiliser at a rate of 30g per tree in early spring if required and as agreed with the landscape architect.				x									As required
Guying and stakes- check all trees are firm, vertical and secure at each maintenance visit, paying particular attention after high winds. Adjust as required in Spring and Autumn. Remove any ties or supports that are restricting growth.	x	x	x	x	x	x	x	x	x	x	x	x	As required
Shrub actions													
Weeding - keep new planting areas minimum 90% weed free at all times with fortnightly checking and hand removal as necessary during the growing season				x	x	x	x	x	x	x			7
Prune out dead material and divide if necessary in early spring		x	x										As required
Formal hedges													
Formative pruning lightly trimming terminal growth bud to encourage branching immediately after planting and in first two winters												x	1
Hedges to be clipped 2no times per year with straight lines on all sides		x							x				2
Wildflower Grassland													
Cut twice during first growing season to 150mm, leave arisings for up to 3 days where practical then remove from site. Once established, cut once per annum				x							x		2
Remove any aggressive perennial weeds such as Docks, Dandelions, Nettles, Ragwort by hand removal, spot herbicide may only be used occasionally				x	x	x	x	x	x	x			7

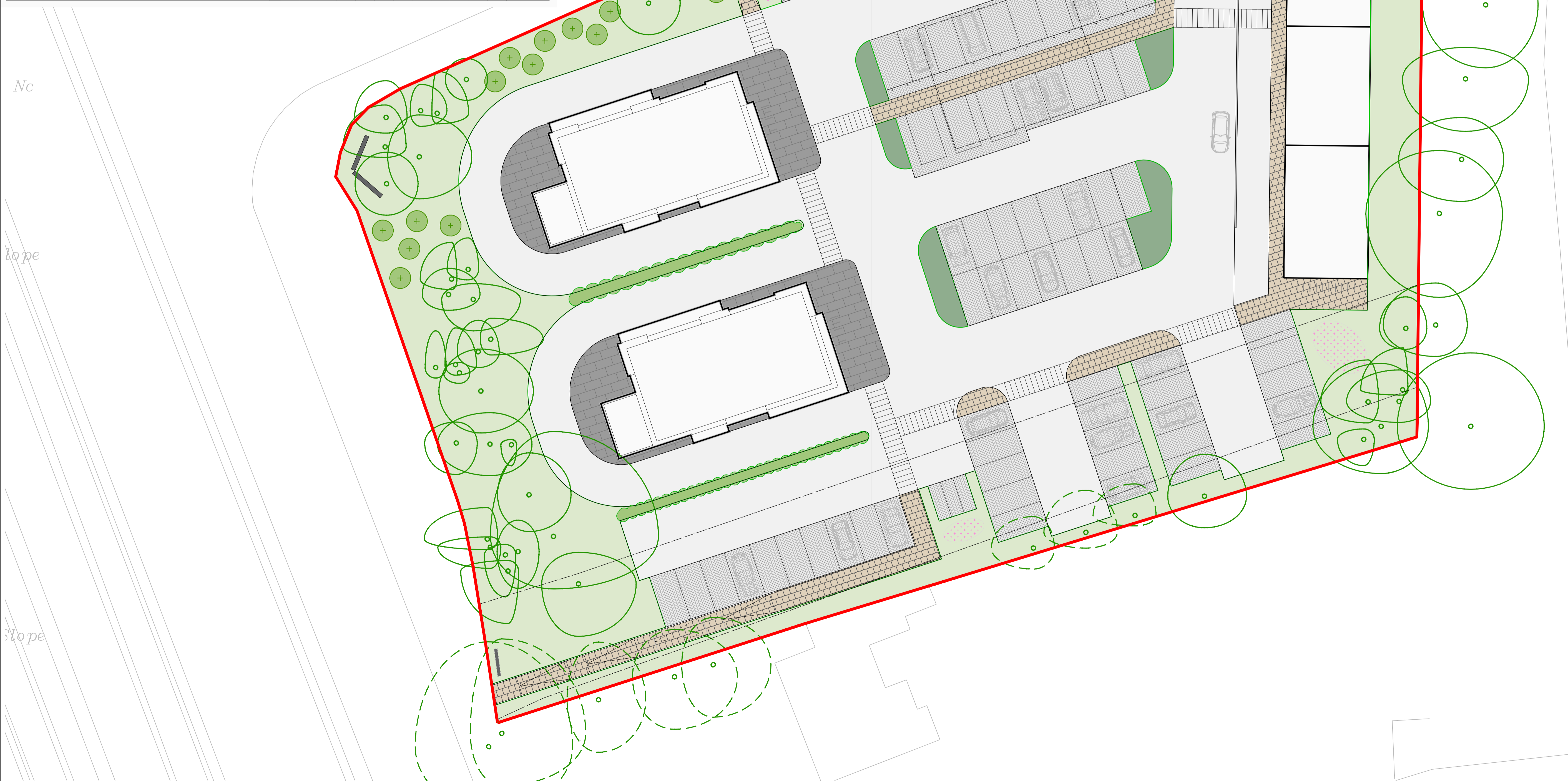

Softworks maintenance

- Existing Trees
- Tree actions
- Formal hedges
- Shrub actions
- Wildflower Grassland actions

Nc

slope

slope

P01 19.10.23 First Issue SH TM
 Rev Date Description Dm Chn App
 Scale 1:200
 Do not scale for construction purposes
 All dimensions are to be verified on site
 © Drawing & design copyright LUC

LUC www.landuse.co.uk
 Project
 Stoneywood Gate for Tinto
 Client
 CoCity
 LUC Job Nr Scale @A1 Status
 12608 1:200 S1
 Drawing Title
 Landscape Maintenance Plan
 Drawing Nr
 12608-LUC-XX-XX-DR-L-0700 P01