





Notes:

- All work to comply with Aberdeen City Councils' - Enterprise Planning & Infrastructure guidelines and specification for roads within residential and industrial developments.
- Prior to roads construction works, the appointed Contractor is to discuss with Aberdeen City Council engineer exact requirement for laboratory CBR PSD & MCV tests. All results must be submitted and details of any coping requirements to the roads officer who is processing the RCC application.
- Road signs and markings to be in accordance with the Traffic Signs Regulations And General Directions (TSRGD) 2016.
- The contractor is responsible for checking the line and level of existing services prior to the commencement of works. Any discrepancies from design information must be reported to the Site Manager and Site Engineer in writing.
- Street occupation should be sought from the local authority prior to works commencing on a public road.
- Street name plate positions to be agreed on site with Aberdeen City Council prior to installation. Positions shown on road layout drawing are indicative.
- Visibility splay envelopes to be under the control of the roads authority. Visibility area to be kept clear of planting and obstructions over 600mm high.
- Non-adopted areas to drain via porous paving or free draining gravel. Where parking areas or driveway's fall towards the adopted carriageway, a channel drain or gully is to be provided to prevent water running onto adopted areas.

Legend:

-  Visibility Splays (To be kept clear of planting or construction over 600mm high).
-  Road Gully (Connections to surface water sewer to be made with 'Y' branches)
-  Pedestrian drop kerb (+60mm upstand max)
-  Tactile Blister Paving Slabs

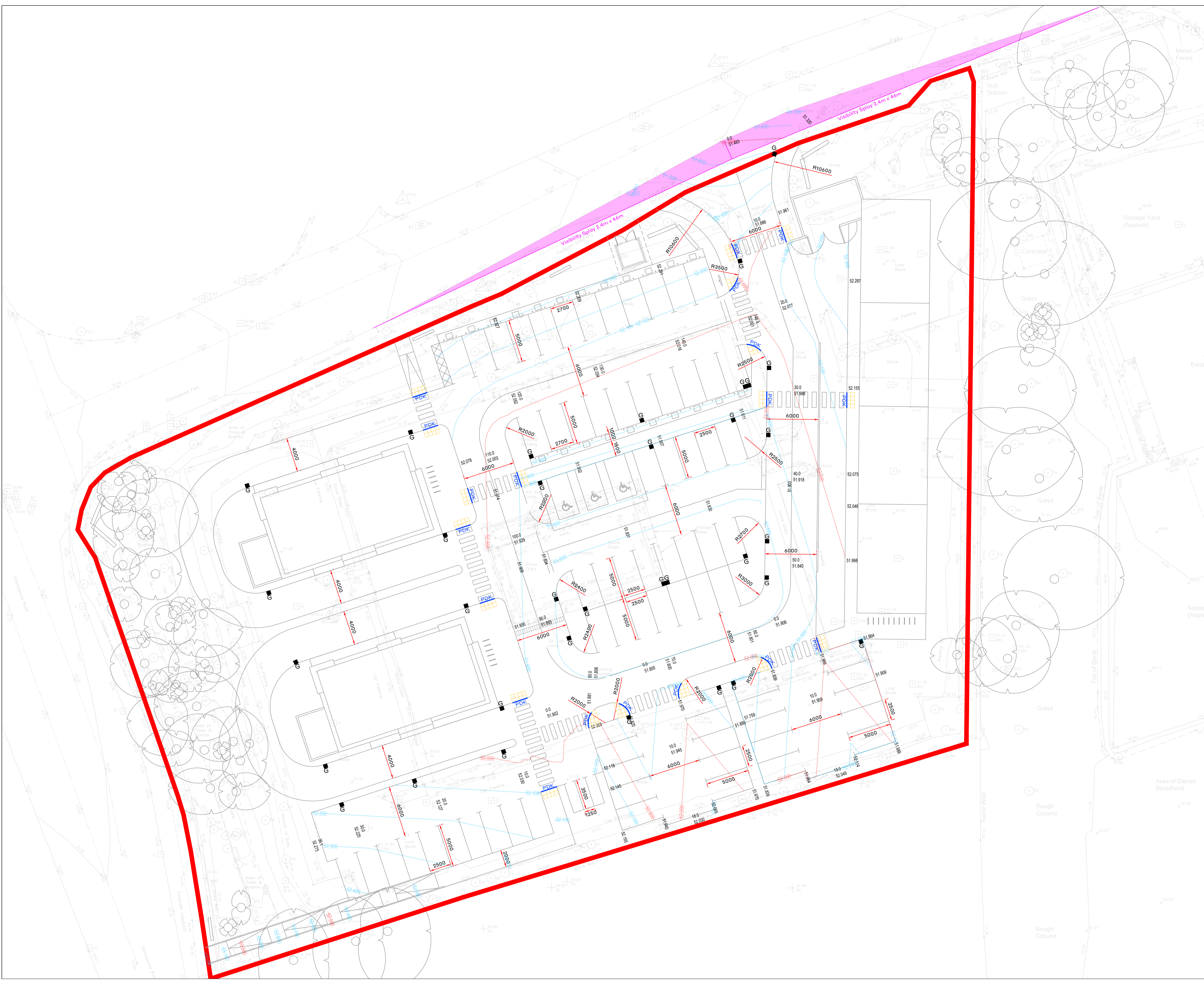

A	Project Title updated	GCO	30/10/23
Rev	Revision Description	Initial	Date

Cameron + Ross
 CIVIL + STRUCTURAL ENGINEERING
 Forbes House | 15 Victoria Street | Aberdeen | AB10 1XB
 CameronRoss.co.uk
 Aberdeen 01224 642 400 | Edinburgh 0131 374 7960 | Inverness 01463 570 100

Client:
 CoCity

Project:
 Stonewood Gate
 Stonewood Park, Dyce
 Aberdeen

Drawing Title:
 Roads Layout Plan

Status:
 Planning

Scale: 1:200 @ A1 Date: 12/10/2023
 By: GCO Checked: RAG Approved: RAG

Dwg. No. 230736-000-CAM-DR-C-200 Rev. A