

CLARENDON ROAD

ST JOHN'S ROAD

17  
to  
19

PW

1.

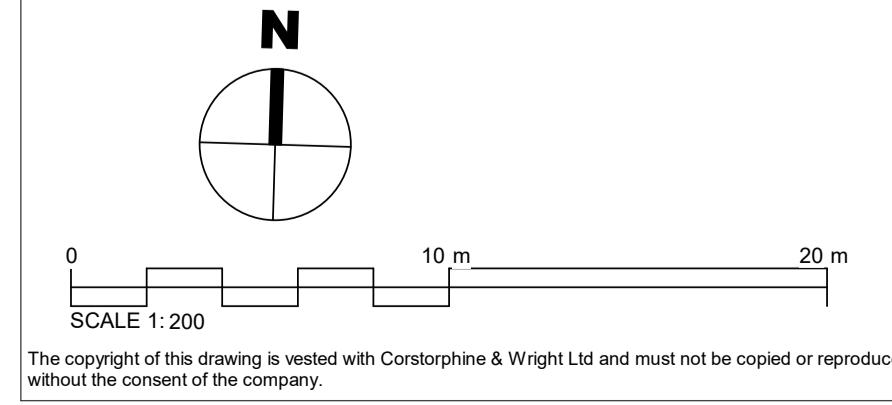
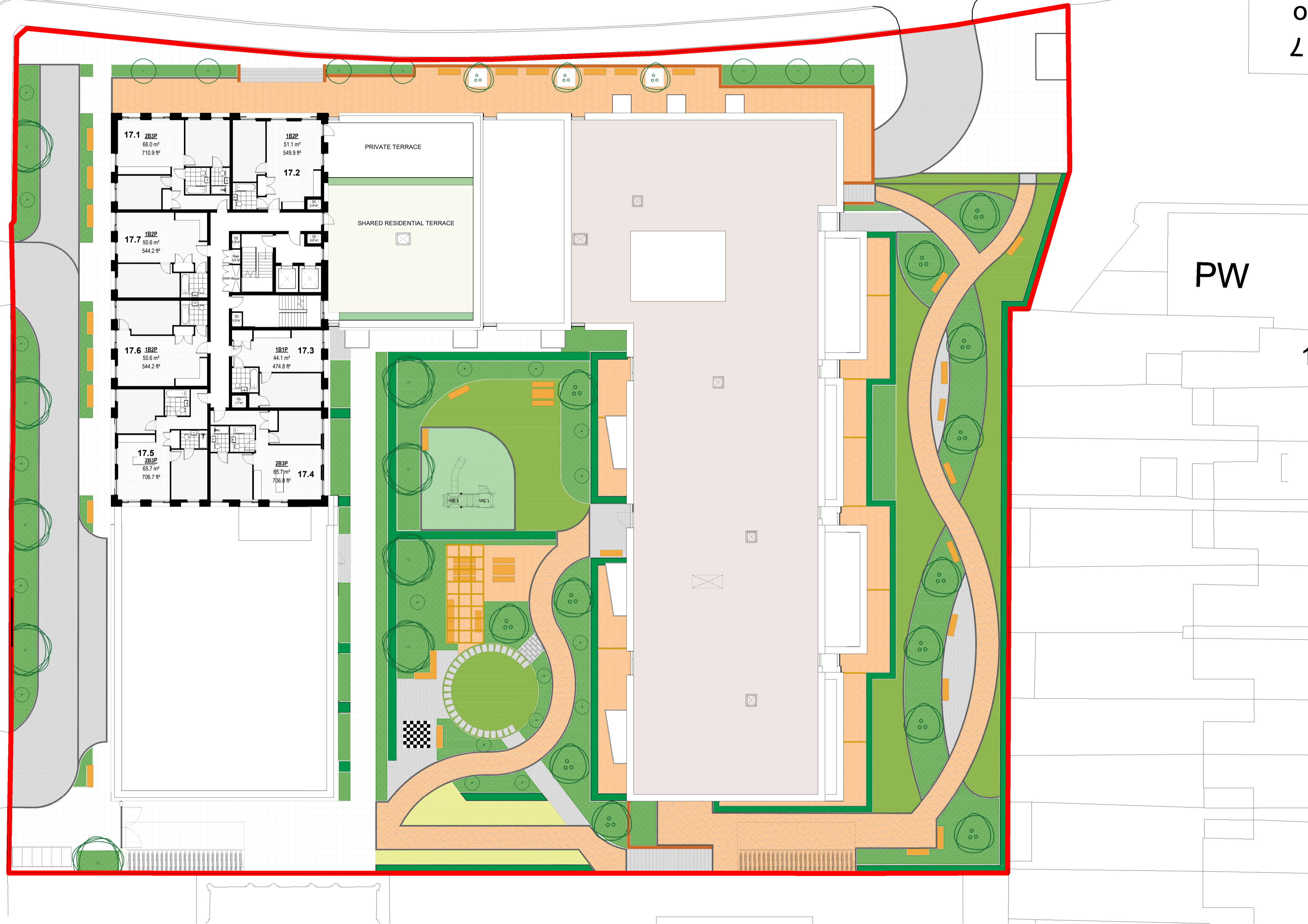

SCALE 1:200  
The copyright of this drawing is vested with Corstorphine & Wright Ltd and must not be copied or reproduced without the consent of the company.

| Rev. | Description   | Date     | Drawn | Chk. |
|------|---|----------|-------|------|
| P11  | Additional smoke shaft added to corridor following Fire Engineer's markup                       | 22.11.23 | LF    | TM   |
| P10  | S73 window amendment to St John's Road elevation  | 26.10.23 | LF    | TH   |
| P09  | S73 pack issue following Fire Engineer's feedback   | 23.10.23 | LF    | TM   |
| P08  | Issue for information for S73 pack of plans containing second stair core and latest landscaping | 29.09.23 | LF    | DC   |
| P07  | Planning Appeal layout update issued to Fire Engineers  | 21.07.23 | LF    | TM   |
| P06  | Issue for information   | 07.11.22 | DD    |      |
| P05  | Height adjusted   | 22.08.22 | Rko   | TM   |
| P04  | Planning Issue  | 31.03.22 | LF    | TM   |
| P03  | Planning Issue  | 23.03.22 | LF    | TM   |
| P02  | Planning Issue  | 08.03.22 | Rko   | TM   |
| P01  | Planning Issue  | 14.12.21 | Rko   | TM   |

Client:  
SKYBRIDGE  
Project:  
TK Maxx, Watford  
Drawing Title:  
PROPOSED LEVEL 17 - 22  
Drawing Status:  
INFORMATION

**Corstorphine & Wright**  
Birmingham Studio  
Alpha Building, Suffolk Street Queensway, Birmingham, B1 1TT  
0121 737 8350  
corstorphine-wright.com  
Drawing No.  
21473-CW-XX-ZZ-DR-A-0328  
Revision  
P11  
Drawn: VD, Checked: TM, Paper Size: A1, Scale: 1:200, Date: DEC 2021