

Existing Floor Plan

1:50

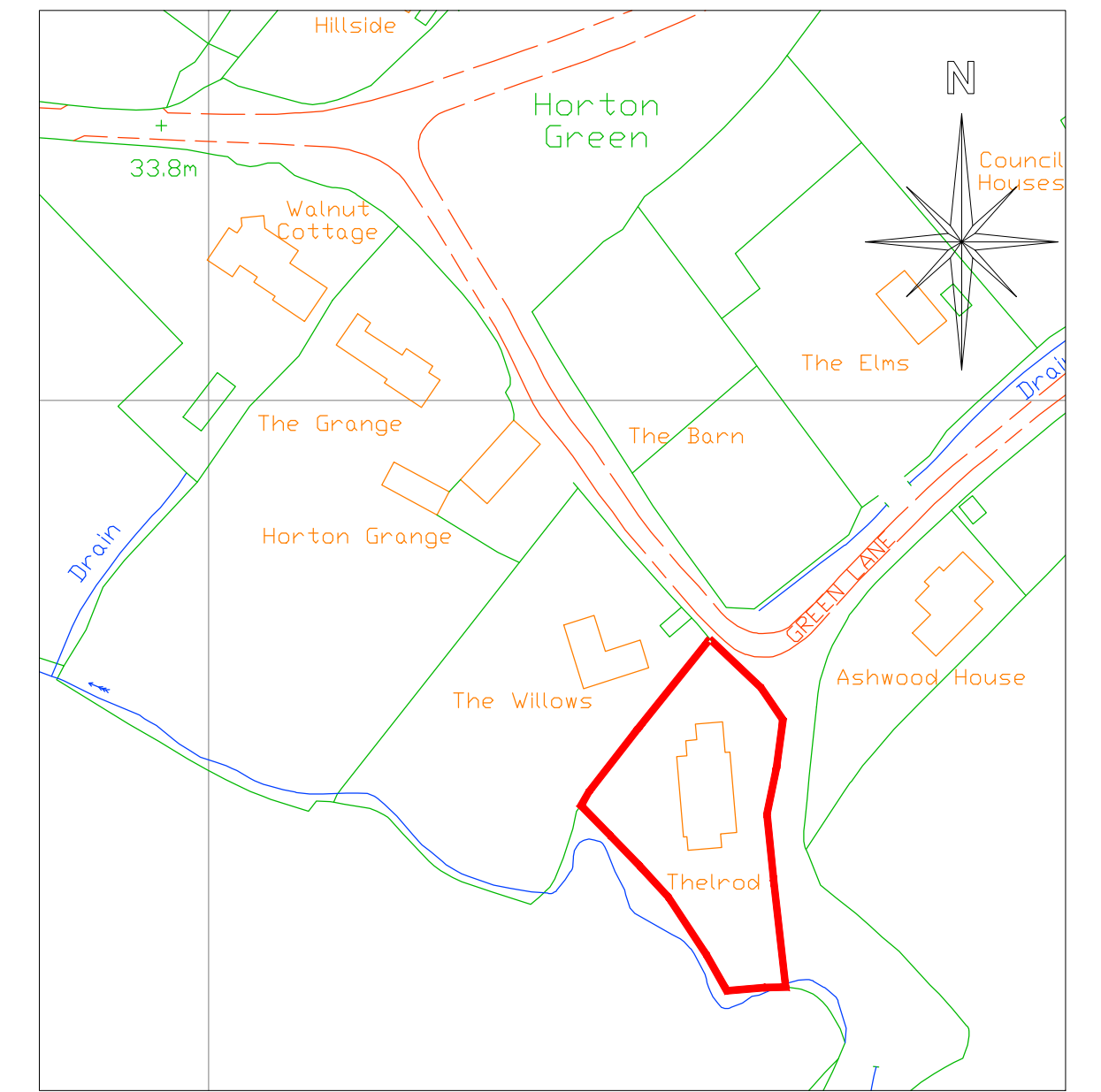

Location Plan
Scale 1:1250

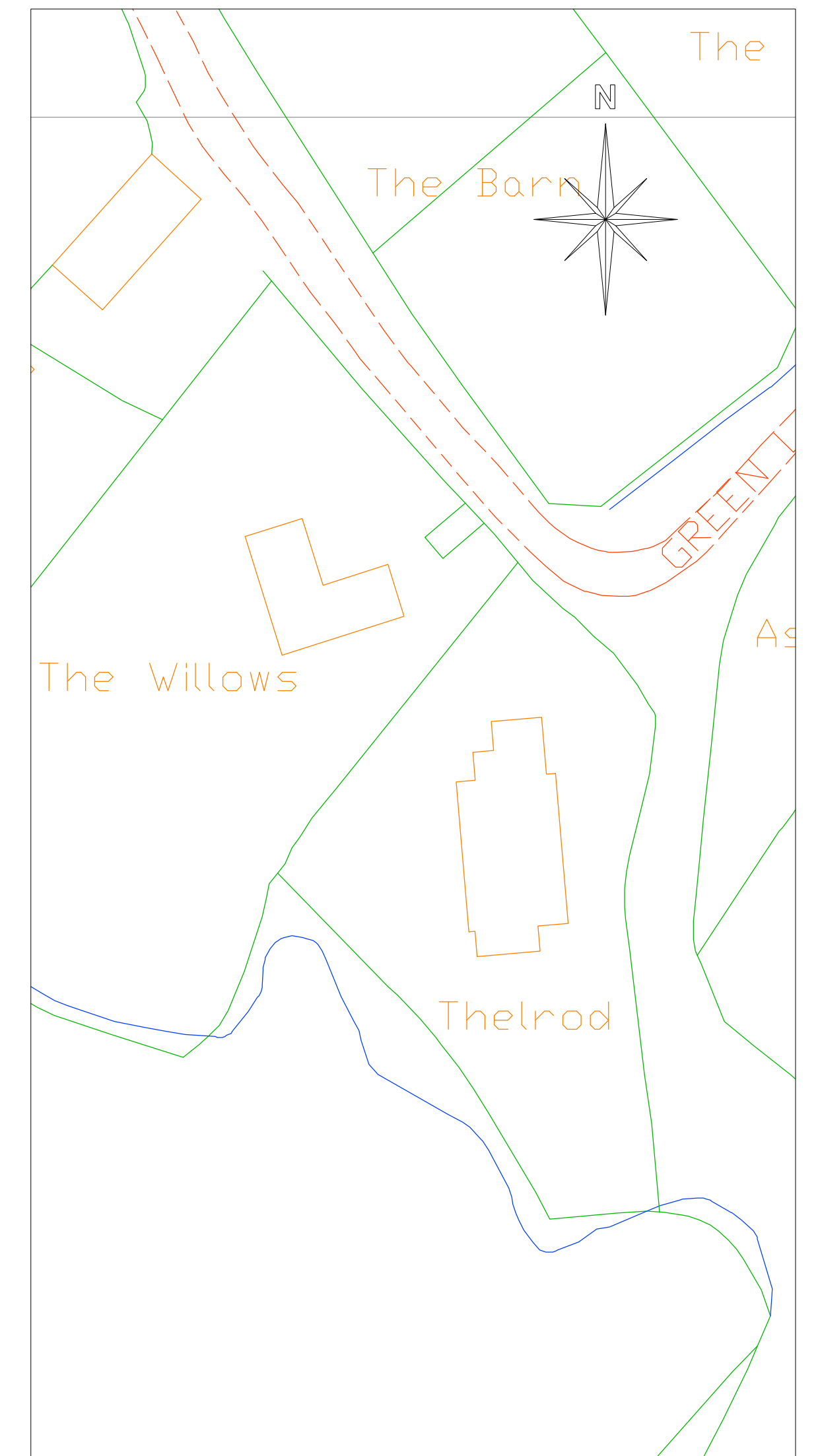

Site Plan
Scale 1:500

 <small>CELLS-ARCHITECTURAL-DESIGN</small> <small>25 Sunningdale Close</small> <small>Wrexham</small> <small>North Wales</small> <small>LL13 9QU</small> <small>T 01978 264376</small> <small>M 07791 480768</small> <small>E ajones540@btinternet.com</small>		<small>Client:</small> Mr. & Mrs. Fenwick.
		<small>Drawing Title:</small> Existing Plans & Location Plan.
<small>Job Title:</small> Proposed Extension to The Elms, Horton.		
<small>Date:</small> Oct 2023	<small>Scale:</small> 1:50, 1:500 & 1:1250 at A1	<small>Rev:</small> <small>Doc No:</small> PD273/01