

Existing Section 1:50

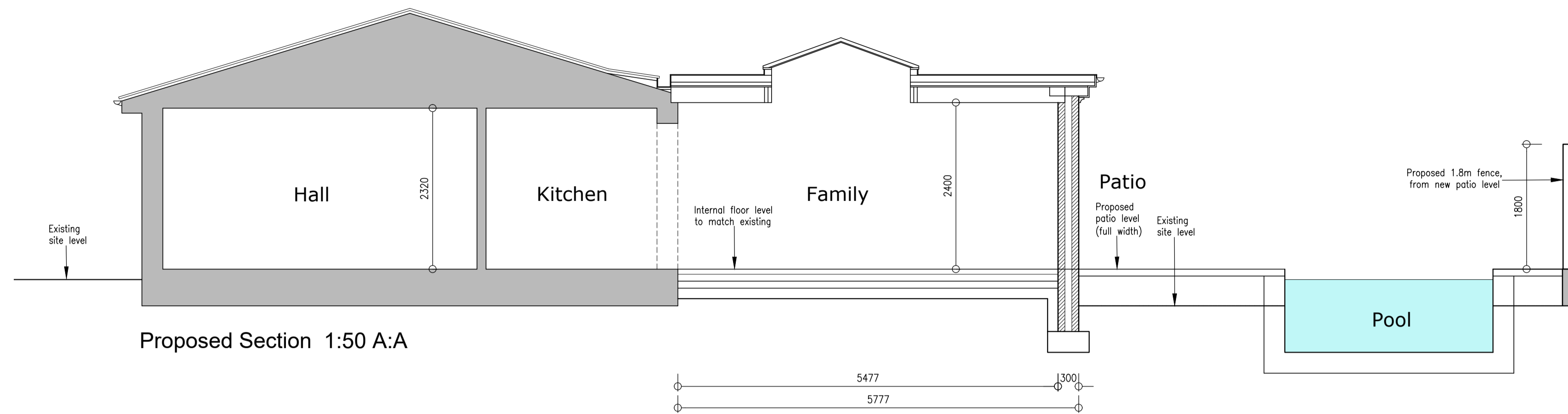

Proposed Section 1:50 A:A

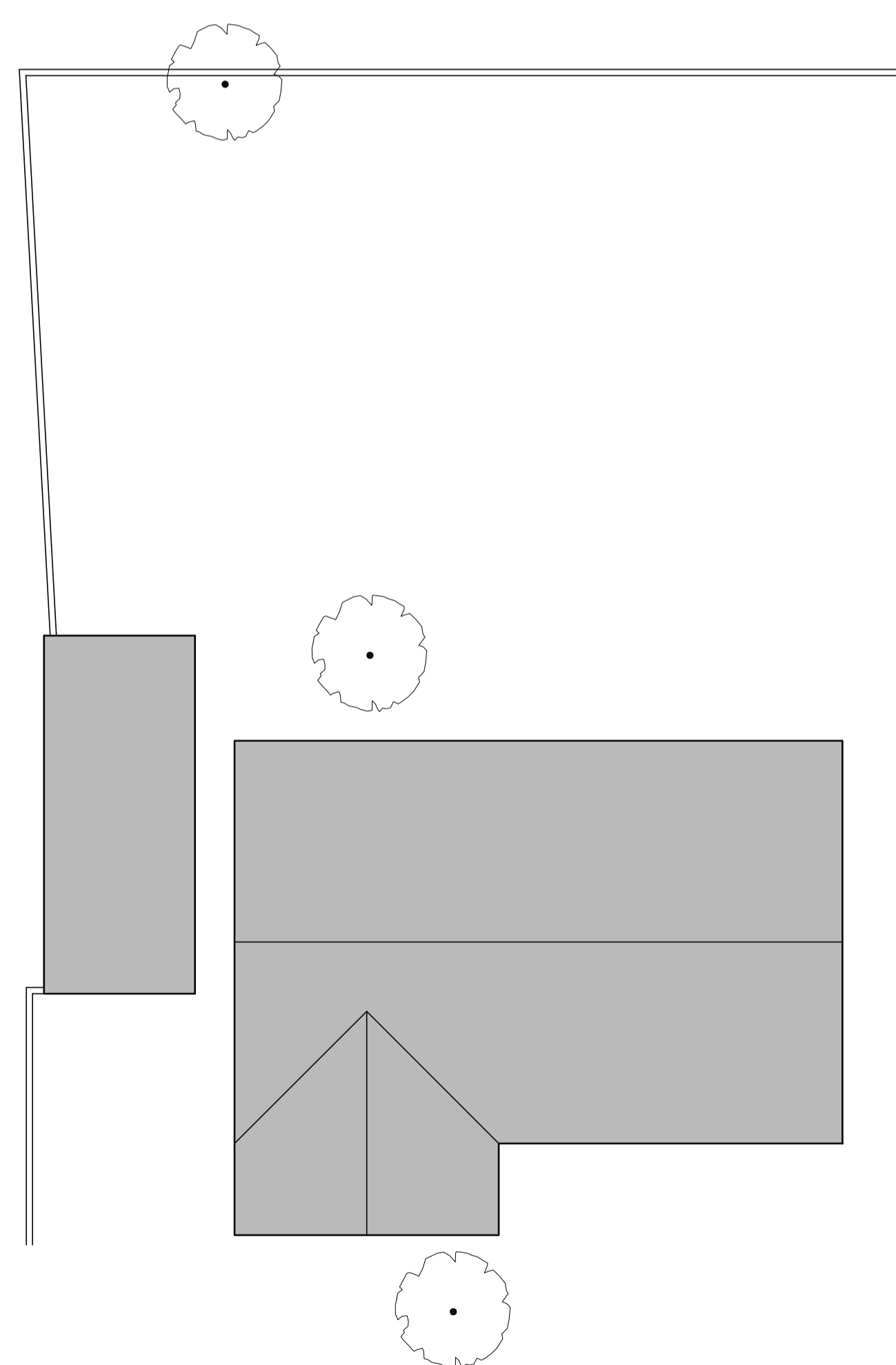
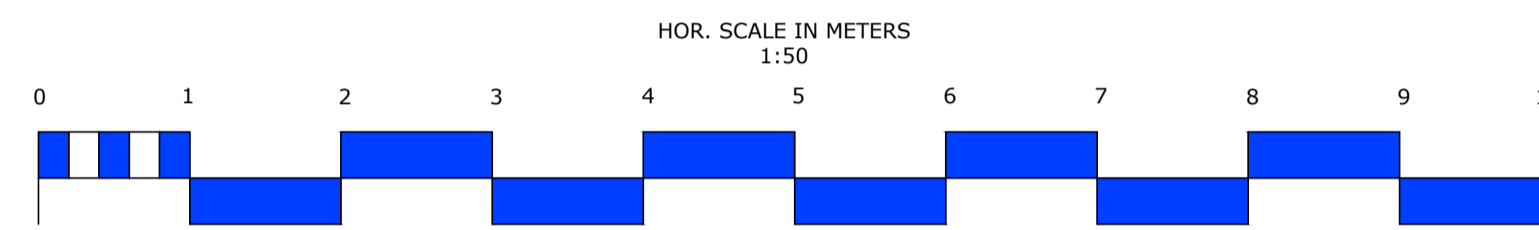

Existing Roof Plan 1:100

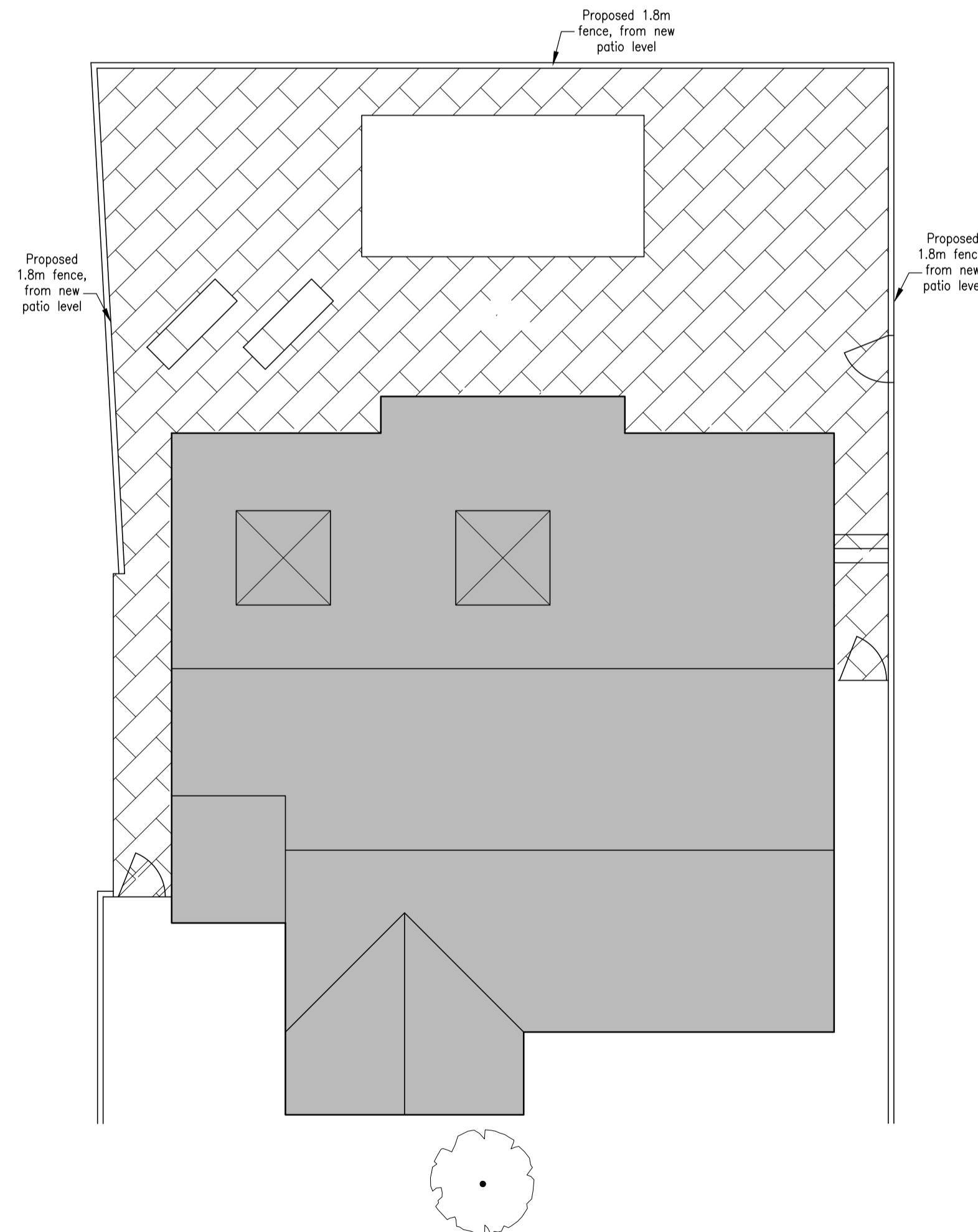

Proposed Roof Plan 1:100

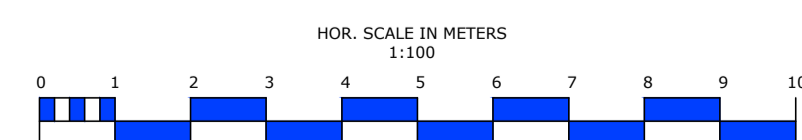

A -
REVISIONS



PETER HUMPHREY ASSOCIATES

ADDRESS: 2 CHAPEL ROAD, WISBECH, CAMBS, PE13 1RG.

TELEPHONE: 01945 466966
E-MAIL: info@peterhumphrey.co.uk
WEB: www.peterhumphrey.co.uk

CLIENT
MR & MRS THORY

PROJECT
PROPOSED EXTENSION TO DWELLING

SITE
SWALLOWS NEST
CRESCENT CLOSE
CORNWALL
BUDE
EX23 0AE

DRAWINGS
EXISTING & PROPOSED SECTIONS
EXISTING & PROPOSED ROOF PLANS

JOB NO.	PAPER SIZE	DATE
6597/03E	A1	JUNE 2022

Notes:
This drawing is the permission of Peter Humphrey Associates Ltd. and may not be reissued, loaned or copied in whole or part without written consent.

All dimensions shown on the drawing are in millimeters unless stated otherwise. If the drawing is received electronically (PDF) it is the recipient's responsibility to ensure it is printed to the correct paper size. All dimensions to be checked on site prior to commencing work and any discrepancies to be highlighted immediately.

The Construction (Design and Management) Regulations 2015. Peter Humphrey Associates' form of appointment with the client confirms whether the agent is appointed as 'Designer' or 'Principal Designer' under these regulations. Nevertheless, the design phase has been carried out with due consideration for the safety during construction, occupation and maintenance of the finished project. No extraordinary hazards or risks were identified outside of the routine construction operations that would not already be apparent to a competent contractor.